

# CLINCH COUNTY CONNECTOR ROAD AND TRACK IMPROVEMENTS

## FOR CLINCH COUNTY SCHOOL SYSTEM

### CLINCH COUNTY, GEORGIA

#### DATE: JANUARY 26, 2026

**SHEET INDEX:**  
**DESCRIPTION**

1. EXISTING CONDITIONS & DEMOLITION PLAN
2. SITE PLAN
3. SITE PLAN ALTERNATIVE A: PAVEMENT REPLACEMENT
4. SITE PLAN ALTERNATIVE B: PAVEMENT OVERLAY
5. GRADING PLAN
6. EROSION CONTROL PLAN
7. EROSION CONTROL DETAILS
8. PRE-DEVELOPED BASIN MAP
9. POST-DEVELOPED BASIN MAP

**SHEET**

- SHEET C100-C101  
SHEET C200  
SHEET C201  
SHEET C202  
SHEET C300  
SHEET C400  
SHEET C401  
SHEET C500  
SHEET C501

**DRAWING LEGEND**

DESCRIPTION	PROPOSED	EXISTING
SANITARY SEWER		
UNDERGROUND WATER LINE		
FORCE MAIN		
STORM DRAINAGE PIPE		
UNDERGROUND TELEPHONE LINE		
UNDERGROUND TELEPHONE CONDUIT		
UNDERGROUND GAS LINE		
DITCH CENTERLINE		
SPOT ELEVATION		
TOP OF CURB ELEVATION		
FIRE HYDRANT		
SEWER MANHOLE		
WATER VALVE		
TELEPHONE MANHOLE		
LIGHT POLE		
SIGN		
WATER METER		
BENCHMARK		
CONCRETE MONUMENT FOUND		
GUY POLE		
IRON PIN FOUND		
IRON PIN SET		
TELEPHONE PEDESTAL		
POWER POLE		
HANDICAP SPACE		
SEDIMENT BASIN MARKER W/NOTCH		

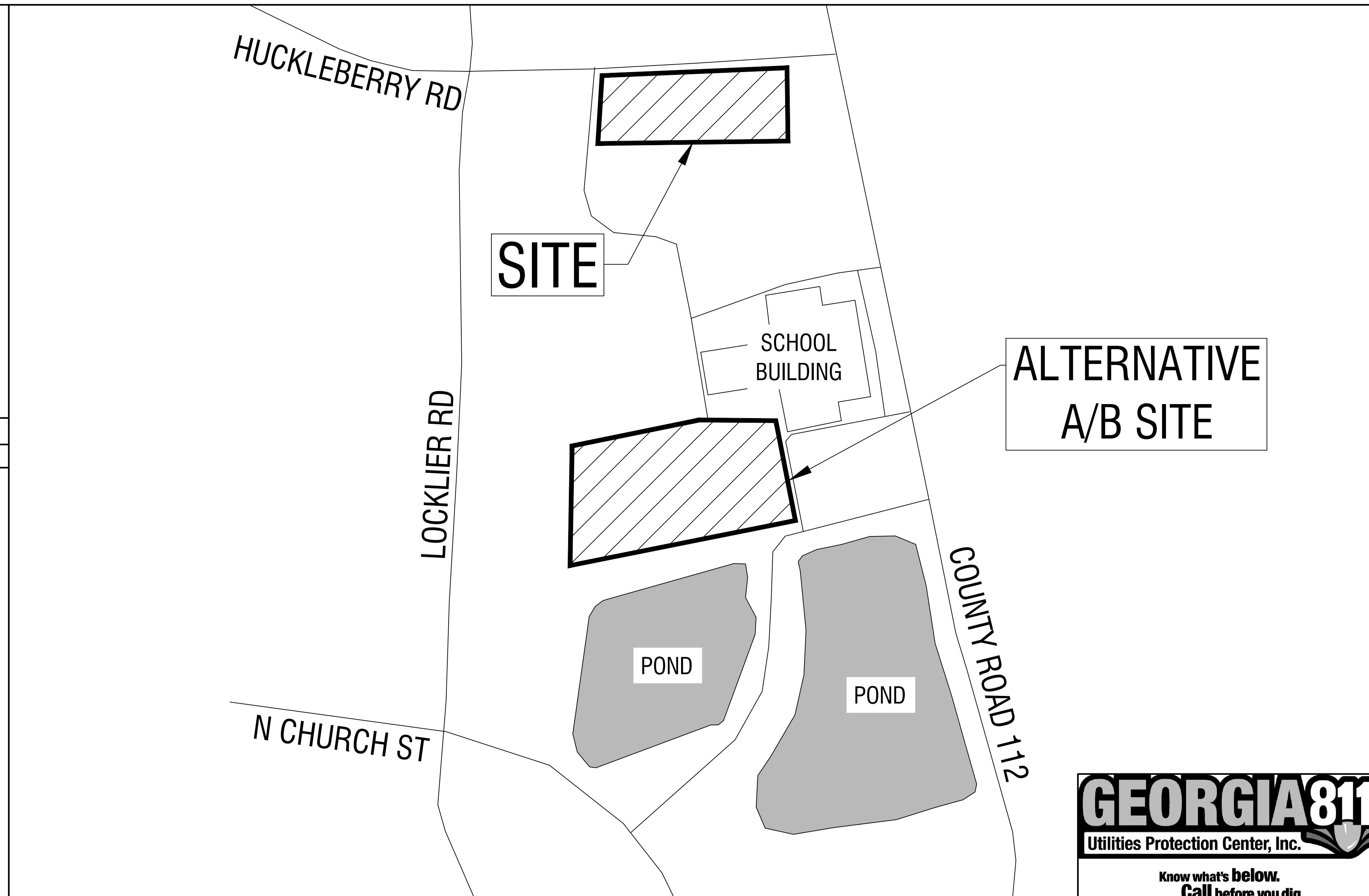

VICINITY MAP  
Not To Scale



**MINIMUM PROJECT SPECIFICATIONS**



ANY JOB DESIGNED BY M.E. SACK ENGINEERING SHALL BE CONSTRUCTED IN ACCORDANCE WITH M.E. SACK ENGINEERING MINIMUM SPECIFICATIONS. IN MUNICIPALITIES WITH THEIR OWN SPECIFICATIONS, THEIR SPECIFICATIONS SHALL SUPERSEDE THE MINIMUM SPECIFICATIONS. LIKEWISE, PROJECTS THAT ARE BID SHALL BE HELD TO THE SPECIFICATIONS WITHIN THE BID DOCUMENT WHICH MAY DIFFER FROM THE MINIMUM SPECIFICATION REQUIREMENTS. IT IS THE RESPONSIBILITY OF THE CONTRACTOR TO ENSURE THEY HAVE THE APPROPRIATE SPECIFICATIONS FOR EACH PROJECT. OBTAIN THE MINIMUM STANDARDS BY SCANNING THE QR CODE OR CLICKING THIS LINK: <https://www.mesack.com/technical-specification/>

CONTACT ADMIN@MESACK.COM TO REQUEST CONFIRMATION OF CORRECT SPECIFICATIONS AT ANYTIME.

OWNER:  
CLINCH COUNTY SCHOOL SYSTEM  
1 PANTHER WAY  
HOMERVILLE GA, 31634

GPS COORDINATES OF CO:  
E: 473310.8947  
N: 382809.1925

DATUM: NAVD88

24 HOUR CONTACT:  
MARCUS SACK  
515 NORTH MAIN STREET  
HINESVILLE GA, 31313  
912-368-5212  
MARCUS@MESACK.COM

DESIGN PROFESSIONAL:



DATE: 3/4/2026

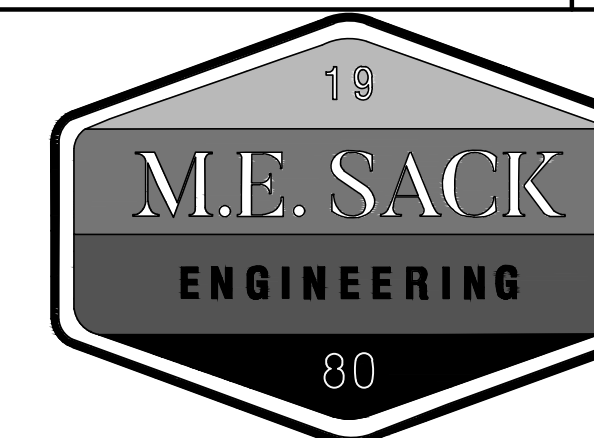

515 NORTH MAIN STREET  
P.O. BOX 649  
HINESVILLE, GA 31313  
TEL: (912) 368-5212

10375 FORD AVENUE  
UNIT A-2  
RICHMOND HILL, GA 31324

**GENERAL NOTES**

1. ALL EXISTING UTILITIES SHOWN ARE LOCATED FROM BEST AVAILABLE INFORMATION. THE CONTRACTOR SHALL BE RESPONSIBLE FOR ACTUAL FIELD LOCATION AND PROTECTION OF EXISTING UTILITIES. OVERHEAD LINES ARE NOT SHOWN FOR CLARITY.
2. ALL DISTURBED AREAS TO BE REVEGETATED IMMEDIATELY AFTER CONSTRUCTION, IN ACCORDANCE WITH THE MANUAL FOR EROSION AND SEDIMENT CONTROL IN GEORGIA.
3. ALL EROSION AND SEDIMENTATION CONTROL STRUCTURES SHALL BE INSTALLED PRIOR TO THE START OF CONSTRUCTION.
4. THE CONTRACTOR SHALL BE RESPONSIBLE FOR THE REPLACEMENT OF ANY PROPERTY CORNERS, RIGHT OF WAY MONUMENTS, SIGNS OR OTHER STRUCTURES DISTURBED DURING CONSTRUCTION.
5. ALL TRAFFIC AND SIGNAGE CONTROL SHALL BE IN ACCORDANCE WITH THE MANUAL FOR UNIFORM TRAFFIC CONTROL DEVICES, MUTCD, CURRENT EDITION.

REVISION NO.	DATE	DESCRIPTION

JOB NO. 2025-82

COVER SHEET

PLOT DATE: March 4, 2026

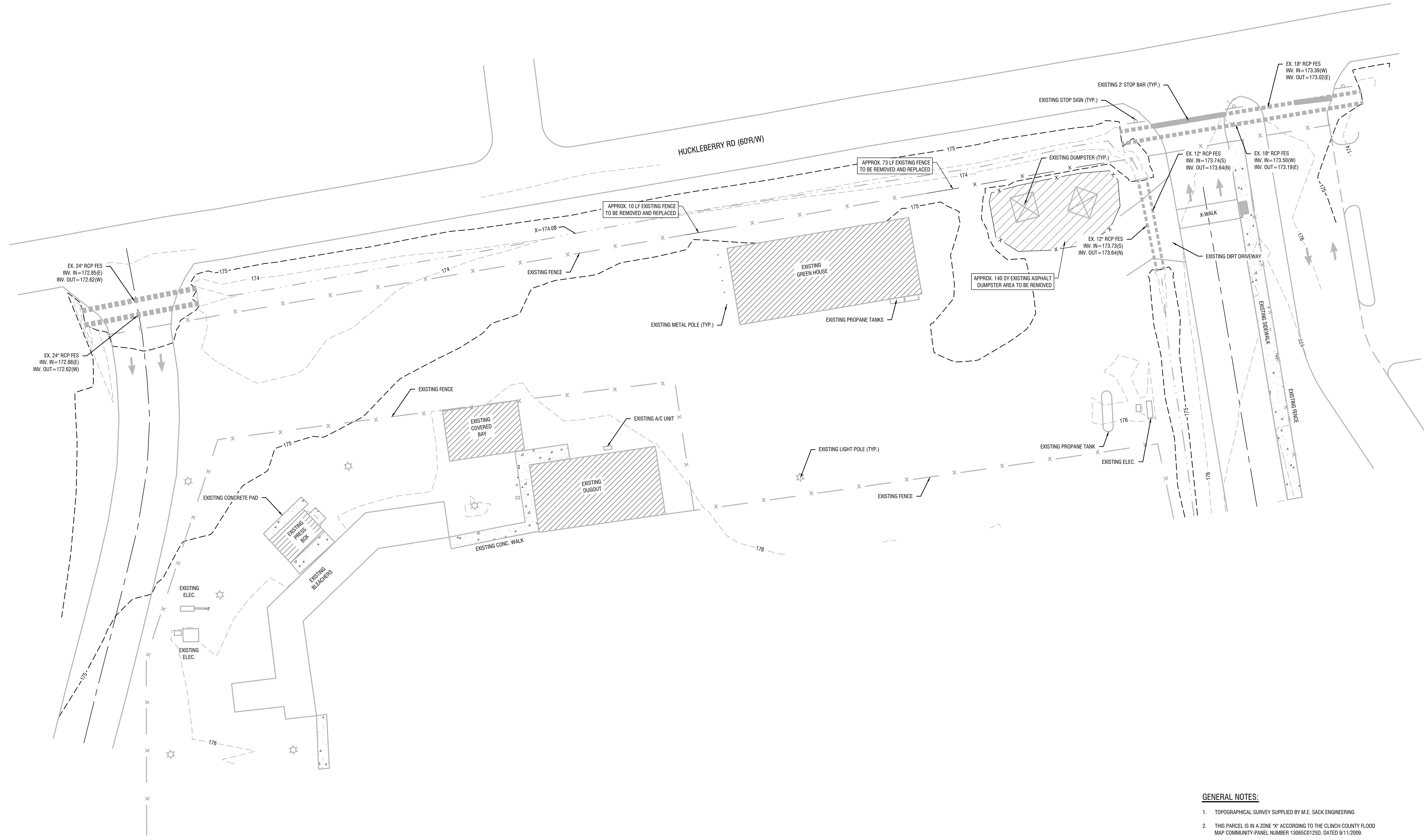
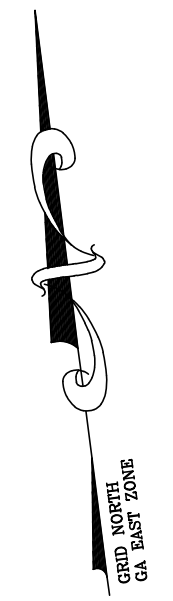
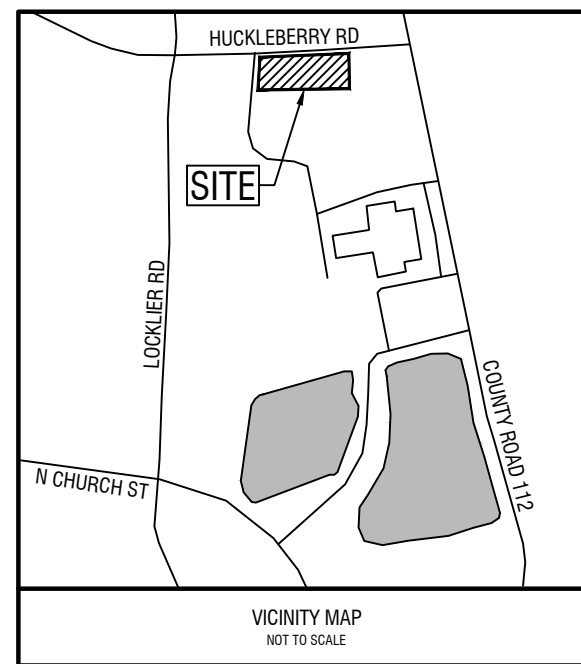

- GENERAL NOTES:**
1. TOPOGRAPHICAL SURVEY SUPPLIED BY M.E. SACK ENGINEERING
  2. THIS PARCEL IS IN A ZONE "X" ACCORDING TO THE CLINCH COUNTY FLOOD MAP COMMUNITY-PANEL NUMBER 1306SC0125D, DATED 9/11/2009.
  3. ALL STREETS ARE PRIVATE IN NATURE.

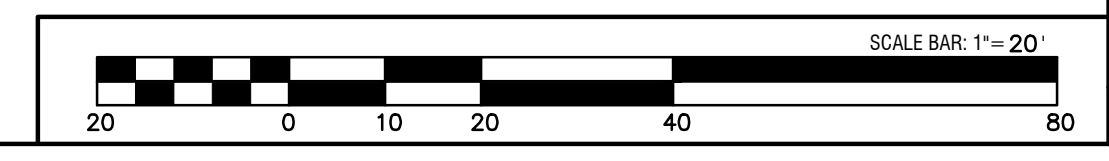

<p>REVISIONS:</p> <table border="1"> <tr><td> </td><td> </td></tr> <tr><td> </td><td> </td></tr> <tr><td> </td><td> </td></tr> <tr><td> </td><td> </td></tr> <tr><td> </td><td> </td></tr> <tr><td> </td><td> </td></tr> <tr><td> </td><td> </td></tr> <tr><td> </td><td> </td></tr> <tr><td> </td><td> </td></tr> <tr><td> </td><td> </td></tr> </table>																					<p>THIS DRAWING IS AN INSTRUMENT OF SERVICE AND REMAINS THE PROPERTY OF P.C. SIMANTON &amp; ASSOCIATES, INC. AND M.E. SACK ENGINEERING. IT MAY NOT BE COPIED, ALTERED, OR REPRODUCED IN ANY MANNER WITHOUT PERMISSION ON A SIGNED AND SEALED DOCUMENT. THE INFORMATION CONTAINED HEREIN IS INTENDED FOR THE NAMED CLIENT ONLY. IN THE EVENT OF AN ELECTRONIC VERSION OF THIS DRAWING, THE ORIGINAL DRAWING SHALL BE THE AUTHORITY. P.C. SIMANTON &amp; ASSOCIATES, INC. AND M.E. SACK ENGINEERING ASSUMES NO RESPONSIBILITY FOR DATA GENERATED, ALTERED OR STAKED FROM THIS DRAWING. IN THE EVENT OF A DISPUTE, HARD COPIES WILL TAKE PRECEDENCE OVER ANY ELECTRONIC MEDIA.</p>
<p><b>DESIGN PROFESSIONAL:</b>  <b>MARCUS E. SACK</b>          GSWCC LEVEL II # 70248          EXPIRES: 06/14/2026          MARCUS@MESACK.COM</p> <p>515 NORTH MAIN STREET          P.O. BOX 649          HINESVILLE, GA 31313          TEL: (912) 368-5212</p>																					
	<p><b>MUNICIPALITY:</b> CITY OF HOMERVILLE</p> <p><b>COUNTY:</b> CLINCH COUNTY</p> <p><b>OWNER:</b> CLINCH COUNTY SCHOOL SYSTEM 1 PANTHER WAY HOMERVILLE GA, 31634</p> <p><b>24 HOUR CONTACT:</b> MARCUS SACK 515 NORTH MAIN STREET HINESVILLE GA, 31313 912-368-5212 MARCUS@MESACK.COM</p>																				
<p><b>CLINCH COUNTY CONNECTOR ROAD AND TRACK IMPROVEMENTS</b></p>	<p><b>EXISTING CONDITIONS &amp; DEMOLITION PLAN</b></p>																				
<p><b>C100</b></p>	<p>FILE NO: 2025-82          PLOT DATE: March 4, 2026</p>																				

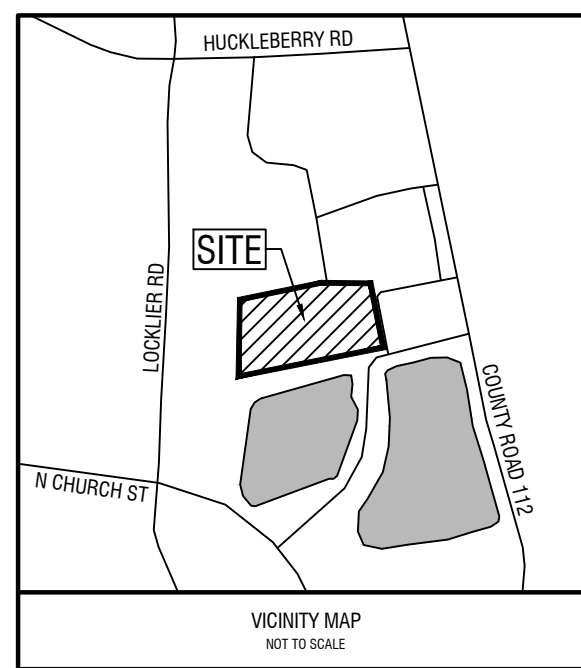

**GENERAL NOTES:**

- EXISTING FEATURES SHOWN ARE BASED ON BEST AVAILABLE INFORMATION PROVIDED BY THE OWNER.
- THIS PARCEL IS IN A ZONE "C" AND ZONE "A" ACCORDING TO THE CLINCH COUNTY FLOOD MAP COMMUNITY-PANEL NUMBER 13065C01250, DATED 9/11/2009.

REVISIONS:

NO.	DATE	DESCRIPTION

**DESIGN PROFESSIONAL:**

MARCUS E. SACK  
GSWCC LEVEL II # 70248  
EXPIRES: 06/14/2026  
MARCUS@MESACK.COM

515 NORTH MAIN STREET  
P.O. BOX 649  
HINESVILLE, GA 31313  
TEL: (912) 368-5212



DATE: 2/4/2026



MUNICIPALITY:  
CITY OF HOMERVILLE

COUNTY:  
CLINCH COUNTY

OWNER:  
CLINCH COUNTY SCHOOL SYSTEM  
1 PANTHER WAY  
HOMERVILLE GA, 31634

24 HOUR CONTACT:  
MARCUS SACK  
515 NORTH MAIN STREET  
HINESVILLE GA, 31313  
912-368-5212  
MARCUS@MESACK.COM

**CLINCH COUNTY  
CONNECTOR ROAD  
AND TRACK  
RESURFACING**

**EXISTING  
CONDITIONS &  
DEMOLITION PLAN**

**C101**

FILE NO: 2025-82

PLOT DATE: March 4, 2026

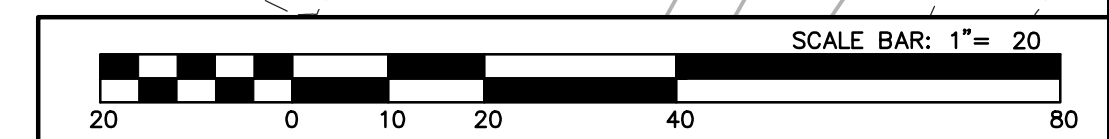
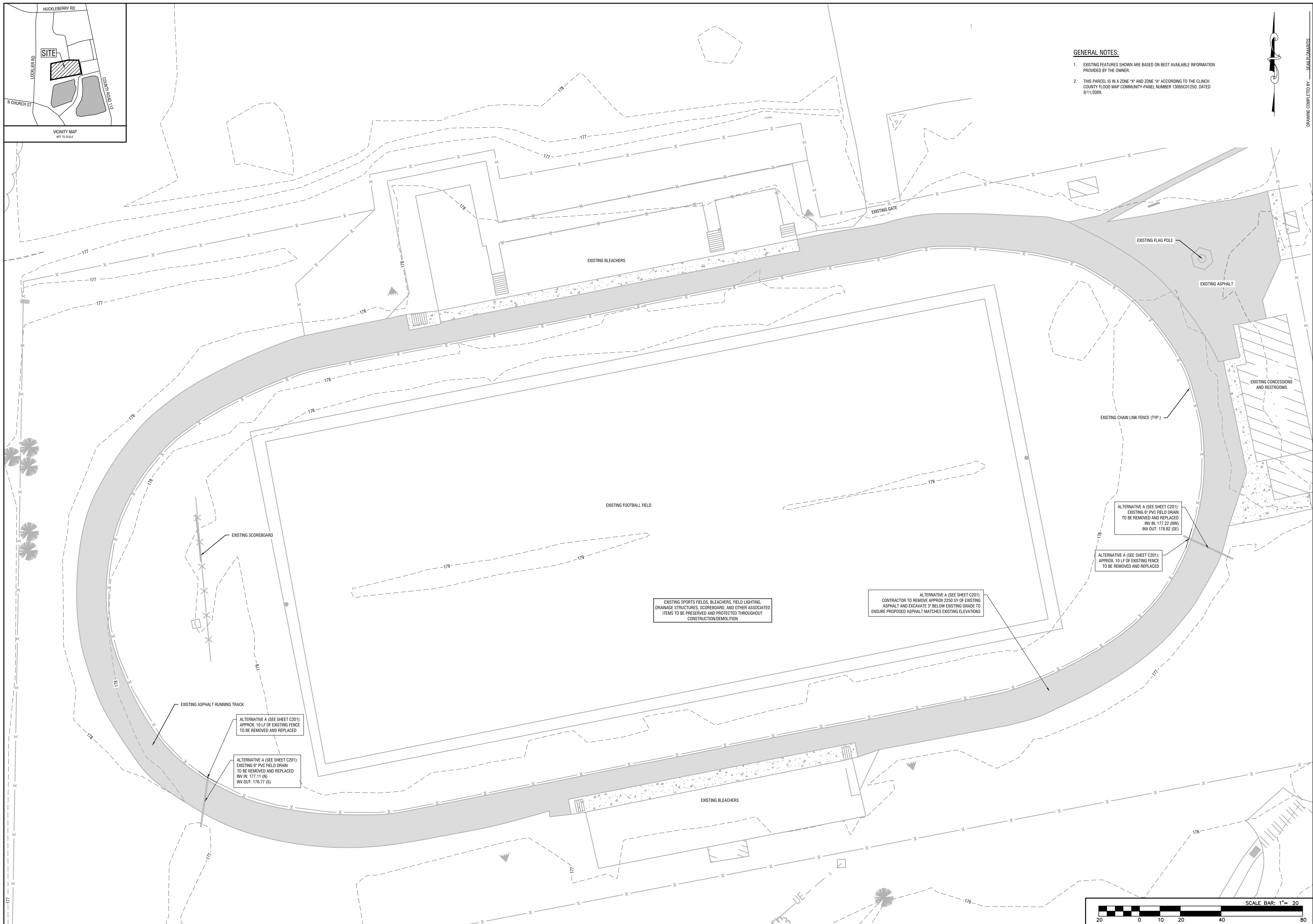

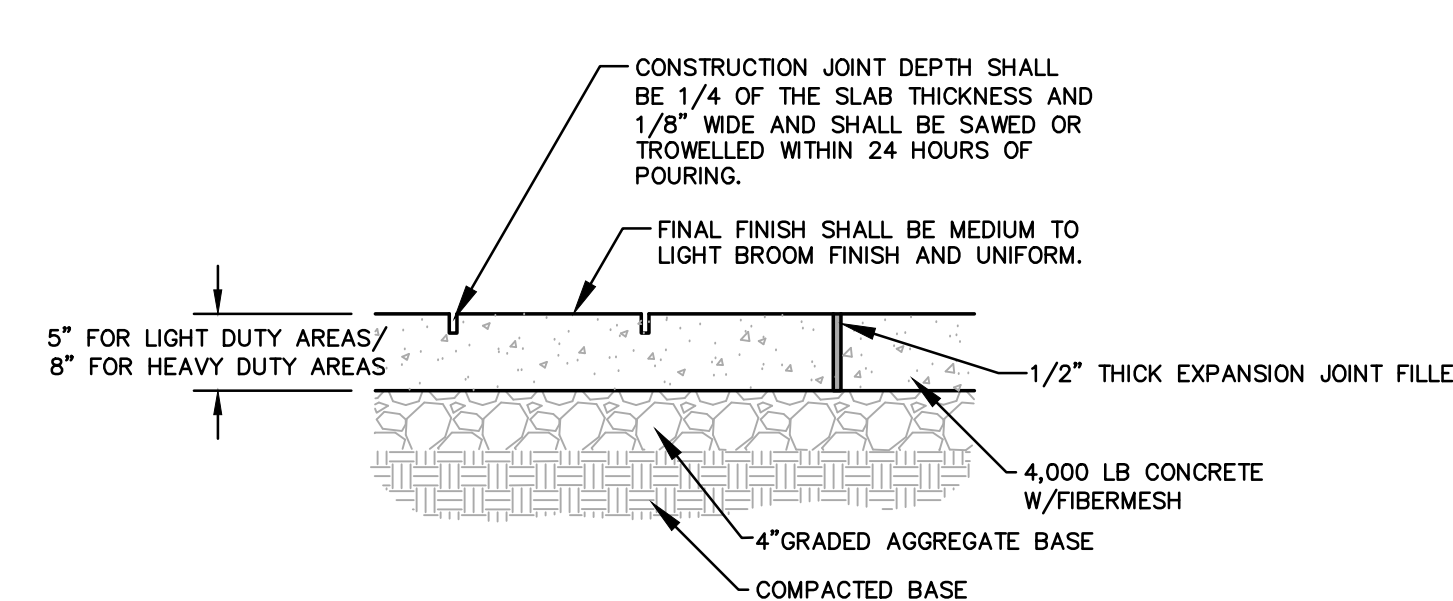
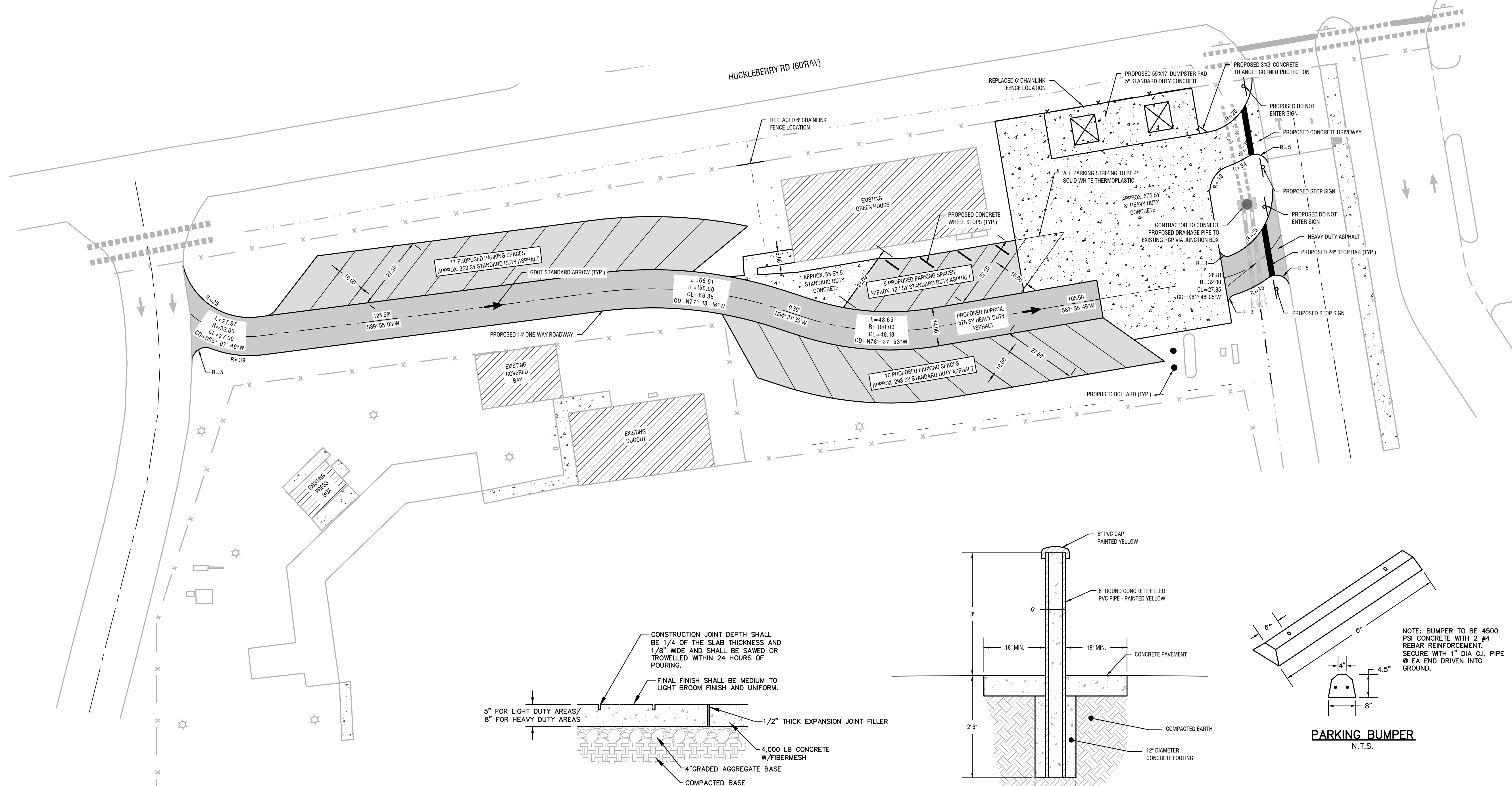
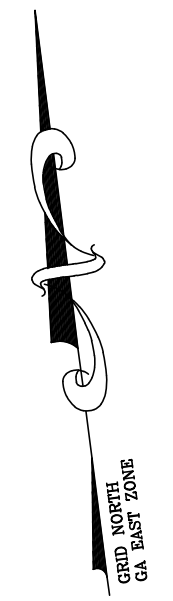
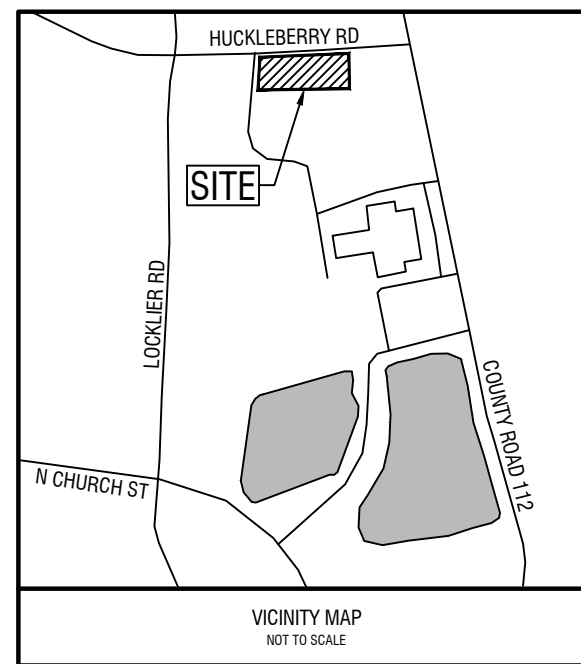

**CONCRETE PAVING DETAIL**  
N.T.S.

- NOTES:**
- CONSTRUCTION JOINTS: 12' O.C. MAX
  - EXPANSION JOINTS: 20' O.C. MAX
  - THE CONCRETE SHOULD BE AIR ENTRAINED AND HAVE A MINIMUM COMPRESSIVE STRENGTH OF 4,000 PSI AFTER 28 DAYS OF LAB CURING PER ASTM C-31.
  - GRADED AGGREGATE BASE SHOULD CONFORM TO THE GDOT MATERIAL SPECIFICATION SECTION 815.
  - THE SELECT FILL SHOULD BE RELATIVELY CLEAN SANDS WITH PERCENT FINES LESS THAN 15%. THE FILL MATERIAL SHOULD BE COMPACTED TO A MINIMUM OF 95% OF THE SOIL'S MODIFIED PROCTOR MAXIMUM DRY DENSITY (ASTM D-1557).
  - IF SP OR SP-SM OR SM SOILS EXIST AT THE PROPOSED SUBGRADE ELEVATION EXTENDING TO A DEPTH AT LEAST 24" BELOW THE PROPOSED SUBGRADE LEVEL, THE IN-SITU SOILS CAN REPLACE THE SELECT FILL AND THE SUBGRADE SHOULD BE IMPROVED USING DENSIFICATION AS DISCUSSED IN THE EARTHWORKS SECTION OF THE GEOTECHNICAL REPORT.
  - CONCRETE JOINTS SHOULD BE SEALED PROPERLY TO AVOID INGRESS OF SURFACE WATER INTO THE SUBGRADE SOILS. PROPER SURFACE AND SUBGRADE DRAINAGE SYSTEM SHOULD BE INSTALLED TO MAINTAIN THE GROUNDWATER AT LEAST 2' BELOW THE TOP OF THE SUBGRADE.
  - SOME SUBGRADE SOIL UNDERCUTTING AND BACKFILLING WITH SUITABLE STRUCTURAL FILL WILL BE REQUIRED IF UNSTABLE SUBGRADE SOILS ARE ENCOUNTERED DURING SUBGRADE PREPARATION.

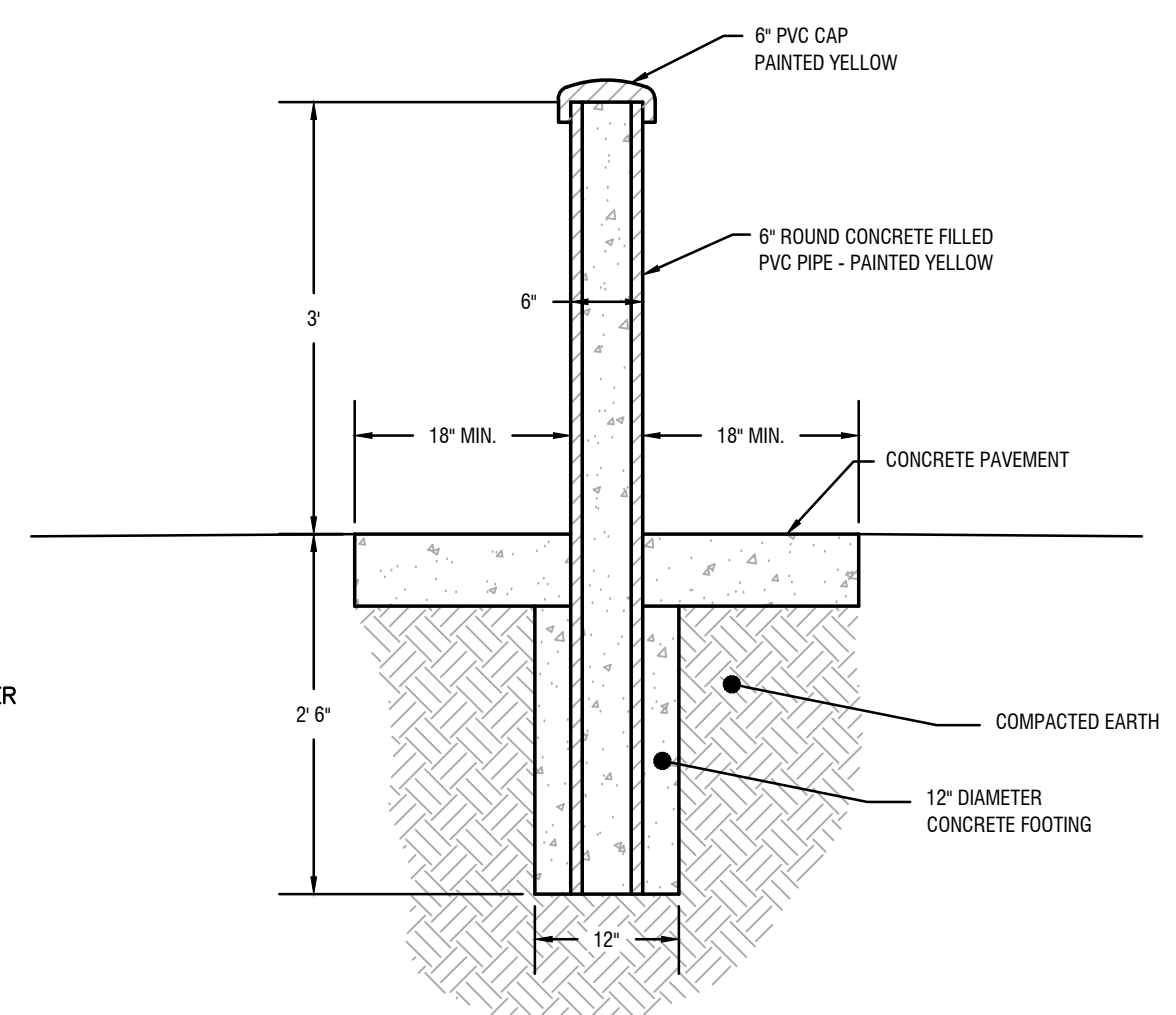

**PIPE BOLLARD DETAIL**  
N.T.S.

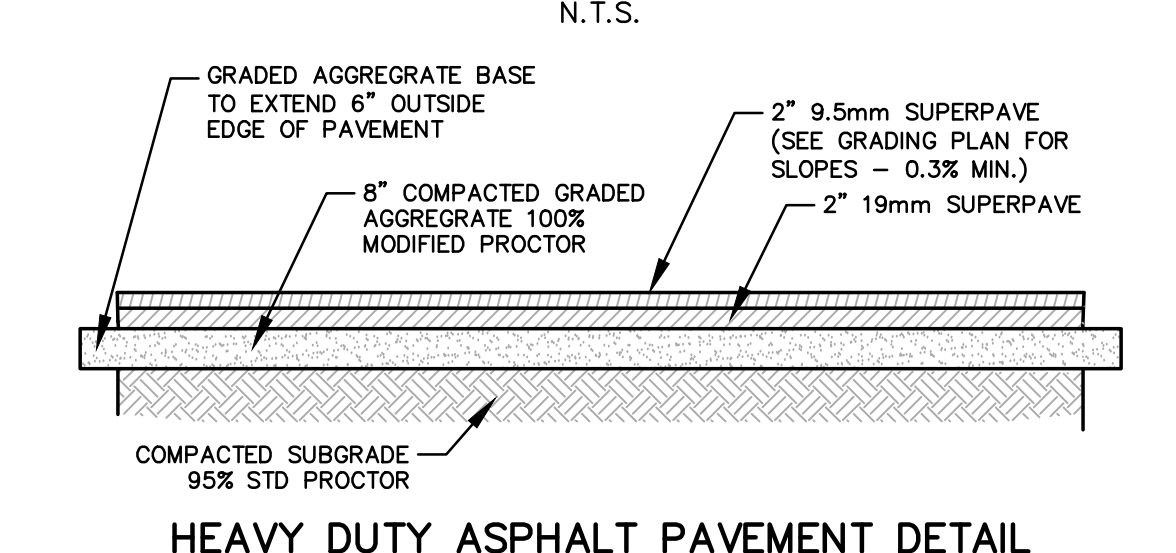

**HEAVY DUTY ASPHALT PAVEMENT DETAIL**  
N.T.S.

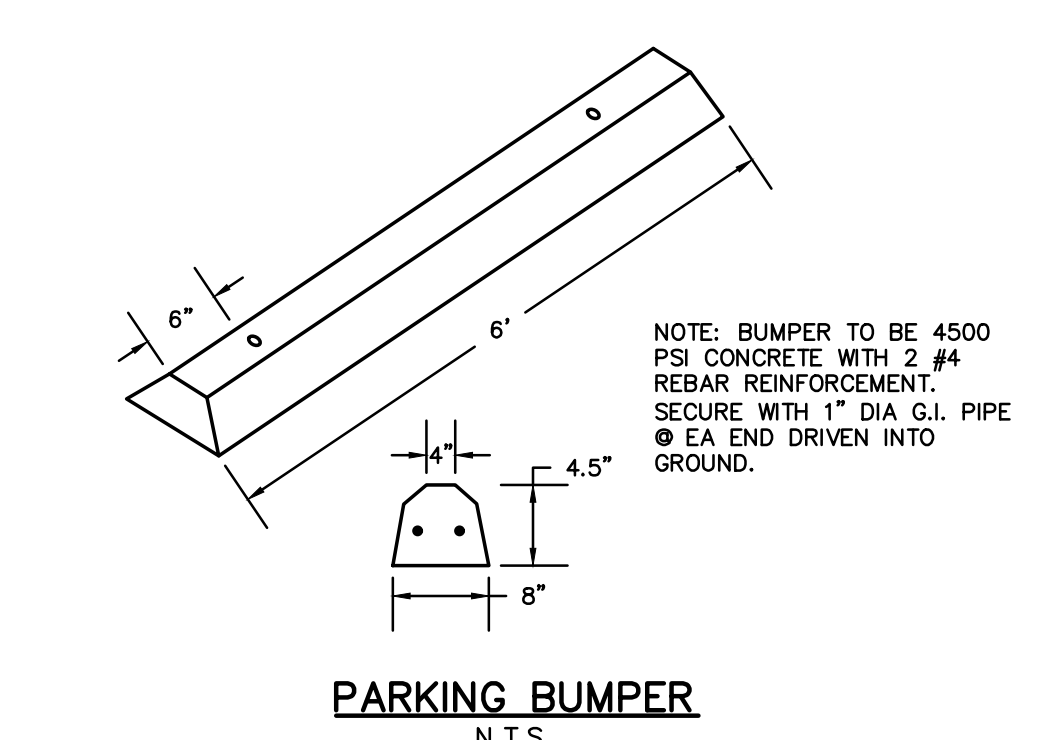

**PARKING BUMPER**  
N.T.S.

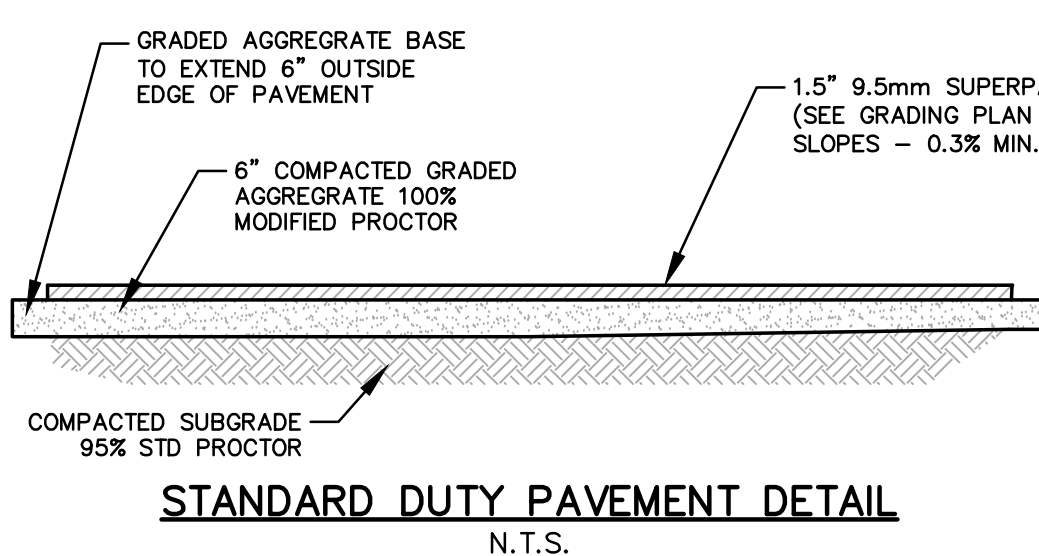

**STANDARD DUTY PAVEMENT DETAIL**  
N.T.S.

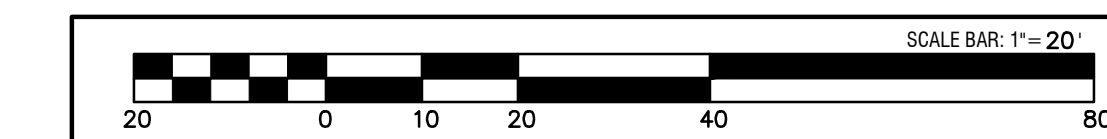

REVISIONS:

**DESIGN PROFESSIONAL:**  
MARCUS E. SACK  
GSWCC LEVEL II # 70248  
EXPIRES: 06/14/2026  
MARCUS@MESACK.COM

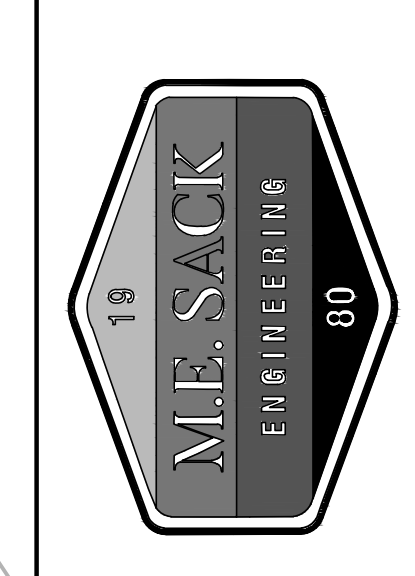

**MUNICIPALITY:**  
CITY OF HOMERVILLE

**COUNTY:**  
CLINCH COUNTY

**OWNER:**  
CLINCH COUNTY SCHOOL SYSTEM  
1 PANTHER WAY  
HOMERVILLE GA, 31634

**24 HOUR CONTACT:**  
MARCUS SACK  
515 NORTH MAIN STREET  
HINESVILLE GA, 31313  
912-368-5212  
MARCUS@MESACK.COM

**CLINCH COUNTY  
CONNECTOR ROAD  
AND TRACK  
IMPROVEMENTS**

**SITE PLAN**

**C200**

**FILE NO:** 2025-82  
**PLOT DATE:** March 4, 2026



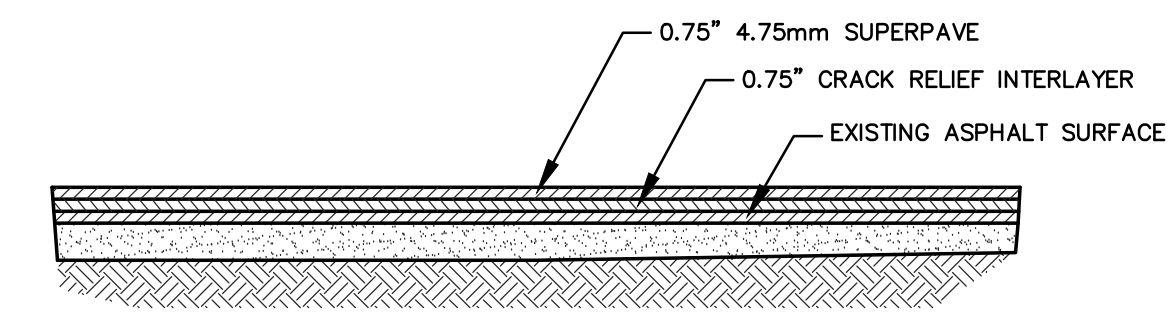
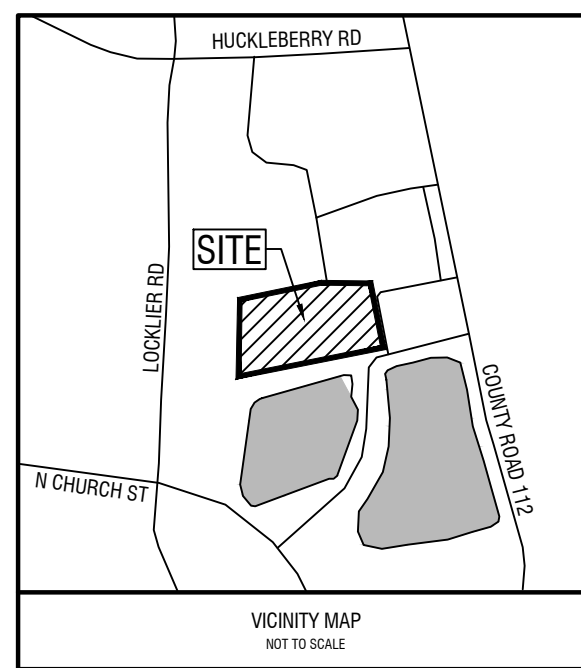

**PROPOSED PAVEMENT OVERLAY DETAIL**  
N.T.S.

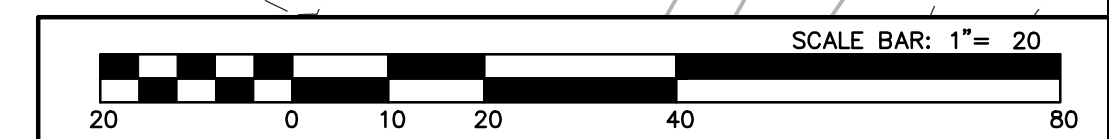
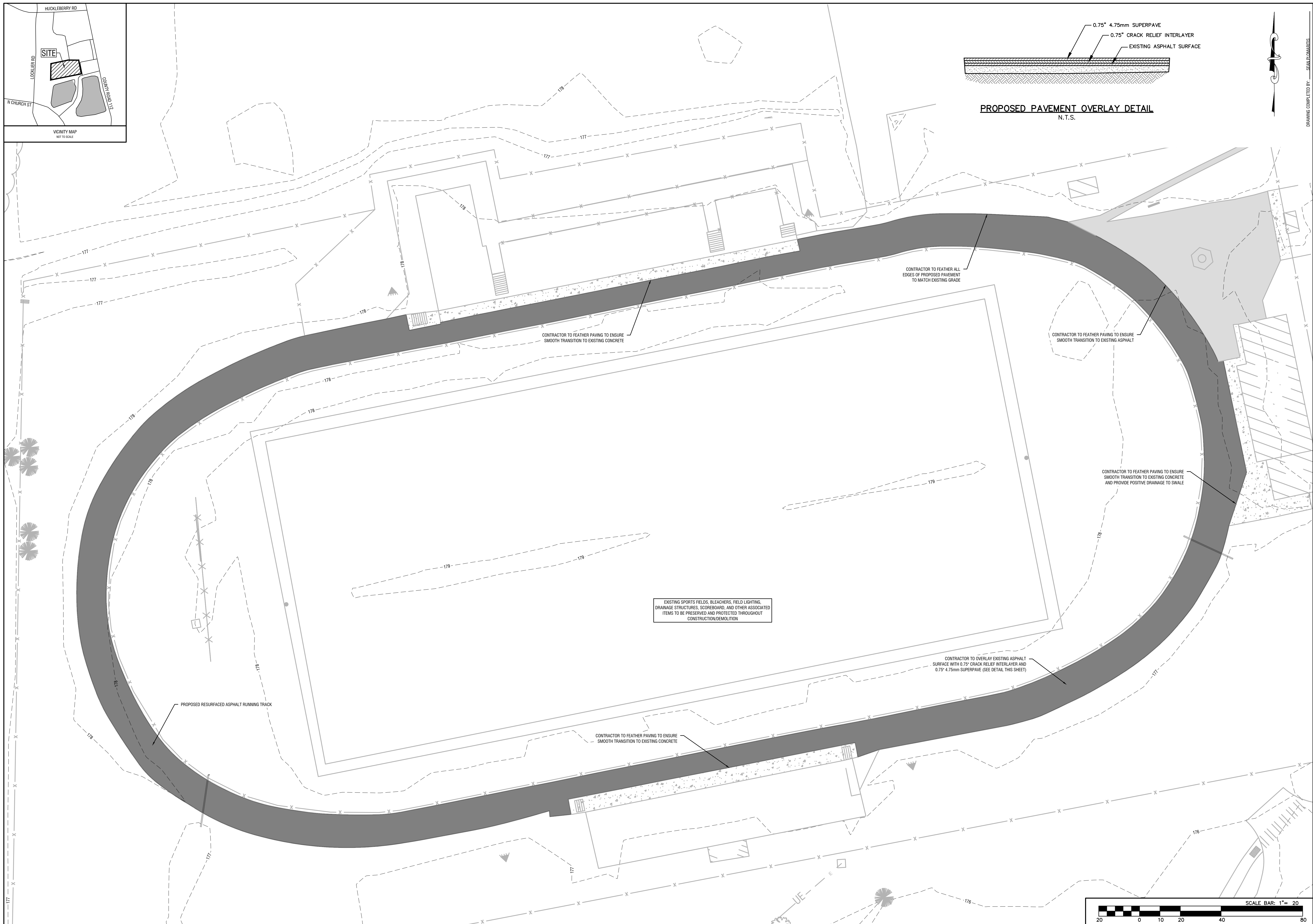

REVISIONS:

DESIGN PROFESSIONAL:  
**MARCUS E. SACK**  
 GSWCC LEVEL II # 70248  
 EXPIRES: 06/14/2026  
 MARCUS@MESACK.COM

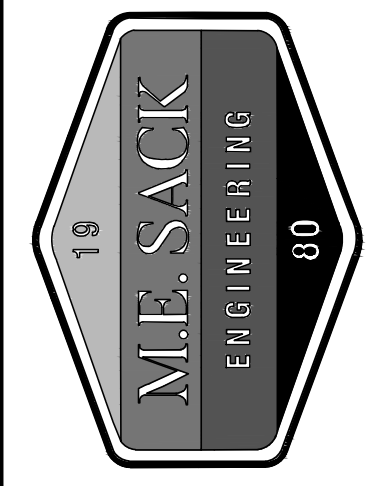

MUNICIPALITY:  
CITY OF HOMERVILLE

COUNTY:  
CLINCH COUNTY

OWNER:  
CLINCH COUNTY SCHOOL SYSTEM  
1 PANTHER WAY  
HOMERVILLE GA, 31634

24 HOUR CONTACT:  
 MARCUS SACK  
 515 NORTH MAIN STREET  
 HINESVILLE GA, 31313  
 912-368-5212  
 MARCUS@MESACK.COM

**CLINCH COUNTY  
CONNECTOR ROAD  
AND TRACK  
RESURFACING**

SITE PLAN  
ALTERNATIVE B:  
PAVEMENT  
OVERLAY

**C202**

FILE NO: 2025-82  
 PLOT DATE: March 4, 2026





**Ds1 DISTURBED AREA STABILIZATION (W/MULCHING ONLY)**

**SPECIFICATIONS**

A. For temporary protection of critical areas without seeding. This standard applies to grades or cleared areas which may be subjected to erosion for 6 months or less, where seeding may not have a suitable growing season to produce an erosion retardant cover, but which can be stabilized with a mulch cover.

**Site Preparation**

1. Grade, as needed and feasible, to permit the use of equipment for applying and anchoring mulch.
2. Install needed erosion control measures as required such as dikes, diversions, berms, terraces and sediment basins.
3. As needed and feasible, loosen compact soil to a minimum depth of 3 inches.

**Mulching Materials**

1. Dry straw or hay – spread at a rate of 2 1/2 tons per acre.
2. Wood waste, chips, sawdust or bark – spread 2 to 3 inches deep (about 6 to 9 tons per acre).
3. Erosion control matting or netting, such as excelsior, jute, textile and plastic matting and netting – applied in accordance with manufacturer's recommendations.
4. Polyethylene film – secured over banks or stockpiled soil material for temporary protection.

**Applying and Anchoring Mulch**

1. Apply straw or hay mulch uniformly by hand or mechanically. Anchor as appropriate and feasible. It may be pressed into the soil with a disk harrow with the disk set straight or with a special "pucker disk." The disk may be smooth or serrated and should be 20 inches or more in diameter and 8 to 12 inches apart. The edges of the disk should be dull enough not to cut the mulch but press it into the soil leaving much of it in an erect position.
2. Straw hay mulch spread with special blower-type equipment may be anchored with emulsified asphalt (Grade AE-5 or SS-1). The asphalt emulsion must be sprayed onto the mulch as it is ejected from the machine. Use 100 gallons of water per acre.
3. Spread wood waste uniformly on slopes that are 3:1 and flatter. No anchoring is needed.
4. Commercial matting and netting. Follow manufacturer's specification included with the material.
5. Apply asphalt to area has uniform appearance. (Note: Use in areas of pedestrian traffic could cause problems or "tracking in" or damage to shoes, clothing, etc.)

**Mulching Materials**

Use one of the materials given below and apply at thickness indicated.

Material	Depth
1. Grain straw or grass hay	6" to 10"
2. Pine needles	4" to 6"
3. Wood waste (sawdust, bark, chips)	4" to 8"
4. Shredded residues (crops, leaves, etc.)	4" to 8"

5. Completely cover area with black polyethylene film and hold in place by placing soil on the outer edge.
6. When using organic mulches, apply 20-30 pounds of nitrogen in addition to the normal amount needed for plant growth to offset the tie up of N by decomposition of mulch.

**MULCHING RATES FOR PERMANENT COVER**

TYPE OF MULCH	RATE PER ACRE	NOTES
Dry straw	2 Tons	Free of weed seeds.
Dry hay	2.5 Tons	Free of weed seeds.
Wood Cellulose	500 lbs. / 1000 lbs.	Slope less than 3/4:1 / Slope greater than 3/4:1
Wood Pulp Fiber	500 lbs. / 1000 lbs.	Slope less than 3/4:1 / Slope greater than 3/4:1
Sericea Lespedeza Hay	3 Tons	Containing mature seeds.
Pine Straw or Bark	3 inches thick	For bedding. Not for seeding.
Bituminous treated roving	See DOT specs.	Use on slopes, in ditches, or dry waterways.

1. Mulching is not required for temporary grassing.
2. Mulch shall be applied to cover 75% of the soil surface.
3. Sod does not require mulch.

**Du DUST CONTROL ON DISTURBED AREAS**

**PURPOSE**

- A. To prevent surface and air movement of dust from exposed surfaces.
- B. To reduce the presence of airborne substances which may be harmful or injurious to human health, welfare, or safety, or to animals or plant life.

**Temporary Methods**

1. Irrigation. This is generally done as an emergency treatment. Site is sprinkled with water until the surface is wet.
2. Mulching – See Ds1 – Disturbed Area Stabilization (with Mulching only)
3. Vegetative Cover – See Ds2 – Disturbed Area Stabilization (with Temporary Seeding)

**Permanent Methods**

1. Permanent Vegetation – See Ds3 – Disturbed Area Stabilization (with Permanent Vegetation)

**FERTILIZER REQUIREMENTS**

TYPE OF SPECIES	YEAR	ANALYSIS OR EQUIVALENT	RATE	N TOP DRESSING RATE
Cool season grasses	First	6-12-12	1500 lbs./ac.	50-100 lbs./ac. 1/ 2/ 30
	Second	6-12-12	1000 lbs./ac.	
	Maintenance	10-10-10	400 lbs./ac.	
Cool season grasses legumes	First	6-12-12	1500 lbs./ac.	0-50 lbs./ac. 1/ 2/ 30
	Second	0-10-10	1000 lbs./ac.	
	Maintenance	0-10-10	400 lbs./ac.	
Ground covers	First	10-10-10	1500 lbs./ac.	-
	Second	10-10-10	1000 lbs./ac.	
	Maintenance	10-10-10	400 lbs./ac.	
Pine seedlings	First	20-10-5	one 21-gram pallet per seeding placed in the closing hole	-
	Second	-	-	
	Maintenance	-	-	
Shrub leavedeza	First	0-10-10	700 lbs./ac.	-
	Second	0-10-10	700 lbs./ac. 4/	
	Maintenance	-	-	
Temporary cover crops seeded alone	First	10-10-10	500 lbs./ac.	30 lbs./ac. 5/
	Second	-	-	
	Maintenance	-	-	
Warm season grasses	First	6-12-12	1500 lbs./ac.	50-100 lbs./ac. 2/ 6/ 30 lbs./ac. 2/
	Second	6-12-12	800 lbs./ac.	
	Maintenance	10-10-10	400 lbs./ac.	
Warm season grasses and legumes	First	6-12-12	1500 lbs./ac.	50 lbs./ac. 6/
	Second	0-10-10	1000 lbs./ac.	
	Maintenance	0-10-10	400 lbs./ac.	

- 1/ Apply in spring following seeding.
- 2/ Apply in split applications when high rates are used.
- 3/ Apply in 3 split applications.
- 4/ Apply when plants are pruned.
- 5/ Apply to grass species only.
- 6/ Apply when plants grow to height of 2 to 4 inches.

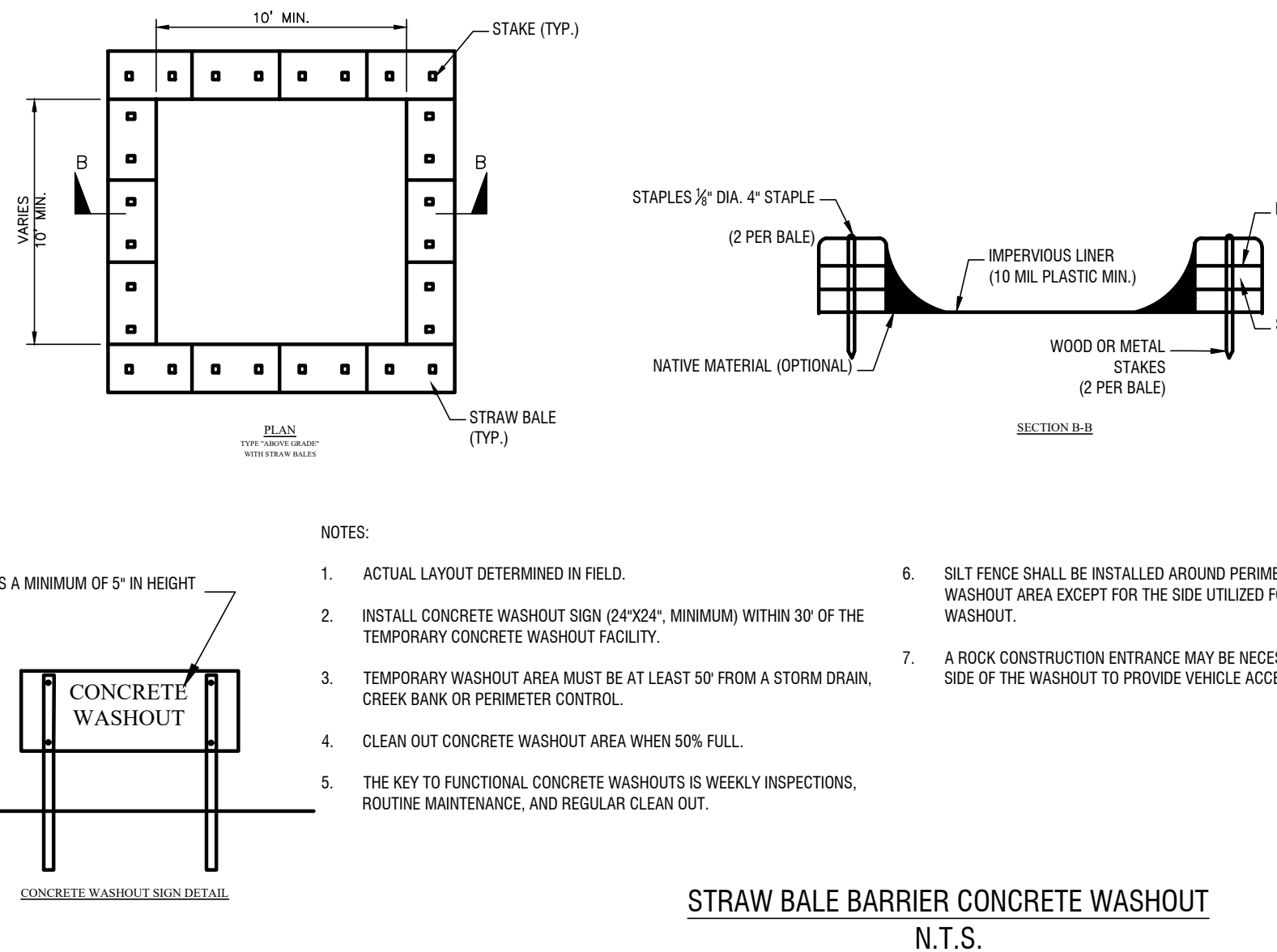
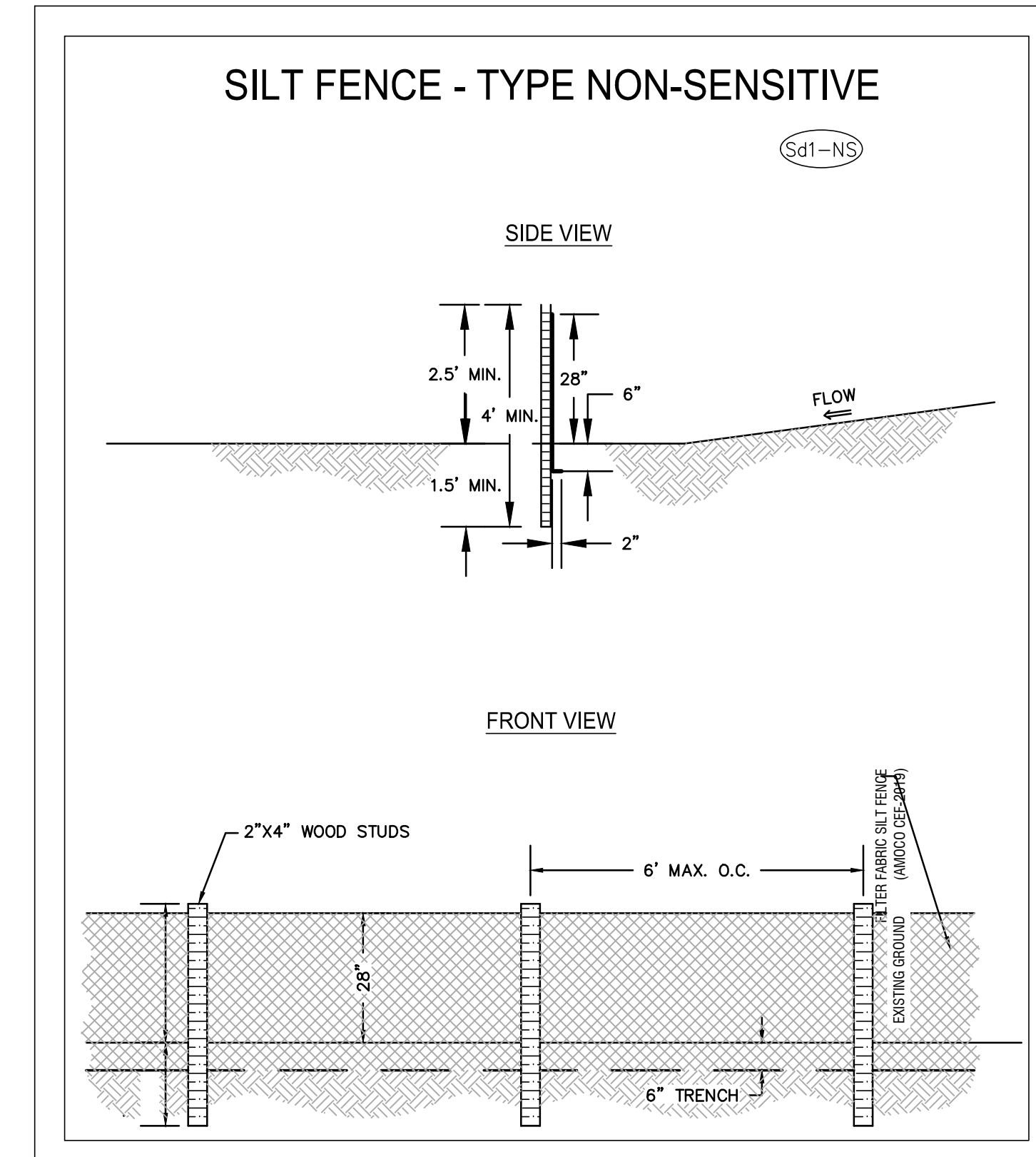
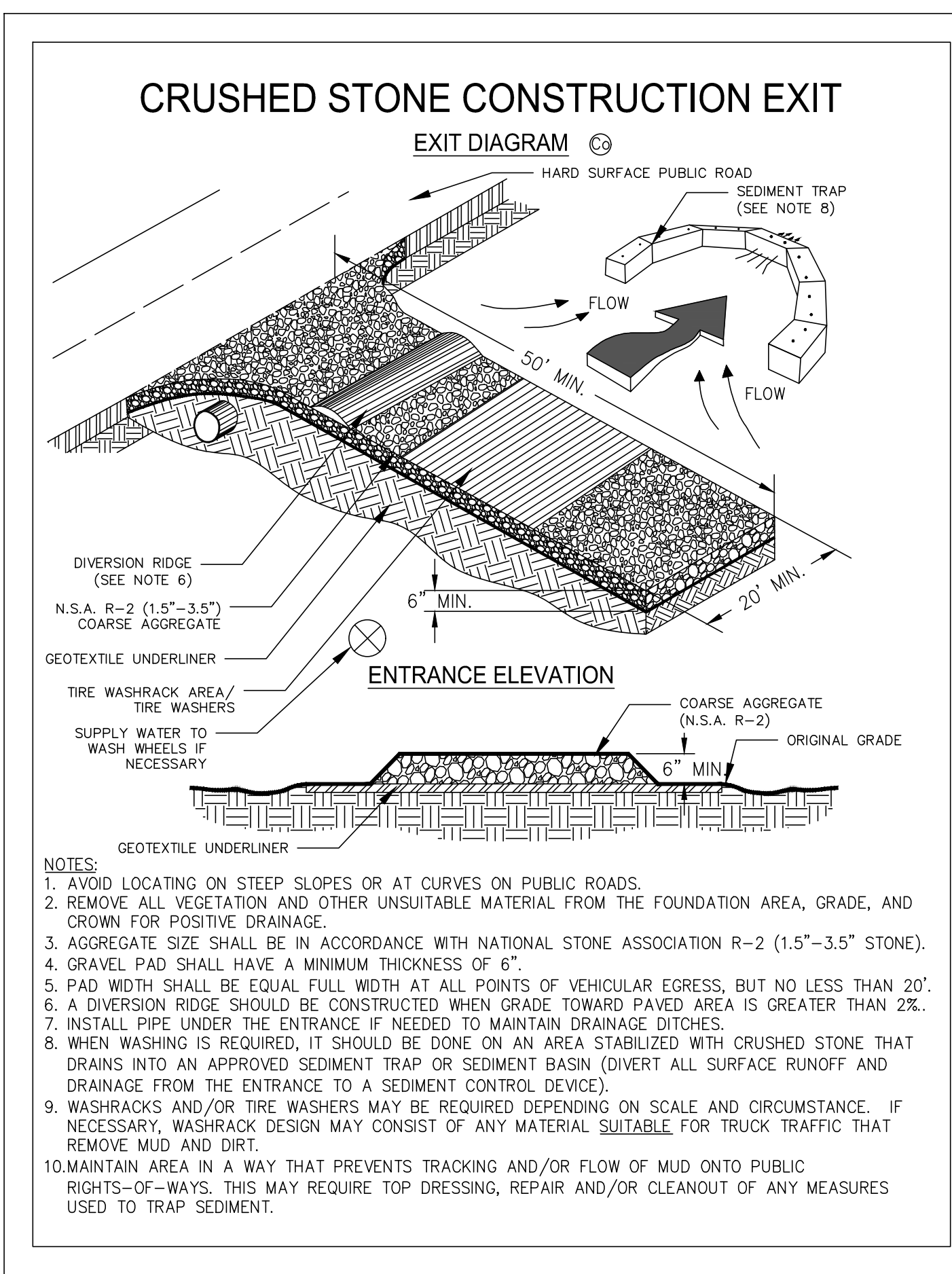
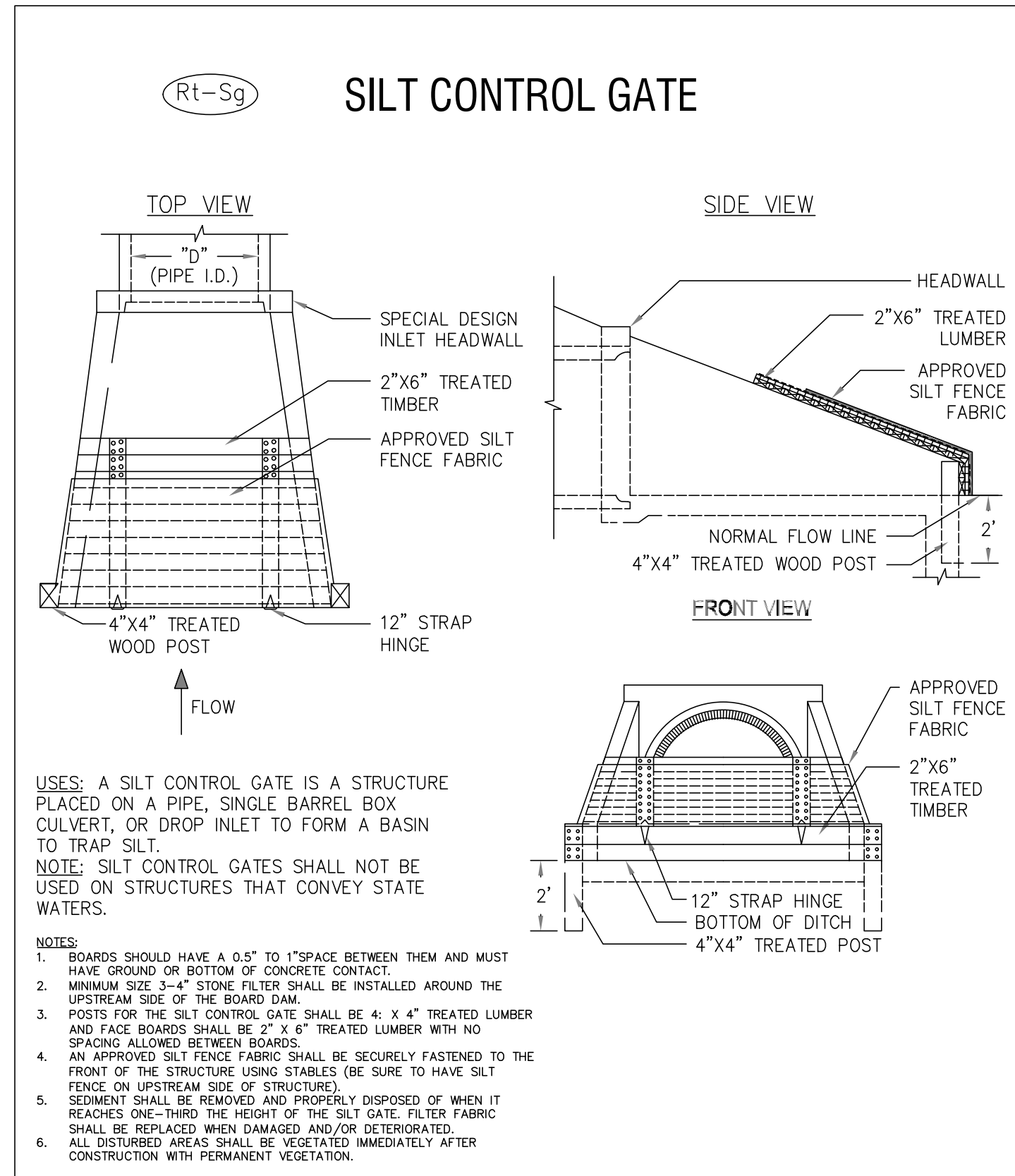

**Ds3 SPECIES AND PLANTING SCHEDULE**

SPECIES	BROADCAST RATES 1/ - PLS 2/ PER ACRE PER 1000 S.F.	RESOURCE AREA 3/	PLANTING DATES BY RESOURCE AREAS *												SPECIFICATIONS		
			J	F	M	A	M	J	J	A	S	O	N	D			
BERMUDA, COMMON HUILLED SEED ALONE WITH OTHER PERENNIALS	10 LBS. 0.2 LB. / 6 LBS. 0.1 LB.	P C															1,787,000 SEED PER POUND. QUICK COVER. LOW GROWING AND SOD FORMING. FULL SUN. GOOD FOR ATHLETIC FIELDS.
BERMUDA, COMMON UNHUILLED SEED WITH TEMPORARY COVER WITH OTHER PERENNIALS	10 LBS. 0.2 LB. / 6 LBS. 0.1 LB.	P C															PLANT WITH WINTER ANNUALS. PLANT WITH TALL FESCUE.
BERMUDA SPRIGS COASTAL, COMMON, MIDLAND, OR TIFT 44 COASTAL, COMMON, TIFT 44	40 CU. FT. 0.9 CU.FT. OR SOD PLUGS 3' X 3'	M-L P C C															A CUBIC FT. CONTAINS APPROXIMATELY 650 SPRIGS. A BUSHEL CONTAINS 1.25 C.F. OR APPROXIMATELY 800 SPRIGS. SAME AS ABOVE.
TIFT 78																	SOUTHERN COASTAL PLAIN ONLY

\* (DARK LINES REPRESENT OPTIMUM DATES, GRAY LINES INDICATE PERMISSIBLE BUT MARGINAL DATES.)

**Ds2 SPECIES AND PLANTING SCHEDULE**

SPECIES	BROADCAST RATES 1/ - PLS 2/ PER ACRE PER 1000 S.F.	RESOURCE AREA 3/	PLANTING DATES BY RESOURCE AREAS *												REMARKS		
			J	F	M	A	M	J	J	A	S	O	N	D			
RYEGRASS, ANNUAL ALONE	40 lbs. 0.9 lb.	M-L P C															227,000 SEED PER POUND. DENSE COVER. VERY COMPETITIVE AND IS NOT TO BE USED IN MIXTURES.

\* (DARK LINES REPRESENT OPTIMUM DATES, GRAY LINES INDICATE PERMISSIBLE BUT MARGINAL DATES.)

REVISIONS:

THIS DRAWING IS AN INSTRUMENT OF SERVICE AND REMAINS THE PROPERTY OF P.C. SIMONTON & ASSOCIATES, INC. AND M.E. SACK ENGINEERS. IT MAY NOT BE COPIED, ALTERED, OR REPRODUCED IN ANY MANNER WITHOUT PERMISSION ON A SIGNED AND SEALED DOCUMENT. THE INFORMATION CONTAINED HEREIN IS INTENDED FOR THE NAMED CLIENT ONLY. IN THE EVENT OF AN ELECTRONIC VERSION OF THIS DRAWING, THE ORIGINAL DRAWING SHALL BE THE AUTHORITY. ENGINEERING ASSUMES NO RESPONSIBILITY FOR DATA GENERATED, ALTERED OR TAKEN FROM THIS DRAWING. IN THE EVENT OF A DISPUTE, HARD COPIES WILL TAKE PRECEDENCE OVER ANY ELECTRONIC MEDIA.

DESIGN PROFESSIONAL:

MARCUS E. SACK  
 GSWC LEVEL II # 70248  
 EXPIRES: 06/14/2026  
 MARCUS@MESACK.COM

515 NORTH MAIN STREET  
 P.O. BOX 549  
 HINESVILLE, GA 31313  
 TEL: (912) 368-5212

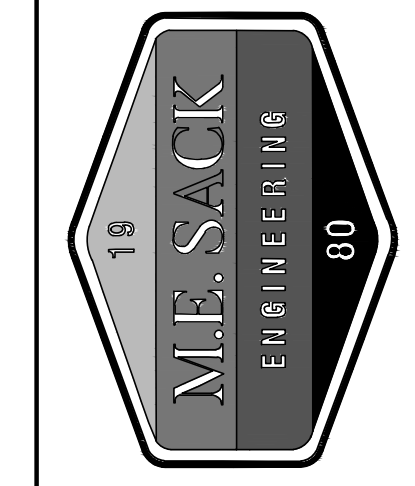
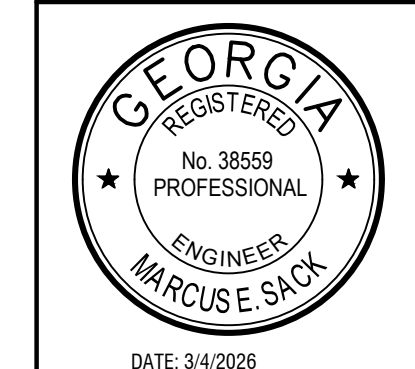

MUNICIPALITY:  
CITY OF HOMERVILLE

COUNTY:  
CLINCH COUNTY

OWNER:  
CLINCH COUNTY SCHOOL SYSTEM  
1 PANTHER WAY  
HOMERVILLE GA, 31634

24 HOUR CONTACT:  
MARCUS SACK  
515 NORTH MAIN STREET  
HINESVILLE, GA 31313  
912-368-5212  
MARCUS@MESACK.COM

CLINCH COUNTY  
CONNECTOR ROAD  
AND TRACK  
IMPROVEMENTS

EROSION CONTROL DETAILS

C401

FILE NO: 2025-82  
 PLOT DATE: March 4, 2026



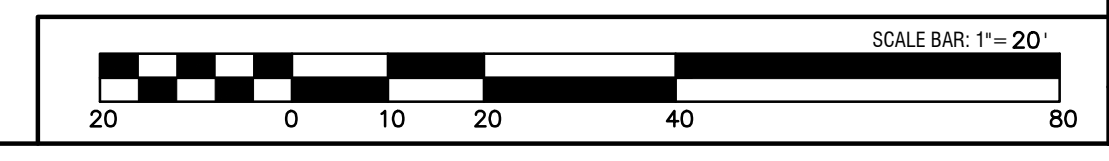
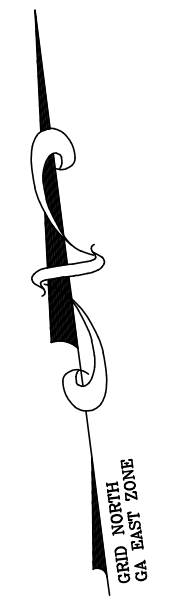
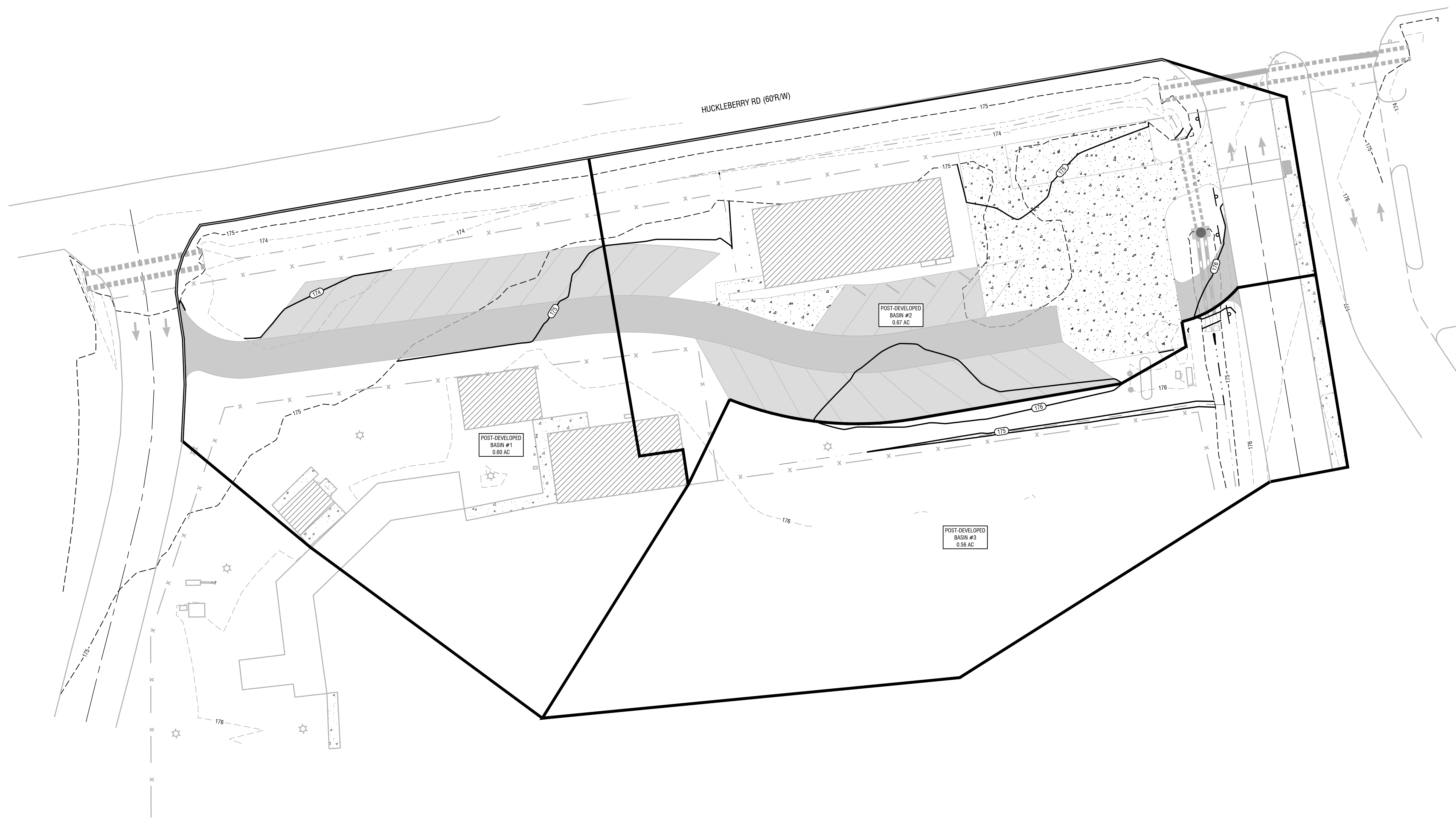
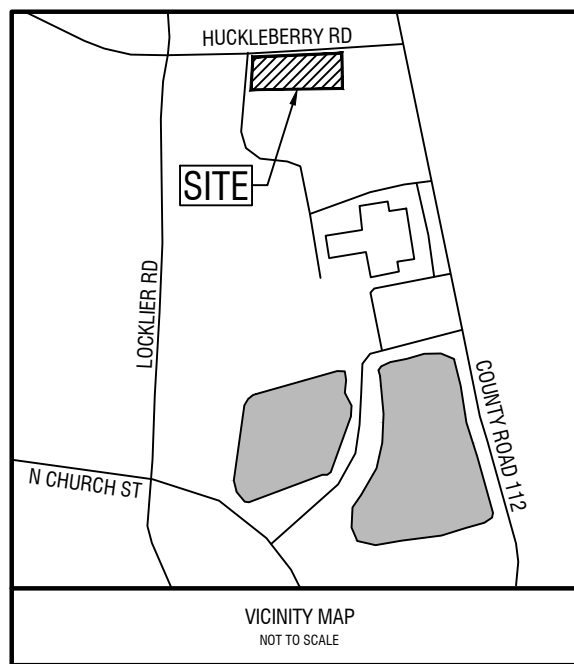

REVISIONS:

DESIGN PROFESSIONAL:  
**MARCUS E. SACK**  
 GSWCC LEVEL II # 70248  
 EXPIRES: 06/14/2026  
 MARCUS@MESACK.COM

515 NORTH MAIN STREET  
 P.O. BOX 649  
 HINESVILLE, GA 31313  
 TEL: (912) 368-5212

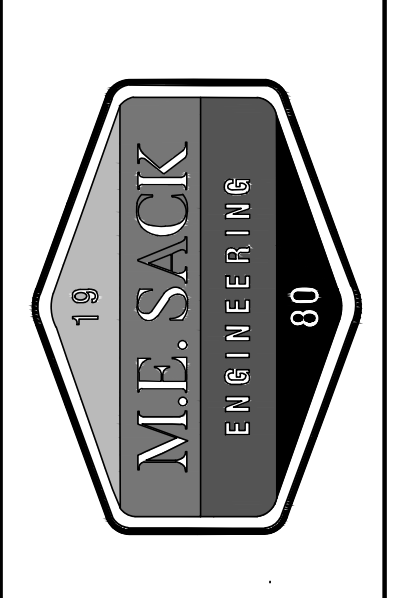

MUNICIPALITY:  
 CITY OF HOMERVILLE

COUNTY:  
 CLINCH COUNTY

OWNER:  
 CLINCH COUNTY SCHOOL SYSTEM  
 1 PANTHER WAY  
 HOMERVILLE GA, 31634

24 HOUR CONTACT:  
 MARCUS SACK  
 515 NORTH MAIN STREET  
 HINESVILLE GA, 31313  
 912-368-5212  
 MARCUS@MESACK.COM

**CLINCH COUNTY  
 CONNECTOR ROAD  
 AND TRACK  
 IMPROVEMENTS**

POST-DEVELOPED  
 BASIN MAP

**C501**

FILE NO: 2025-82  
 PLOT DATE: March 4, 2026