



515 N. Main Street | Hinesville, GA 31313
PO Box 649 | Hinesville, GA 31310
912.368.5212
www.mesack.com
ME Sack Engineering
@mesackengineering
mesack



ADDENDUM No. ONE

Date: September 15, 2025

Project: Jones Street Reclamation, MES No. 2025-06

Engineer: M.E. Sack Engineering *MS*
Hinesville, Georgia

The original plans, specifications, and bid documents are amended to include the following:

Table of Contents:

- Replace the previous Table of Contents with the enclosed of the same. Note that Appendix F has been added.

Invitation for Bids:

- Replace the previous Invitation for Bids with the enclosed of the same. Note that concrete pavement removal was removed from the scope of work.

Bid Document:

- Include the enclosed Appendix F: Traffic Control Plan to the original document.

Bid Form:

- Replace the previous Bid Form with the enclosed of the same. Note that Concrete Pavement Removal was removed from the list.

Specifications:

- Replace the previous Section 01150 Measurement & Payment with the enclosed of the same. Note that Concrete Pavement Removal was removed.

Plan Set:

- Replace the previous Sheets C100-101, C200-201, and C300 with the enclosed of the same. Note that labels were removed from Sheets C100-101 and C200-201, and that a detail was removed from C300.

We offer the following clarifications for questions received:

- 1) *Will the Contractor be required to pay for an independent mix design for the FDR?*
 - The mix design provided is a guide and has been used to determine quantities for the project. The contractor shall hire and maintain their independent testing company for mix designs and inspections.

- 2) *How will the 10" GAB for patching be paid for?*
 - We have removed the deep patches with the expectation that milling and cement will be sufficient for these areas.

-END-

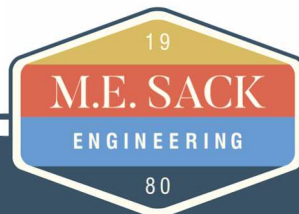

TABLE OF CONTENTS

SECTION I Invitation for Bids..... 1

SECTION II Instructions to Bidders..... 2

A. Submission of Proposals..... 2

B. Interpretations 2

C. Basis of Contract Award 3

D. Forms and Bonds..... 3

E. Inspecting and Testing of Materials 3

F. Construction Schedule 3

G. Insurance 4

H. Construction Staking 4

I. Utility Contractor Licensing Law 4

SECTION III Bid Submission Forms 5

A. Bidder Declaration, Part 1 5

B. Bid Form 6

C. Bidder Declaration, Part 2 7

D. Bonding Agent and Underwriter 8

E. Addendum Acknowledgement..... 8

F. Bidder Qualification Form..... 9

G. Bidder Experience and References..... 10

H. Site Visit Certification 11

I. Utility Certification 12

SECTION IV Sample Contract..... 13

A. Payment and Performance Bond 16

SECTION V Other Conditions of Contract by Attachment V

A. Supplemental Conditions V-A

B. General Conditions V-B

C. Technical Specifications V-C

SECTION 01001 General Requirements

SECTION 01150 Measurement and Payment

SECTION 02100 Clearing and Grubbing

SECTION 02611 Base and Paving

SECTION 02616 Pavement Removal and Replacement

SECTION 02821 Grassing

SECTION 03300 Concrete, General

D. Georgia Department of Transportation (GDOT) Specifications V-D

SECTION 301 Soil-Cement Construction

SECTION 611 Relaying, Reconstructing, or Adjusting to Grade of Miscellaneous Roadway Structures

E. Geotechnical Engineering Report V-E

F. Traffic Control Plan V-F

SECTION I: INVITATION FOR BIDS

Sealed proposals will be received on behalf of SNF Holding Company by M.E. Sack Engineering located at 515 N. Main Street, Hinesville, Georgia on September 23, 2025 until 10:00 a.m. local time for the Jones Street Reclamation.

The work to be performed consists of furnishing all labor and materials to complete the Jones Street Reclamation. More specifically, the project will consist of shoulder scraping, full-depth roadway reclamation, stabilization for base course, 1.5" 12.5mm asphalt paving, 3" 19mm asphalt paving, concrete driveway/sidewalk remove/replace, striping, shoulder backing, grassing, and traffic control.

Plans, Specifications, and Contract documents are open to public inspection at ConstructConnect, Dodge Construction Network, and www.mesack.com. Copies of the Plans, Specifications, and Contract Documents may be obtained by contacting M.E. Sack Engineering, bid@mesack.com, 515 North Main Street, P.O. Box 649, Hinesville, Georgia 31310, (912) 368-5212, and by depositing a non-refundable one hundred fifty dollars (\$150) for each set of plans requested.

Each Contractor must prequalify for bid by submitting a completed "Statement of Bidder Qualifications" form supplied by the Engineer. Bids will be accepted from prequalified bidders only.

Bids must be accompanied by a certified check or bid bond in an amount equal to at least five percent (5%) of total amount bid for the completed work.

No bids may be withdrawn for a period of sixty (60) days after the closing time schedule for receipt of bids.

The Owner reserves the right to accept or reject any or all bids and to waive informalities. Award of the contract, if it is awarded, will be to the lowest responsible bidder.

NOTE: Plans and Specifications must be obtained no later than five (5) working days before the bid date. No exceptions.

F. TRAFFIC CONTROL PLAN



CHEMICAL PLANT RD

PHASE 4

DURING PHASE 4, CONTRACTOR SHALL BARREL A TOW LANE TRUCK ENTRY ALONG CHEMICAL PLANT ROAD. FLAGMEN SHALL BE ON SITE TO ASSIST TRUCK STACKING, PARKING, AND MANEUVERING.

PHASE 4 FROM CHEMICAL PLANT ROAD TO TRUCK ENTRANCE, TO BE SHUT DOWN AND PAVED AT ONE TIME. TRAFFIC CONTROL, BARRELS AND FLAGGING TO BE PROVIDED.

PHASE 1 FROM JUST BEYOND TRUCK ENTRANCE TO THE LAST DRIVE FOR PARKING AREA, SECTION CAN BE FULLY CLOSED. PARKING VEHICLES TO ENTER FROM NCF PLANT ROAD, TRUCKS ENTER NORMALLY.

PHASE 2 FROM PARKING DRIVE TO NCF PLANT ROAD, CAN BE FULLY CLOSED AND COMPLETE.

PHASE 3 FROM NCF PLANT ROAD TO END OF JONES STREET. ROAD SHALL BE PERFORMED ONE LANE AT A TIME WITH FLAGMEN, CONES, AND BARRELS AS NEEDED.

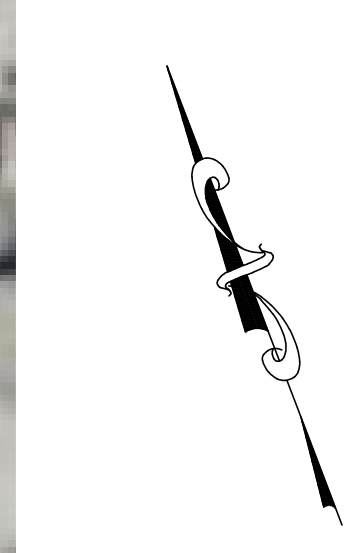

REVISIONS:

DESIGN PROFESSIONAL:
 MARCUS E. SACK
 GSWCC LEVEL II # 70248
 EXPIRES: 06/14/2026
 MARCUS@MESACK.COM

515 NORTH MAIN STREET
 P.O. BOX 649
 HINESVILLE, GA 31313
 TEL: (912) 368-5212

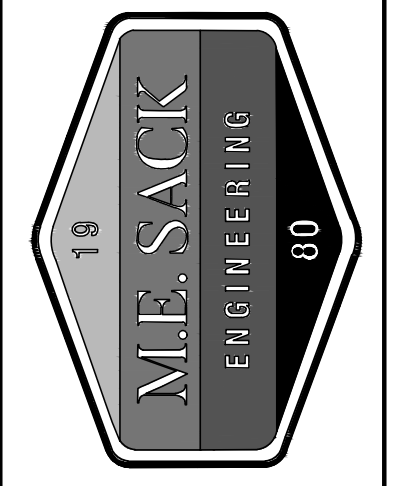

MUNICIPALITY:
 CITY OF RICEBORO

COUNTY:
 LIBERTY COUNTY

OWNER:
 SNF HOLDING COMPANY
 1 CHEMICAL PLANT RD
 RICEBORO, GA 31323
 (912)-884-8726

24 HOUR CONTACT:
 GARY RYALS
 1 CHEMICAL PLANT RD
 RICEBORO, GA 31323
 (912)-884-8754
 MARKETING@SNFHC.COM

**JONES STREET
 RECLAMATION**

**TRAFFIC
 CONTROL
 PLAN**

C100

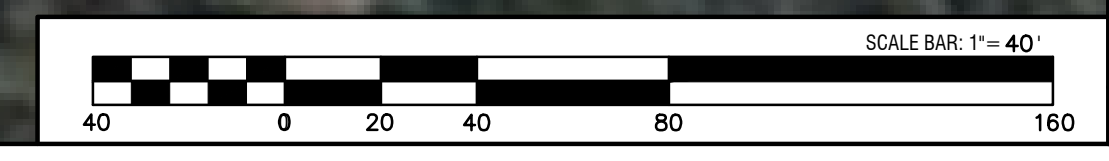

FILE NO: 2025-06
 PLOT DATE: August 15, 2025

B. BID FORM

Bid Item	Quantity	Units	Description	Unit Price	Cost
1	1	LS	Shoulder Scraping & Grubbing	-	\$
2	8,475	SY	Full-Depth Roadway Reclamation	\$	\$
3	350	TN	Recycling Agent (Stabilization) for Base Course (Cement)	\$	\$
4	9,853	SY	1.5" 12.5mm Asphalt Paving	\$	\$
5	9,853	SY	3" 19mm Asphalt Paving	\$	\$
6	1	LS	Feather Asphalt Paving @ Intersections	-	\$
7	7	SY	Concrete Driveway and Sidewalk Remove/Replace	\$	\$
8	1	LS	Shoulder Fill & Grading	-	\$
9	1	LS	Shoulder Grassing	-	\$
10	35	LF	24" Thermoplastic Stop Bar	\$	\$
11	7,005	LF	4" Thermoplastic Solid White Line Striping	\$	\$
12	6,720	LF	5" Thermoplastic Double Solid Yellow Line Striping	\$	\$
13	1	LS	Traffic Control	-	\$
14	1	LS	Mobilization (5% Max)	-	\$
SUBTOTAL					\$
Alternative A					
15.A	9,853	SY	4" Granular Roadway Base	\$	\$
Alternative B					
15.B	9,853	SY	1.5" Open Graded Crack Relief Interlayer	\$	\$
TOTAL BID					\$

**SECTION 01150
MEASUREMENT AND PAYMENT**

PART 1 - GENERAL

1.01 QUANTITIES

- A. Quantities: Quantities listed in the Proposal are approximate only and are intended to serve as a guide in comparing bids, and may be increased or decreased without invalidating the unit price bid.
- B. Payment: Contractor shall be paid for actual in place quantities as determined by the Engineer field measurements.
- C. Discrepancies: In case of discrepancies between the figures shown in the unit prices and totals, the unit prices shall apply and the totals shall be corrected to agree with the unit price.

PART 2 - MEASUREMENT AND PAYMENT

2.01 SHOULDER SCRAPING & GRUBBING

- A. Measurement: Measurement shall be made on the basis of the percentage complete of the task in accordance with the plans and specifications.
- B. Payment: Payment will be made at the lump sum stated in the bid. The price bid shall include furnishing all labor, materials and equipment necessary to complete this item. Work shall include, but is not limited to, removal of all trees, shrubs and undergrowth that presently exist, preventing the construction of this project. All material removed including vegetation, roots and organic mat shall be removed from the site and disposed of at a permitted site. The contractor shall take special care not to disturb the roots of trees that are marked to remain. Trees to be saved shall be marked and approved by the engineer prior. Trees to be saved shall have the appropriate tree protection installed.

2.02 FULL-DEPTH ROADWAY RECLAMATION

- A. Measurement: Measurement shall be made on the basis of each square yard of pavement to undergo full-depth reclamation in accordance with the plans, specifications, and bid documents.
- B. Payment: Payment will be made on the basis of the unit price stated in the bid. The unit price shall include furnishing all labor, materials, and equipment necessary to complete this item of work. Work shall include, but not be limited to, pulverization of roadway and base material, addition of chemical stabilizers, compaction of new base mix, and curing of mix.

2.03 GRANULAR ROADWAY BASE

- A. Measurement: Measurement shall be made on the basis of the number of square yards of graded aggregate base applied to the roadway at the specified thickness as

shown on the construction plans. Irregular areas such as turnouts, filler strips and intersections will be measured to the closest square yard. Prior to installation of the asphalt all areas will be checked for proper thickness.

- B. Payment: Payment will be made on the basis of the number of square yards of granite crusher run (graded aggregated) base at the specified thickness applied to the roadway at the unit price stated in the bid. The price shall include all labor, equipment and material to complete the task. Work shall include, but not be limited to, the furnishing, hauling, placing and compaction of the crusher run base in order to bring the base to the lines, grades, and cross sections shown on the construction plans or established by the Engineer.

2.04 ASPHALT PAVING

- A. Measurement: Measurement will be made on the basis of each ton of asphalt in place, in accordance with the construction plans and accepted by the Engineer. Actual weight will be determined by weighing on a certified motor truck scale and presenting a notarized copy of the recorded weight to the Engineer.
- B. Payment: Payment will be made on the basis of the number of tons of asphalt in place in accordance with the unit price bid as stated in the contract. Work shall include, but is not limited to, the furnishing, hauling, placing and compaction of the asphalt in order to bring the pavement to the lines, grades and cross sections as designated on the construction plans and as determined by the Engineer. The unit price bid shall also include surface cleaning, prime, tack and pavement and handicap striping. All striping will be in accordance with MUTCD and local specifications.

2.05 ADJUSTING TO GRADE OF MISCELLANEOUS ROADWAY STRUCTURES

- A. Measurement: Measurement: Measurement will be made on the basis of adjusting each structure to grade, to determine the unit or units of each type completed and accepted, in accordance with the plans and specifications and accepted by the engineer. Structure tops to be raised or lowered 2 ft. (600 mm) or less are considered "Adjust to Grade."
- B. Payment: Payment will be made on the basis of each structure adjusted to grade. The unit price bid shall include all labor, materials and equipment necessary, including, but not limited to, excavation, shoring and sheeting, dewatering, gravel bedding, castings, backfill, compaction and complete surface restoration. Payment is full compensation for adjusting to grade the structures as specified in this Specification.

2.06 GRASSING

- A. Measurement: Measurement shall be made on the basis of the completed item in accordance with the construction plans and bid items.
- B. Payment: Payment will be made in accordance with the price stated in the bid. The unit price shall include, but is not limited to, furnishing all labor, materials and equipment necessary for the satisfactory growth of grass on all disturbed areas in accordance with plans and specifications. Work shall include, but not be limited to, furnishing all materials, fertilizer, soil samples, grass seed, raking, leveling, watering,

maintenance and final surface restoration. Final payment will not occur until permanent grass is established.

2.07 PAVEMENT MARKING

- A. Measurement: Measurement shall be made on the basis of the percent complete of the lump sum bid.
- B. Payment: Payment shall be made at the lump sum stated in the bid. The price bid shall include all labor, materials, and equipment necessary to complete the task. The task shall include, but is not limited to, supplying, and installing all thermoplastic pavement markings to replace existing in accordance with construction plans, surface restoration and cleanup.

2.08 TRAFFIC CONTROL

- A. Measurement: Measurement shall be made on the basis of the percentage complete of the lump sum bid in accordance with the construction plans and bid items.
- B. Payment: Payment shall be made on the basis of the percentage complete of the lump sum price stated in the bid as determined by the project engineer. The lump sum shall include furnishing all labor, materials, and equipment necessary to complete the task. The task shall include, but is not limited to, the placing, moving, and maintenance of all signage, barricades, cones, barrels, flagging, flag men, and guide vehicles throughout the construction process to safely reroute traffic from existing traffic patterns. Traffic control shall be done in a manner to safely warn, reroute, and lead vehicles to their destination. Additional signage will be required if the engineer deems that the traffic control in place does not fully meet the required intent of the task. Changing of existing traffic patterns shall be communicated with the engineer no less than 48 hours prior to.

2.09 MOBILIZATION

- A. Payment will be made for the price as stated in the Contract once the Contractor has established his construction yard, and met the requirements established in the Contract Documents. Mobilization will be recognized complete once the Contractor has provided a construction schedule and moved his equipment and a substantial amount of material to the job site. Construction must be underway and progressing. Payment for mobilization will be limited to a maximum amount not to exceed 5% of the bid price.

END OF SECTION

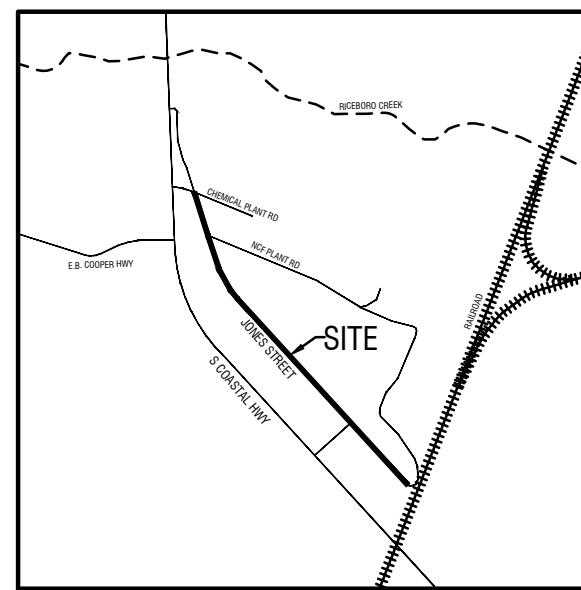

VICINITY MAP
NOT TO SCALE

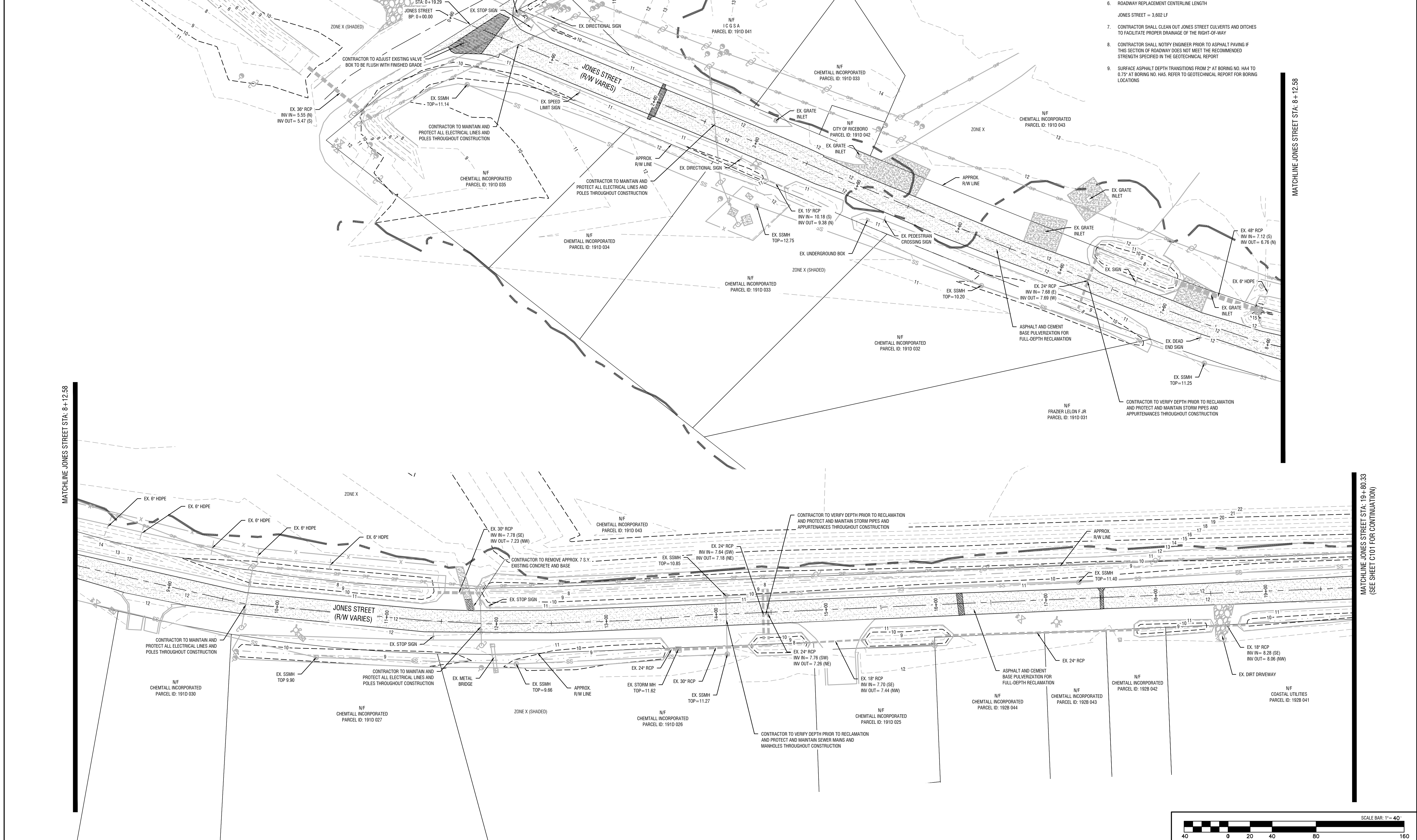

- GENERAL NOTES:**
- UTILITY AND STREET INSTALLATION TO BE IN ACCORDANCE WITH THE CITY OF RICEBORO STANDARD SPECIFICATIONS.
 - TOPOGRAPHICAL SURVEY SUPPLIED BY M.E. SACK ENGINEERING.
 - THIS PROJECT IS IN A ZONE "X" AND ZONE "X" (SHADED) (0.2%) ACCORDING TO THE LIBERTY COUNTY FLOOD MAP COMMUNITY-PANEL NUMBER 13179C032E, DATED SEPTEMBER 17, 2017.
 - SEWAGE DISPOSAL SYSTEM:
CITY OF RICEBORO
 - WATER DISTRIBUTION SYSTEM:
CITY OF RICEBORO
 - ROADWAY REPLACEMENT CENTERLINE LENGTH
JONES STREET = 3,602 LF
 - CONTRACTOR SHALL CLEAN OUT JONES STREET CULVERTS AND DITCHES TO FACILITATE PROPER DRAINAGE OF THE RIGHT-OF-WAY
 - CONTRACTOR SHALL NOTIFY ENGINEER PRIOR TO ASPHALT PAVING IF THIS SECTION OF ROADWAY DOES NOT MEET THE RECOMMENDED STRENGTH SPECIFIED IN THE GEOTECHNICAL REPORT
 - SURFACE ASPHALT DEPTH TRANSITIONS FROM 2" AT BORING NO. HA4 TO 0.75" AT BORING NO. HA5. REFER TO GEOTECHNICAL REPORT FOR BORING LOCATIONS

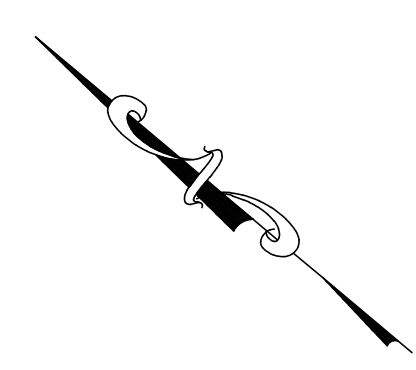

REVISIONS:

NO.	DESCRIPTION

DESIGN PROFESSIONAL:
MARCUS E. SACK
 GSWCC LEVEL II # 70248
 EXPIRES: 06/14/2026
 MARCUS@MESACK.COM

515 NORTH MAIN STREET
 P.O. BOX 649
 HINESVILLE, GA 31313
 TEL: (912) 368-5212

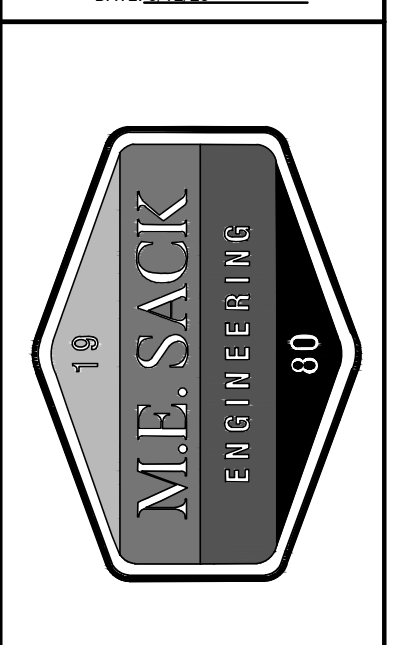
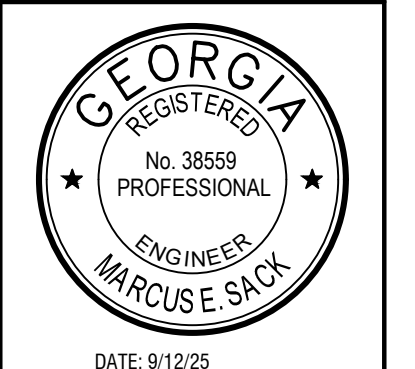

MUNICIPALITY:
CITY OF RICEBORO

COUNTY:
LIBERTY COUNTY

OWNER:
SNF HOLDING COMPANY
1 CHEMICAL PLANT RD
RICEBORO, GA 31323
(912)-884-8726

24 HOUR CONTACT:
GARY RYALS
1 CHEMICAL PLANT RD
RICEBORO, GA 31323
(912)-884-8754
MARKETING@SNFHC.COM

JONES STREET RECLAMATION

**DEMOLITION
PLAN**

C100

FILE NO: 2025-06
 PLOT DATE: September 12, 2025

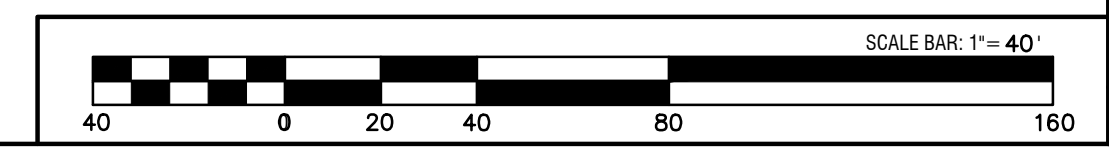

MATCHLINE JONES STREET STA: 8+12.58

MATCHLINE JONES STREET STA: 8+12.58

MATCHLINE JONES STREET STA: 19+80.33
(SEE SHEET C101 FOR CONTINUATION)

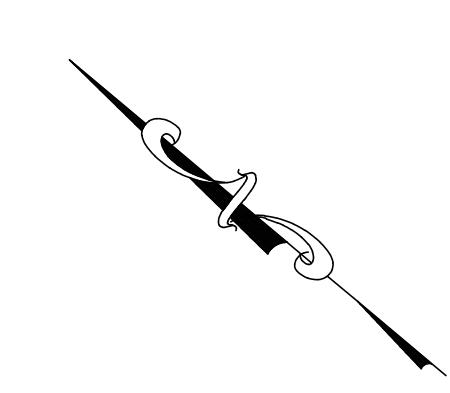
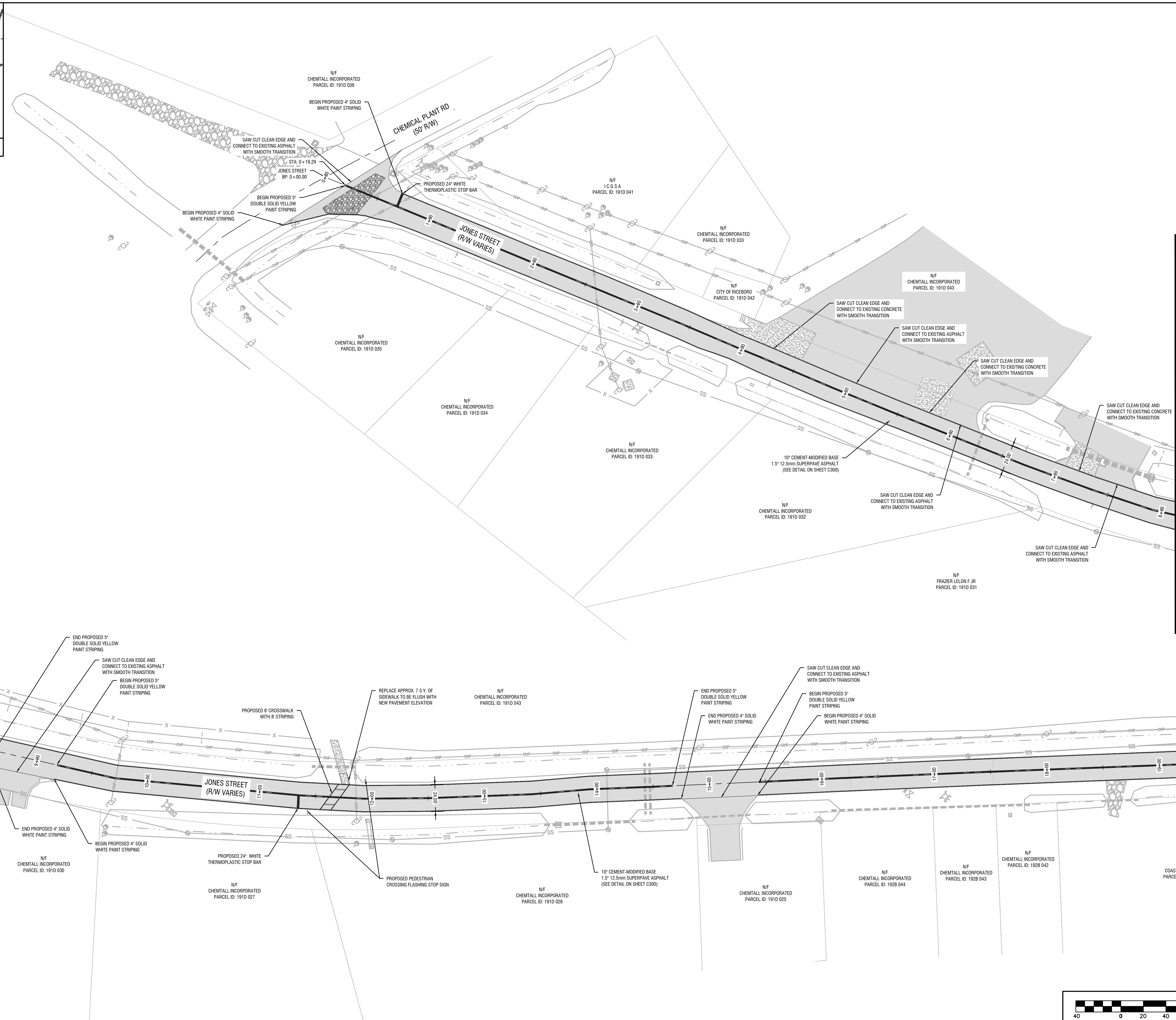
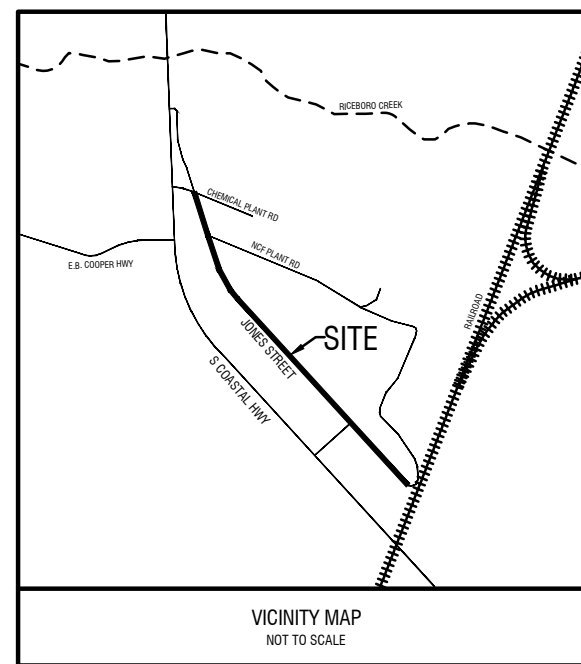

REVISIONS:

THIS DRAWING IS AN INSTRUMENT OF SERVICE AND REMAINS THE PROPERTY OF P.C. SIMMONS & ASSOCIATES, INC. AND M.E. SACK ENGINEERING. IT MAY NOT BE COPIED, ALTERED, OR REPRODUCED IN ANY MANNER WITHOUT PERMISSION ON A SIGNED AND SEALED DOCUMENT. THE INFORMATION CONTAINED HEREIN IS INTENDED FOR THE NAMED CLIENT ONLY. IN THE EVENT OF AN ELECTRONIC VERSION OF THIS DRAWING, THE USER SHALL BE RESPONSIBLE FOR DATA GENERATED, ALTERED OR STAMPS FROM THIS DRAWING. IN THE EVENT OF A DISPUTE, HARD COPIES WILL TAKE PRECEDENCE OVER ANY ELECTRONIC MEDIA.

DESIGN PROFESSIONAL:
MARCUS E. SACK
 GSWCC LEVEL II # 70248
 EXPIRES: 06/14/2026
 MARCUS@MESACK.COM

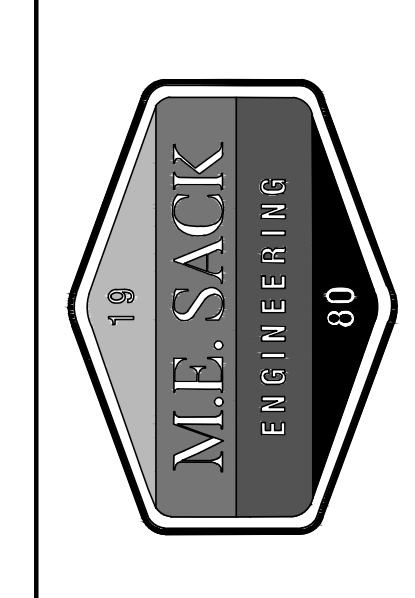
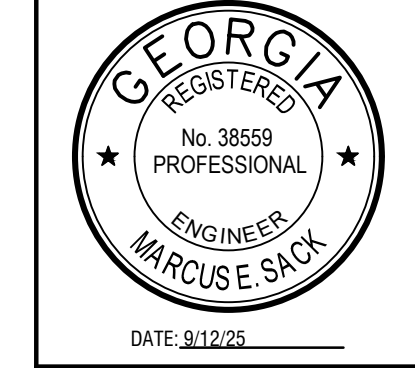

MUNICIPALITY:
 CITY OF RICEBORO

COUNTY:
 LIBERTY COUNTY

OWNER:
 SNF HOLDING COMPANY
 1 CHEMICAL PLANT RD
 RICEBORO, GA 31323
 (912)-884-8726

24 HOUR CONTACT:
 GARY RYALS
 1 CHEMICAL PLANT RD
 RICEBORO, GA 31323
 (912)-884-8754
 MARKETING@SNFHC.COM

JONES STREET RECLAMATION

SITE PLAN

C200

FILE NO: 2025-06
 PLOT DATE: September 12, 2025

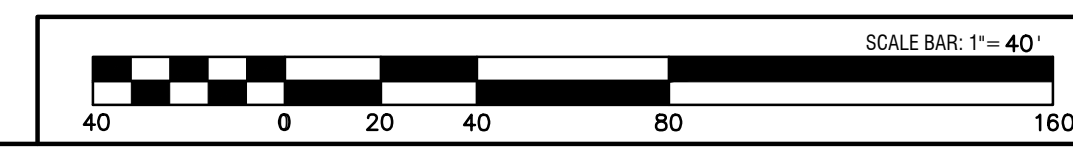

MATCHLINE JONES STREET STA: 8+12.58

MATCHLINE JONES STREET STA: 8+12.58

MATCHLINE JONES STREET STA: 19+80.33
 (SEE SHEET C201 FOR CONTINUATION)

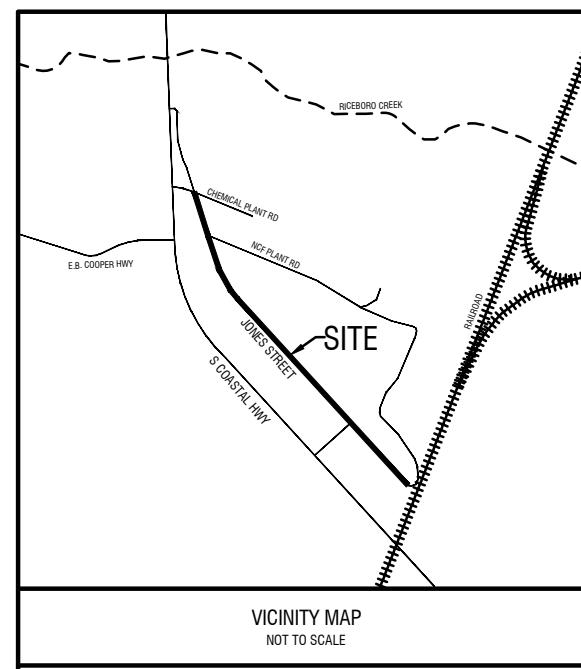

MATCHLINE JONES STREET STA: 19+80.33
(SEE SHEET C200 FOR CONTINUATION)

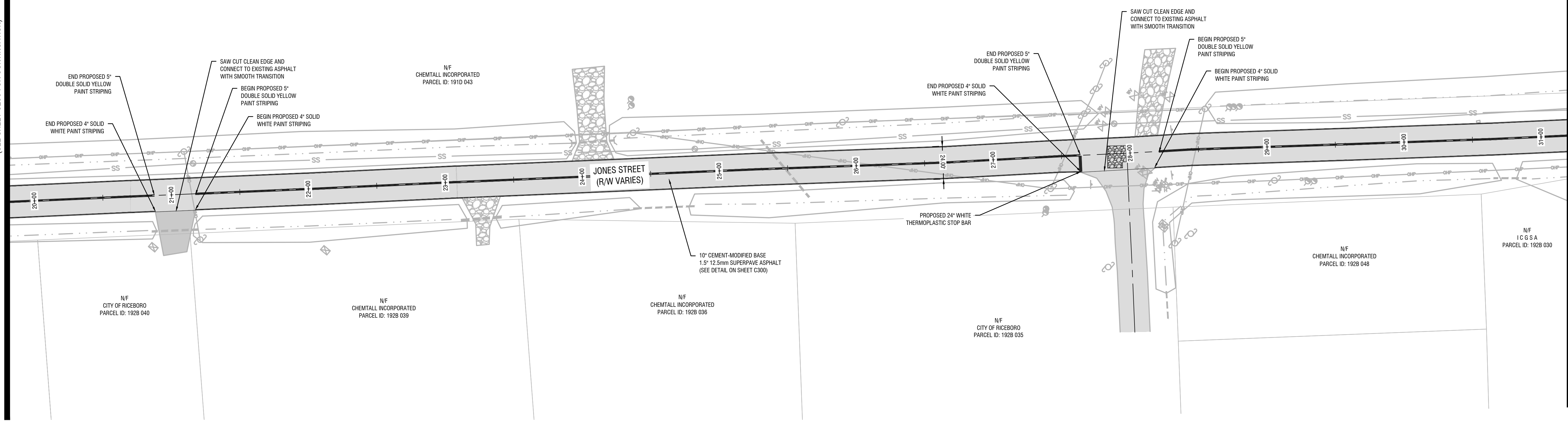

MATCHLINE JONES STREET STA: 31+20.88

MATCHLINE JONES STREET STA: 31+20.88

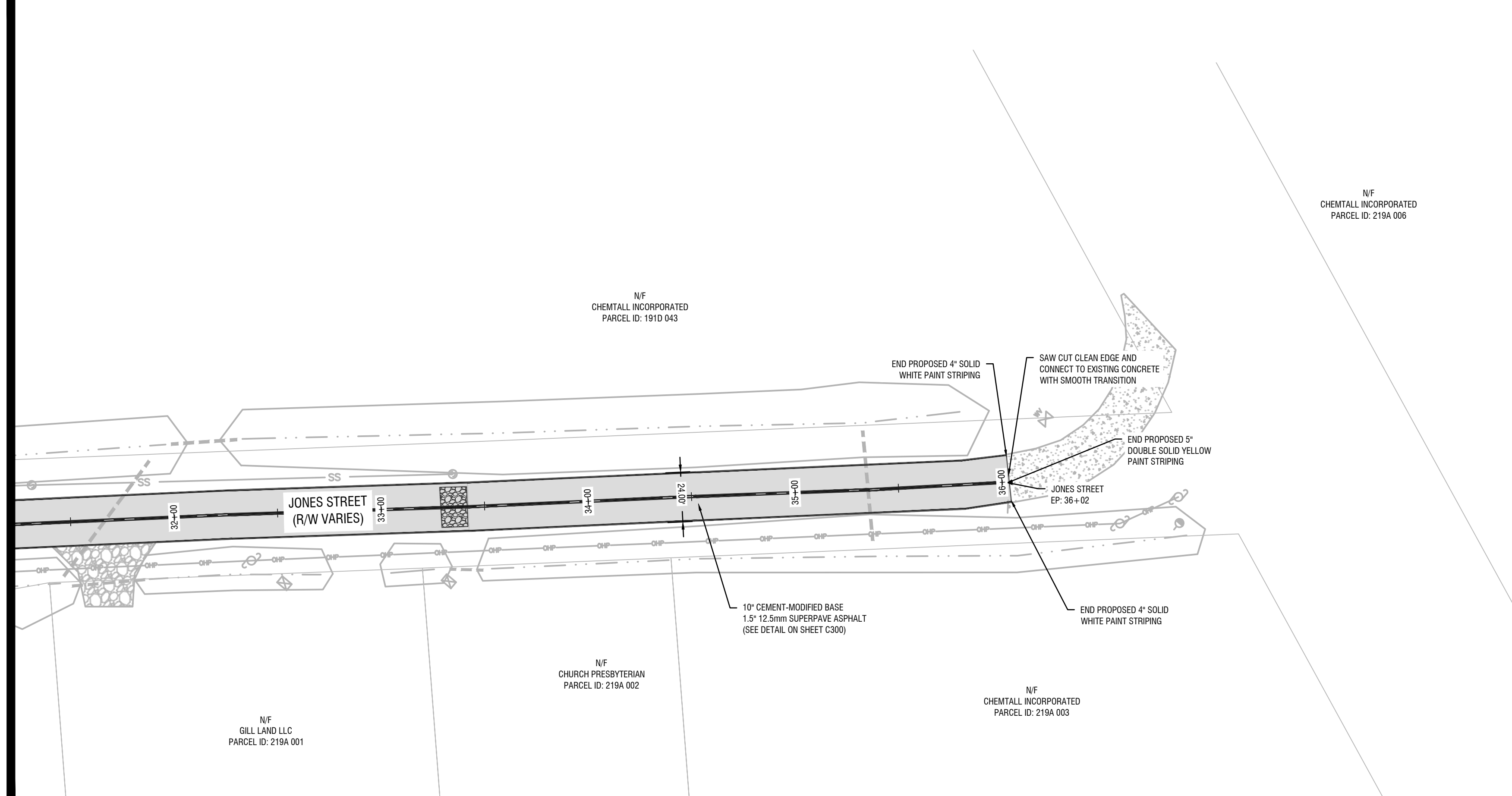

REVISIONS:

NO.	DATE	DESCRIPTION

DESIGN PROFESSIONAL:
MARCUS E. SACK
 GSWCC LEVEL II # 70248
 EXPIRES: 06/14/2026
 MARCUS@MESACK.COM
 515 NORTH MAIN STREET
 P.O. BOX 646
 HINESVILLE, GA 31313
 TEL: (912) 368-5212



MUNICIPALITY:
CITY OF RICEBORO

COUNTY:
LIBERTY COUNTY

OWNER:
SNF HOLDING COMPANY
1 CHEMICAL PLANT RD
RICEBORO, GA 31323
(912)-884-8726

24 HOUR CONTACT:
GARY RYALS
1 CHEMICAL PLANT RD
RICEBORO, GA 31323
(912)-884-8754
MARKETING@SNFHC.COM

JONES STREET RECLAMATION

SITE PLAN

C201

FILE NO: 2025-06
 PLOT DATE: September 12, 2025

