



515 N. Main Street | Hinesville, GA 31313
PO Box 649 | Hinesville, GA 31310
912.368.5212
www.mesack.com
ME Sack Engineering
@mesackengineering
mesack

ADDENDUM No. THREE

Date: September 19, 2025
Project: Jones Street Reclamation, MES No. 2025-06
Engineer: M.E. Sack Engineering *MS*
Hinesville, Georgia

The original plans, specifications, and bid documents are amended to include the following:

Bid Form:

- Replace the previous Bid Form with the enclosed of the same. Note that bid item quantities for both asphalt paving items and both alternatives were revised and a bid item was added for Structure Removal and Replacement.

Specifications:

- Replace the previous Section 01150 Measurement and Payment with the enclosed of the same. Note that Structure Removal and Replacement has been added.

Plans:

- Replace the previous Sheets C200-C201 with the enclosed of the same. Note that revisions were made to remove dimension labels and match edge of pavement lines to existing.

We offer the following clarifications for questions received:

- 1) *I noticed on site today that the gates on Jones Street are 20 feet apart from post to post. The new roadway is proposed to be 24 feet wide. Will these gates be removed before construction or will we need to remove and reset these?*
 - The proposed pavement and base have been updated to match the existing road widths, instead of the proposed 24 foot width. The gates will need to be removed to perform the work and replaced afterwards; therefore, a new "Structure Remove/Replace" bid item has been added.
- 2) *Also, there is over 1,000/Sy more of proposed paving than there is existing due to the new proposed width. Is it the intention to mix the existing material outside the existing pavement or will removal/widening be required. If so, please clarify the method required.*
 - The quantities of asphalt paving have been updated to match the area of the full depth roadway reclamation. Therefore, the existing material can be mixed and reused without any extra removal or widening required.

-END-

B. BID FORM

Bid Item	Quantity	Units	Description	Unit Price	Cost
1	1	LS	Shoulder Scraping & Grubbing	-	\$
2	8,475	SY	Full-Depth Roadway Reclamation	\$	\$
3	350	TN	Recycling Agent (Stabilization) for Base Course (Cement)	\$	\$
4	8,475	SY	1.5" 12.5mm Asphalt Paving	\$	\$
5	8,475	SY	3" 19mm Asphalt Paving	\$	\$
6	1	LS	Feather Asphalt Paving @ Intersections	-	\$
7	1	LS	Structure Remove/Replace	-	\$
8	7	SY	Concrete Driveway and Sidewalk Remove/Replace	\$	\$
9	1	LS	Shoulder Fill & Grading	-	\$
10	1	LS	Shoulder Grassing	-	\$
11	35	LF	24" Thermoplastic Stop Bar	\$	\$
12	7,005	LF	4" Thermoplastic Solid White Line Striping	\$	\$
13	6,720	LF	5" Thermoplastic Double Solid Yellow Line Striping	\$	\$
14	1	LS	Traffic Control	-	\$
15	1	LS	Mobilization (5% Max)	-	\$
SUBTOTAL					\$
Alternative A					
16.A	8,475	SY	4" Granular Roadway Base	\$	\$
Alternative B					
16.B	8,475	SY	1.5" Open Graded Crack Relief Interlayer	\$	\$
TOTAL BID					\$

**SECTION 01150
MEASUREMENT AND PAYMENT**

PART 1 - GENERAL

1.01 QUANTITIES

- A. Quantities: Quantities listed in the Proposal are approximate only and are intended to serve as a guide in comparing bids, and may be increased or decreased without invalidating the unit price bid.
- B. Payment: Contractor shall be paid for actual in place quantities as determined by the Engineer field measurements.
- C. Discrepancies: In case of discrepancies between the figures shown in the unit prices and totals, the unit prices shall apply and the totals shall be corrected to agree with the unit price.

PART 2 - MEASUREMENT AND PAYMENT

2.01 SHOULDER SCRAPING & GRUBBING

- A. Measurement: Measurement shall be made on the basis of the percentage complete of the task in accordance with the plans and specifications.
- B. Payment: Payment will be made at the lump sum stated in the bid. The price bid shall include furnishing all labor, materials and equipment necessary to complete this item. Work shall include, but is not limited to, removal of all trees, shrubs and undergrowth that presently exist, preventing the construction of this project. All material removed including vegetation, roots and organic mat shall be removed from the site and disposed of at a permitted site. The contractor shall take special care not to disturb the roots of trees that are marked to remain. Trees to be saved shall be marked and approved by the engineer prior. Trees to be saved shall have the appropriate tree protection installed.

2.02 FULL-DEPTH ROADWAY RECLAMATION

- A. Measurement: Measurement shall be made on the basis of each square yard of pavement to undergo full-depth reclamation in accordance with the plans, specifications, and bid documents.
- B. Payment: Payment will be made on the basis of the unit price stated in the bid. The unit price shall include furnishing all labor, materials, and equipment necessary to complete this item of work. Work shall include, but not be limited to, pulverization of roadway and base material, addition of chemical stabilizers, compaction of new base mix, and curing of mix.

2.03 GRANULAR ROADWAY BASE

- A. Measurement: Measurement shall be made on the basis of the number of square yards of graded aggregate base applied to the roadway at the specified thickness as

shown on the construction plans. Irregular areas such as turnouts, filler strips and intersections will be measured to the closest square yard. Prior to installation of the asphalt all areas will be checked for proper thickness.

- B. Payment: Payment will be made on the basis of the number of square yards of granite crusher run (graded aggregated) base at the specified thickness applied to the roadway at the unit price stated in the bid. The price shall include all labor, equipment and material to complete the task. Work shall include, but not be limited to, the furnishing, hauling, placing and compaction of the crusher run base in order to bring the base to the lines, grades, and cross sections shown on the construction plans or established by the Engineer.

2.04 ASPHALT PAVING

- A. Measurement: Measurement will be made on the basis of each ton of asphalt in place, in accordance with the construction plans and accepted by the Engineer. Actual weight will be determined by weighing on a certified motor truck scale and presenting a notarized copy of the recorded weight to the Engineer.
- B. Payment: Payment will be made on the basis of the number of tons of asphalt in place in accordance with the unit price bid as stated in the contract. Work shall include, but is not limited to, the furnishing, hauling, placing and compaction of the asphalt in order to bring the pavement to the lines, grades and cross sections as designated on the construction plans and as determined by the Engineer. The unit price bid shall also include surface cleaning, prime, tack and pavement and handicap striping. All striping will be in accordance with MUTCD and local specifications.

2.05 STRUCTURE REMOVAL & REPLACEMENT

- A. Measurement: Measurement shall be made on the basis of the lump sum of the items to be removed or relocated.
- B. Payment: Payment will be made on the basis of the lump sum bid and the completion of the project. The price shall include all labor, materials and equipment necessary to complete the task. The task shall include, but is not limited to, the removal, storage, placement, fastening, and reinstallation of mailboxes, signage, posts, fencing, gates, fence stands, latches, locks, and other structures that may impede construction, or appurtenances necessary for the completion of these tasks. The task includes the provision of temporary mailboxes throughout the construction process, and the replacement of damaged mailboxes or signs and posts, cleanup, and surface restoration.

2.06 ADJUSTING TO GRADE OF MISCELLANEOUS ROADWAY STRUCTURES

- A. Measurement: Measurement: Measurement will be made on the basis of adjusting each structure to grade, to determine the unit or units of each type completed and accepted, in accordance with the plans and specifications and accepted by the engineer. Structure tops to be raised or lowered 2 ft. (600 mm) or less are considered "Adjust to Grade."

- B. Payment: Payment will be made on the basis of each structure adjusted to grade. The unit price bid shall include all labor, materials and equipment necessary, including, but not limited to, excavation, shoring and sheeting, dewatering, gravel bedding, castings, backfill, compaction and complete surface restoration. Payment is full compensation for adjusting to grade the structures as specified in this Specification.

2.07 GRASSING

- A. Measurement: Measurement shall be made on the basis of the completed item in accordance with the construction plans and bid items.
- B. Payment: Payment will be made in accordance with the price stated in the bid. The unit price shall include, but is not limited to, furnishing all labor, materials and equipment necessary for the satisfactory growth of grass on all disturbed areas in accordance with plans and specifications. Work shall include, but not be limited to, furnishing all materials, fertilizer, soil samples, grass seed, raking, leveling, watering, maintenance and final surface restoration. Final payment will not occur until permanent grass is established.

2.08 PAVEMENT MARKING

- A. Measurement: Measurement shall be made on the basis of the percent complete of the lump sum bid.
- B. Payment: Payment shall be made at the lump sum stated in the bid. The price bid shall include all labor, materials, and equipment necessary to complete the task. The task shall include, but is not limited to, supplying, and installing all thermoplastic pavement markings to replace existing in accordance with construction plans, surface restoration and cleanup.

2.09 TRAFFIC CONTROL

- A. Measurement: Measurement shall be made on the basis of the percentage complete of the lump sum bid in accordance with the construction plans and bid items.
- B. Payment: Payment shall be made on the basis of the percentage complete of the lump sum price stated in the bid as determined by the project engineer. The lump sum shall include furnishing all labor, materials, and equipment necessary to complete the task. The task shall include, but is not limited to, the placing, moving, and maintenance of all signage, barricades, cones, barrels, flagging, flag men, and guide vehicles throughout the construction process to safely reroute traffic from existing traffic patterns. Traffic control shall be done in a manner to safely warn, reroute, and lead vehicles to their destination. Additional signage will be required if the engineer deems that the traffic control in place does not fully meet the required intent of the task.

Changing of existing traffic patterns shall be communicated with the engineer no less than 48 hours prior to.

2.10 MOBILIZATION

- A. Payment will be made for the price as stated in the Contract once the Contractor has established his construction yard, and met the requirements established in the Contract Documents. Mobilization will be recognized complete once the Contractor has provided a construction schedule and moved his equipment and a substantial amount of material to the job site. Construction must be underway and progressing. Payment for mobilization will be limited to a maximum amount not to exceed 5% of the bid price.

END OF SECTION

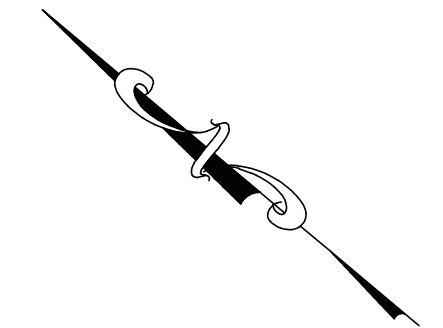
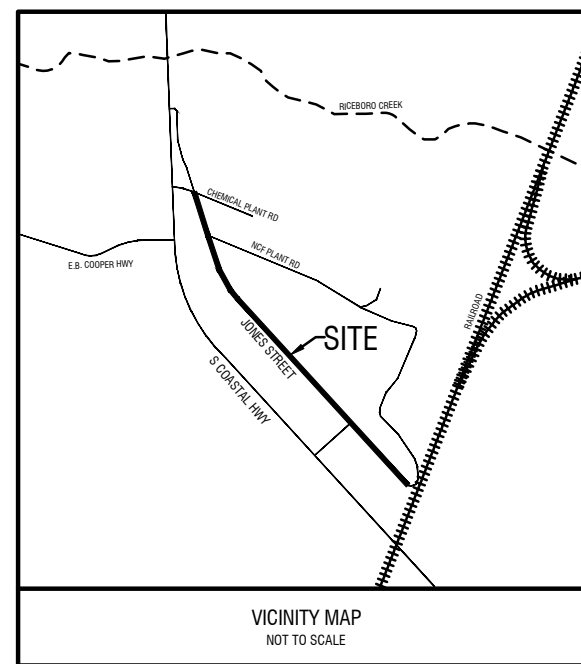

REVISIONS:

NO.	DATE	DESCRIPTION

DESIGN PROFESSIONAL:
MARCUS E. SACK
 GSWCC LEVEL II # 70248
 EXPIRES: 06/14/2026
 MARCUS@MESACK.COM

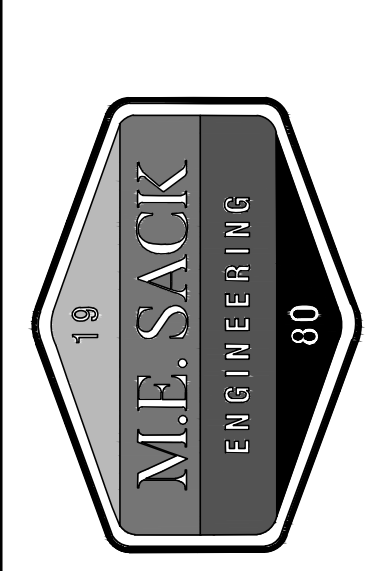

MUNICIPALITY:
CITY OF RICEBORO

COUNTY:
LIBERTY COUNTY

OWNER:
SNF HOLDING COMPANY
1 CHEMICAL PLANT RD
RICEBORO, GA 31323
(912)-884-8726

24 HOUR CONTACT:
GARY RYALS
1 CHEMICAL PLANT RD
RICEBORO, GA 31323
(912)-884-8754
MARKETING@SNFHC.COM

JONES STREET RECLAMATION

SITE PLAN

C200

FILE NO: 2025-06
 PLOT DATE: September 19, 2025

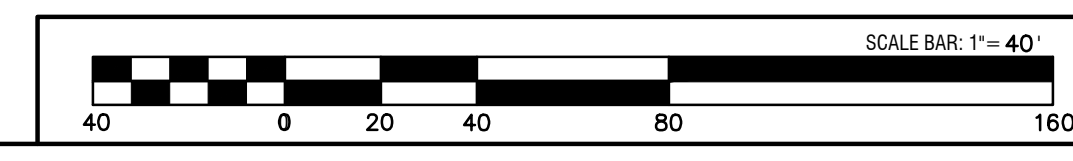
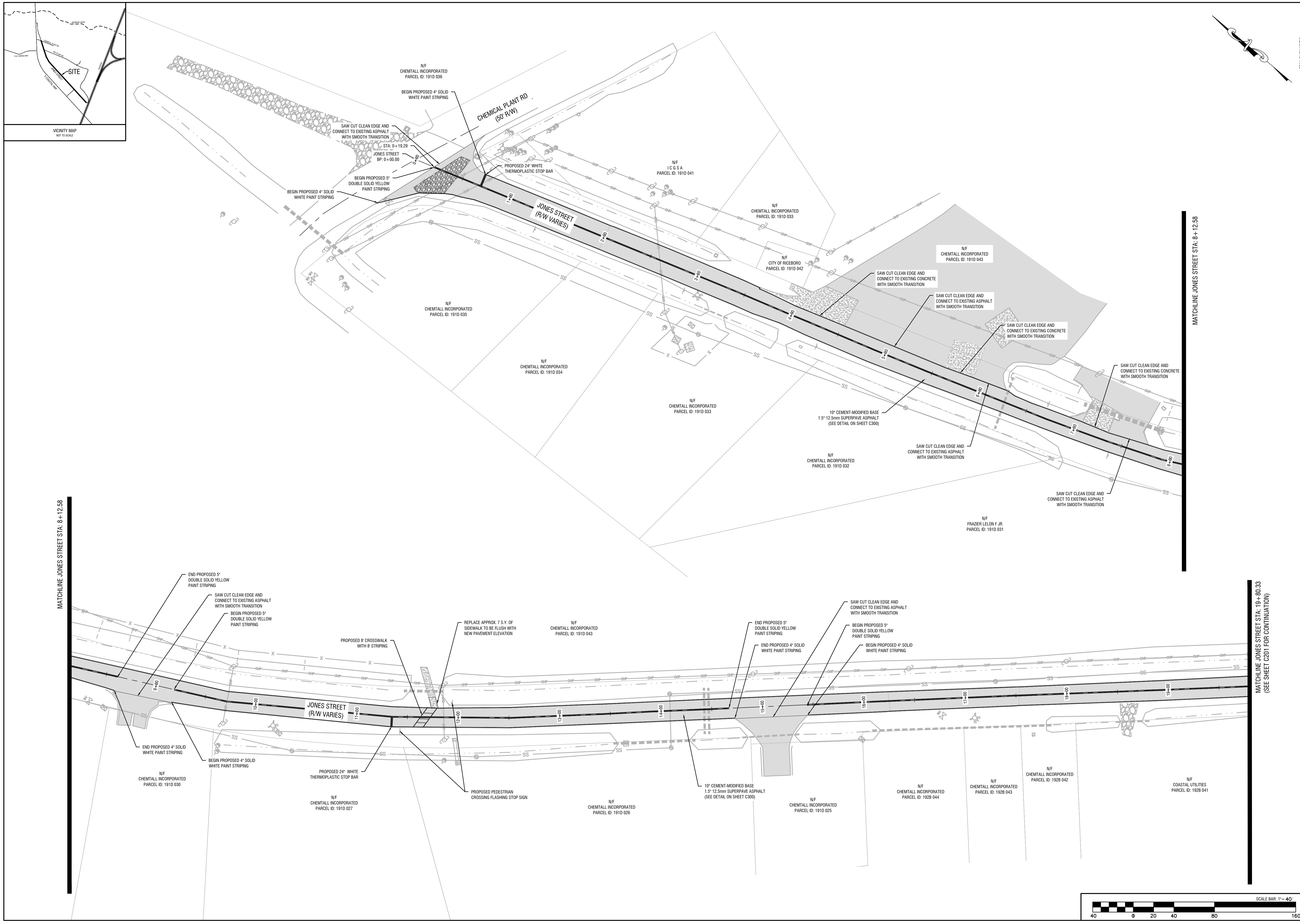

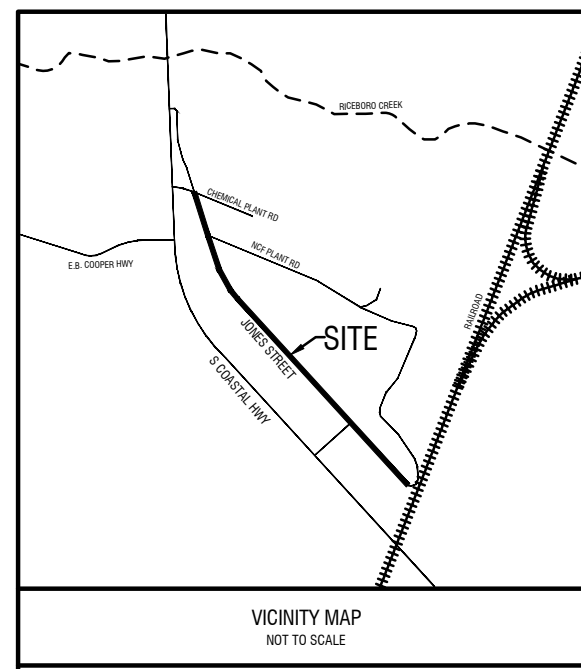

MATCHLINE JONES STREET STA: 19+80.33
(SEE SHEET C200 FOR CONTINUATION)

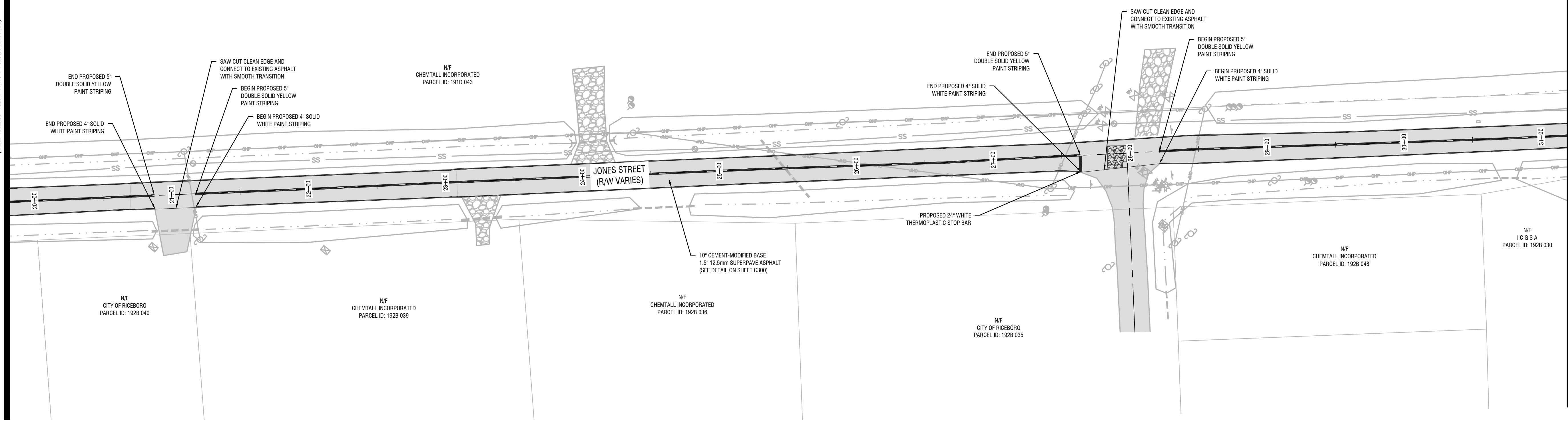

MATCHLINE JONES STREET STA: 31+20.88

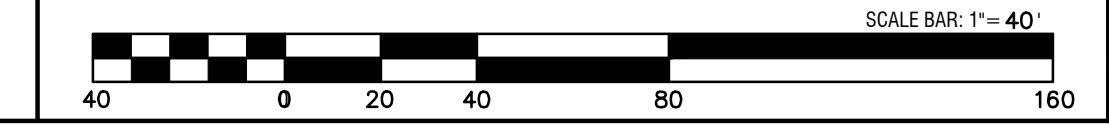
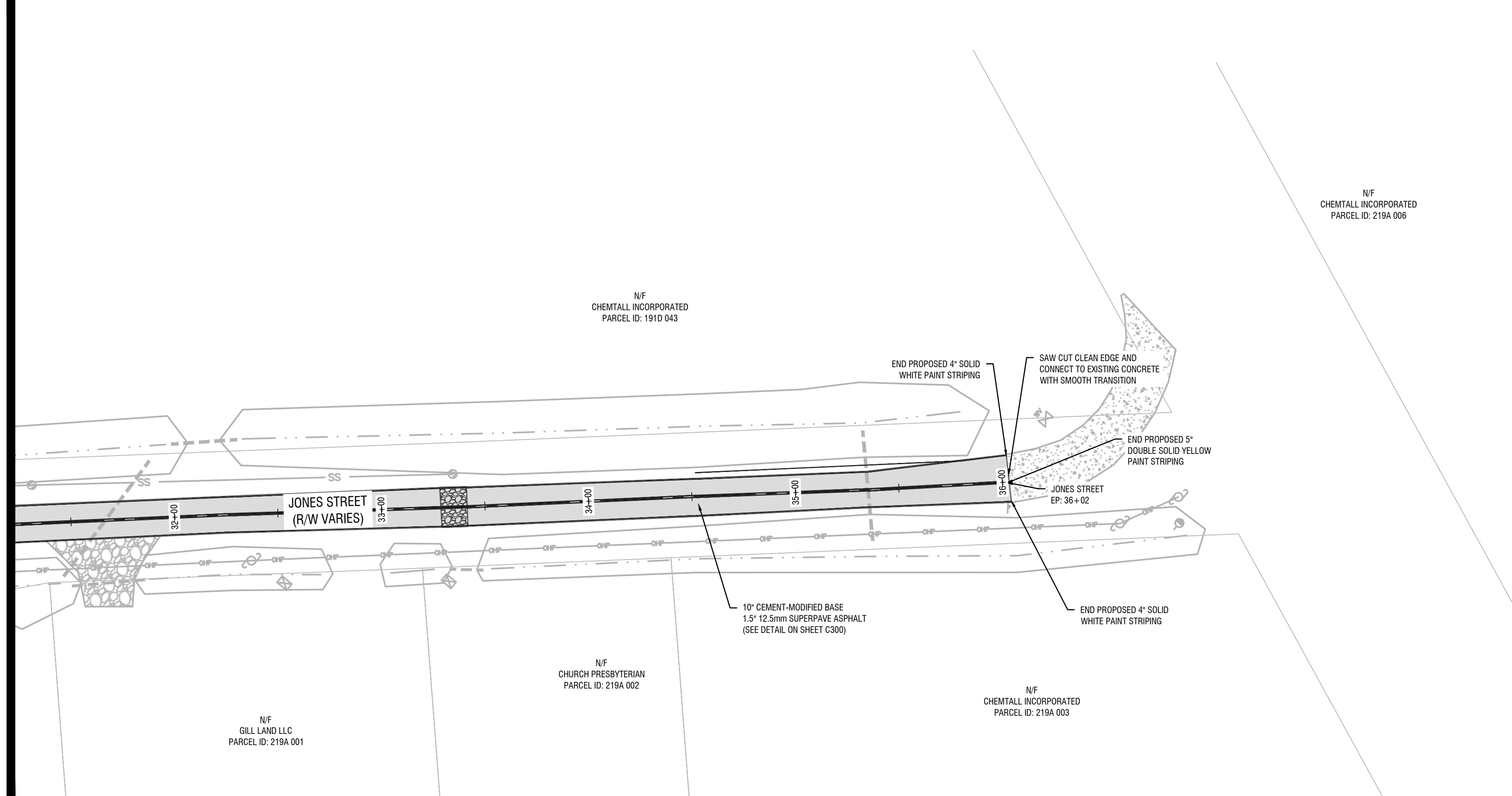

MATCHLINE JONES STREET STA: 31+20.88

REVISIONS:

NO.	DATE	DESCRIPTION

DESIGN PROFESSIONAL:
MARCUS E. SACK
 GSWCC LEVEL II # 70248
 EXPIRES: 06/14/2026
 MARCUS@MESACK.COM
 515 NORTH MAIN STREET
 P.O. BOX 646
 HINESVILLE, GA 31313
 TEL: (912) 368-5212

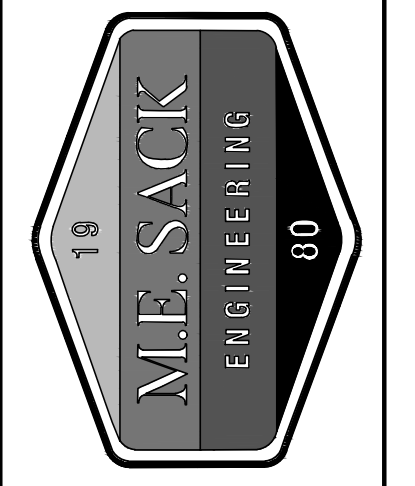

MUNICIPALITY:
CITY OF RICEBORO

COUNTY:
LIBERTY COUNTY

OWNER:
SNF HOLDING COMPANY
1 CHEMICAL PLANT RD
RICEBORO, GA 31323
(912)-884-8726

24 HOUR CONTACT:
GARY RYALS
1 CHEMICAL PLANT RD
RICEBORO, GA 31323
(912)-884-8754
MARKETING@SNFHC.COM

JONES STREET RECLAMATION

SITE PLAN

C201

FILE NO: 2025-06
 PLOT DATE: September 19, 2025