

515 N. Main Street | Hinesville, GA 31313
PO Box 649 | Hinesville, GA 31310
912.368.5212
www.mesack.com
ME Sack Engineering
@mesackengineering
mesack

ADDENDUM No. TWO

Date: July 10, 2025

Project: 1210 Drayton Parking Improvements, MES No. 2024-45

Engineer: M.E. Sack Engineering
Hinesville, Georgia

The original plans, specifications, and bid documents are amended to include the following:

Plan Set:

- Include the two (2) enclosed A1 Architectural Sheets. Note that these sheets provide architectural elevations for the low wall and fence/wall combination.

-END-

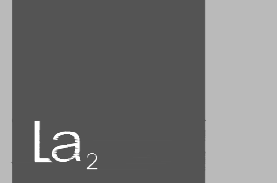

LYNCH
a s s o c i a t e s
a r c h i t e c t s

200 East 31st Street
Savannah, Georgia 31401
T 912.349.5116
F 912.349.5119
www.lyncharch.com

1210 DRAYTON STREET PARKING LOT

Inman Park Properties
Savannah, GA 31401

Revisions

No	Date	Description

WALL ELEVATIONS AND DETAILS

Scale AS NOTED
Date NOVEMBER 4, 2018
Project No. 2419.00
Drawing No.

A1

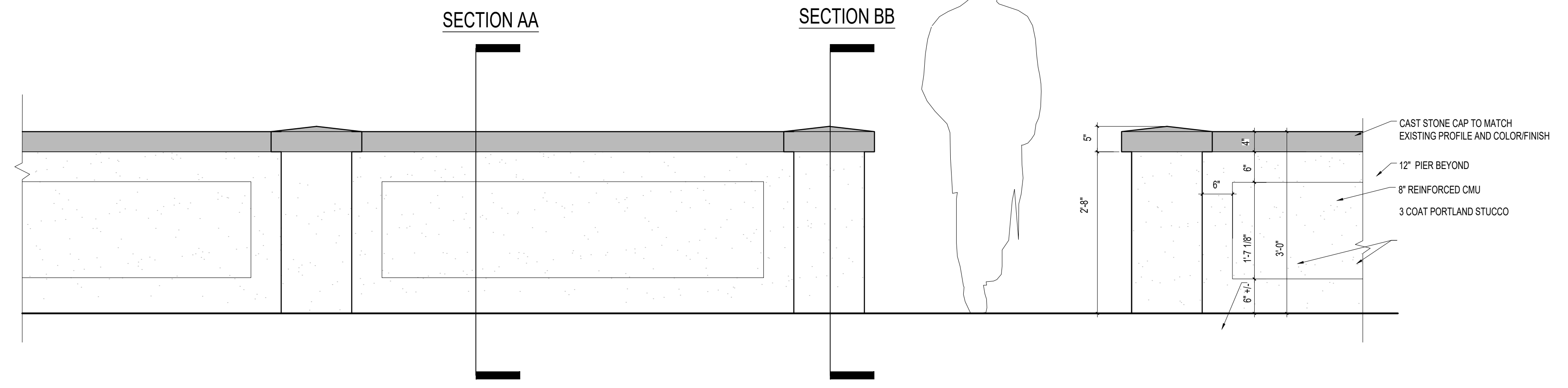

ENLARGED ELEVATION
3/4" = 1'-0"

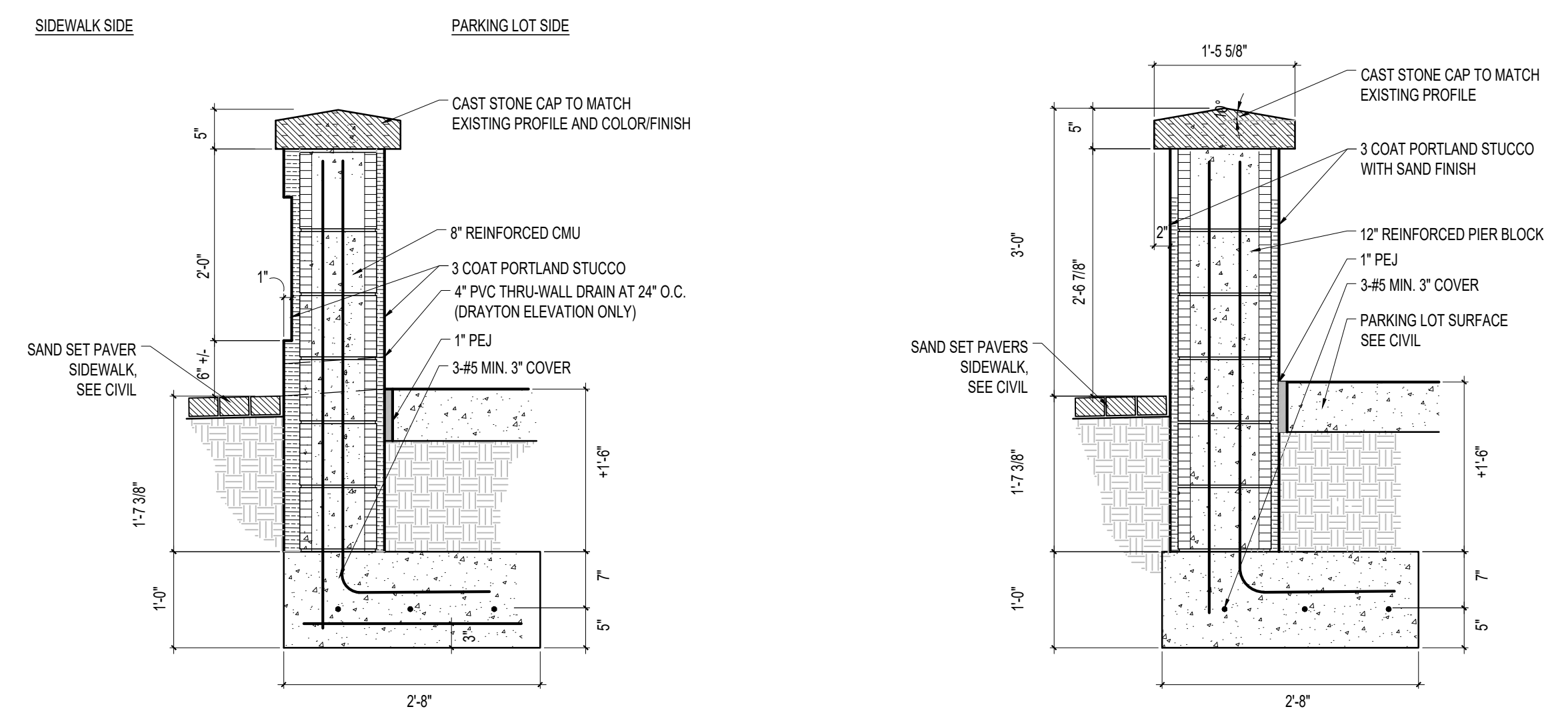

SECTION AA

SECTION BB

TYPICAL WALL SECTIONS
3/4" = 1'-0"

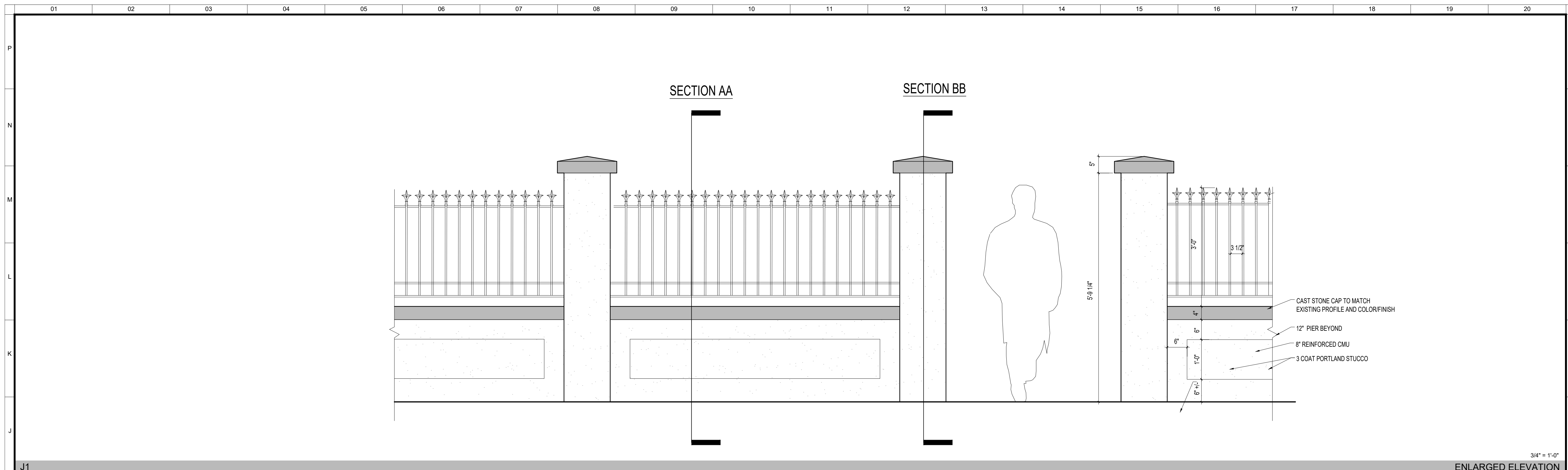

J1

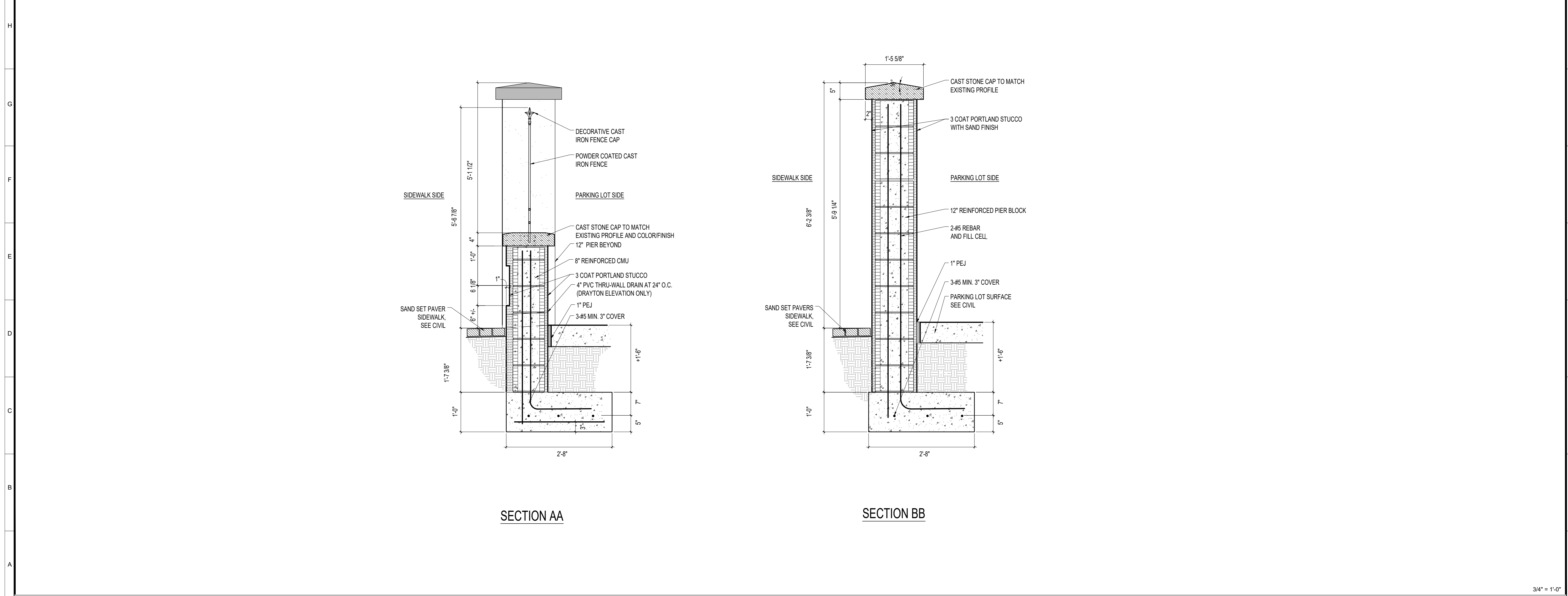

A1



LYNCH
associates
architects

200 East 31st Street
Savannah, Georgia 31401
T 912.349.5116
F 912.349.5119

www.lyncharch.com

**1210 DRAYTON
STREET PARKING
LOT**

Inman Park Properties
Savannah, GA 31401

Revisions

No	Date	Description

**WALL ELEVATIONS
AND DETAILS**

Scale AS NOTED
Date NOVEMBER 4, 2018
Project No. 2419.00
Drawing No.

A1