



515 N. Main Street | Hinesville, GA 31313
PO Box 649 | Hinesville, GA 31310
912.368.5212
www.mesack.com
ME Sack Engineering
@mesackengineering
mesack

ADDENDUM No. TWO

Date: January 28, 2025
Project: Sewer and Drainage CDBG, MES No. 2022-15
Engineer: M.E. Sack Engineering
Hinesville, Georgia

The original plans, specifications, and bid documents are amended to include the following:

Bid Document:

- Replace the previous Bid Form with the enclosed of the same. Note that Power Pole Relocation and Electric Utility Overhead Line Relocation have been removed.

Technical Specifications:

- Replace the previous Section **01150** Measurement and Payment with the enclosed of the same. Note that measurement and payment for the Power Pole Relocation and Electric Utility Overhead Line Relocation has been removed.

Plans:

- Replace the previous sheets **C101**, **C102**, and **C200** with the enclosed of the same. Note that the Power Pole Relocation notes were revised.
 - Modification notes:
 - It is stated that the City shall work with the local power company regarding the Power Pole and overhead lines relocation and the Contractor shall only coordinate Power Pole Relocation plans with the City and local power company.

The following clarification is offered for questions asked:

1. *Regarding the Power Pole Relocation: Do you have a power company contact? Can an allowance or contingency be provided?*
 - The City will facilitate coordination with the power company to get the pole relocated. Contractor will not be responsible for power pole and overhead line relocations beyond coordination with the City of Pembroke and the power company. See notes on sheets **C101**, **C102**, and **C200** for relevant changes on the plan set.

-END-

B. BID FORM

Bid Item	Quantity	Units	Description	Unit Price	Cost
A. DRAINAGE IMPROVEMENTS					
1	1	LS	Clearing & Grubbing	-	\$
2	1	LS	Fill & Grading	-	\$
3	1	LS	Structure Relocation	-	\$
4	1	LS	Traffic Control	-	\$
5	1	LS	Erosion Control	-	\$
6	1	LS	Right-of-Way Grassing	-	\$
7	1	LS	Demolition	-	\$
8	6,871	SY	Asphalt Pavement Removal	\$	\$
9	6,871	SY	Aggregate Base Removal	\$	\$
10	4,654	LF	Rolled 24" Concrete Curb & Gutter	\$	\$
11	6,937	SY	1.5" 9.5mm SuperPave	\$	\$
12	6,937	SY	6" Graded Aggregate Base	\$	\$
13	1	LS	Feather Asphalt Paving @ Intersection	-	\$
14	148	SY	4" Concrete Apron w/Smooth Rock Transition	\$	\$
15	370	SY	Gravel Driveway Replacement	\$	\$
16	4	EA	Speed Bump Removal and Reinstallation	\$	\$
17	22	LF	24" Paint & Bead Stop Bar	\$	\$
18	2,010	LF	4" Paint & Bead Double Solid Yellow Line Striping	\$	\$
19	53	LF	4" Paint & Bead Double Dashed Yellow Line Striping	\$	\$
20	177	LF	Culvert Pipe Removal	\$	\$
21	9	EA	Precast Rolled Curb Inlet Structures	\$	\$
22	4	EA	Grated Inlets	\$	\$
23	2	EA	Junction Box	\$	\$
24	1	EA	Headwall – L Shaped	\$	\$
25	150	LF	French Underdrain - 6"	\$	\$

B. BID FORM continued

Bid Item	Quantity	Units	Description	Unit Price	Cost
A. DRAINAGE IMPROVEMENTS continued					
26	1	EA	15" Flared End Section	\$	\$
27	1	EA	12" Flared End Section	\$	\$
28	617	LF	18" HDPE	\$	\$
29	79	LF	15" HDPE	\$	\$
30	204	LF	12" HDPE	\$	\$
B. SEWER IMPROVEMENTS					
31	1	LS	Connection to Existing Sewer System	-	\$
32	2,234	LF	8" Sanitary Sewer Line	\$	\$
33	8	EA	Manhole	\$	\$
34	1	LS	Tie into Existing Wet Well	-	\$
35	21	EA	Reconnect Sanitary Sewer Service Laterals to New Sewer Line	\$	\$
36	2	EA	Sanitary Sewer Laterals and Extension to House Service Connection	\$	\$
37	1,484	LF	Cut, Fill, & Remove Existing Sewer Line	\$	\$
38	2	EA	Demolish & Remove Existing Sewer Manhole	\$	\$
39	612	LF	Fill and Abandon Sewer Line	\$	\$
40	2	EA	Abandon Private Pump Stations	\$	\$
41	75	LF	Cut, Fill, & Remove Water Line	\$	\$
42	70	LF	8" Water Line Relocation	\$	\$
43	1	EA	Gate Valve	\$	\$
44	1	TN	Fittings	\$	\$
45	2	EA	Connect to Existing 8" Water Line	\$	\$
46	1	LS	Mobilization (5% Max)	-	\$
TOTAL BID					\$

**SECTION 01150
MEASUREMENT AND PAYMENT**

PART 1 - GENERAL

1.01 QUANTITIES

- A. Quantities: Quantities listed in the Proposal are approximate only and are intended to serve as a guide in comparing bids, and may be increased or decreased without invalidating the unit price bid.
- B. Payment: Contractor shall be paid for actual in place quantities as determined by the Engineer field measurements.
- C. Discrepancies: In case of discrepancies between the figures shown in the unit prices and totals, the unit prices shall apply and the totals shall be corrected to agree with the unit price.

PART 2 - MEASUREMENT AND PAYMENT

2.01 CLEARING & GRUBBING

- A. Measurement: Measurement shall be made on the basis of the percentage completed of the task in accordance with the plans and specifications.
- B. Payment: Payment will be made at the lump sum stated in the bid. The price bid shall include furnishing all labor, materials, and equipment necessary to complete this item. Work shall include, but is not limited to, the removal of all trees, shrubs, and undergrowth that presently exist, preventing the construction of this project. All material removed, including vegetation, roots, and organic mat, shall be removed from the site and disposed of at a permitted site. The contractor shall take special care not to disturb the roots of trees that are marked to remain. Trees to be saved shall be marked and approved by the engineer prior. Trees to be saved shall have the appropriate tree protection installed.

2.02 GRADING

- A. Measurement: Measurement will be made on the basis of the percent completion of the item of work. All cut and fill quantities are based on the difference between initial topographic data and proposed contours shown on the plans.
- B. Payment: Payment will be made at the price bid for each item. Work shall include all equipment, labor, and material to complete each task. This item will include but is not limited to, excavation, material transportation and placement, grading to the lines and grades shown on the plans, compaction, and stabilization.

2.03 STRUCTURE RELOCATION

- A. Measurement: Measurement shall be made on the basis of the lump sum of the items to be removed or relocated in accordance with the plans, specifications, and bid documents.
- B. Payment: Payment will be made on the basis of the lump sum bid and the completion of the project. Partial payments will not be made. The project's completion will be determined by the engineer. Work shall include but is not limited to, relocating existing structures to include mailboxes, signage, posts, residential landscaping, and other structures that may impede construction, and includes the provision of temporary mailboxes throughout the construction process, and the replacement of damaged mailboxes throughout the construction process, and the replacement of damaged mailboxes or signs and posts, cleanup, and surface restoration.

2.04 TRAFFIC CONTROL

- A. Measurement: Measurement shall be made on the basis of the percentage complete of the lump sum bid in accordance with the construction plans and bid items.
- B. Payment: Payment shall be made on the basis of the percentage complete of the lump sum price stated in the bid as determined by the project engineer. The lump sum shall include furnishing all labor, materials, and equipment necessary to complete the task. The task shall include, but is not limited to, the placing, moving, and maintenance of all signage, barricades, cones, barrels, flagging, flag men, and guide vehicles throughout the construction process to safely reroute traffic from existing traffic patterns. Traffic control shall be done in a manner to safely warn, reroute, and lead vehicles to their destination while ensuring the access for local traffic to residents which will ensure they can reach their homes. Additional signage will be required if the engineer deems that the traffic control in place does not fully meet the required intent of the task. Changing the existing traffic patterns shall be communicated with the engineer no less than 48 hours prior to.

2.05 EROSION CONTROL AND GRASSING

- A. Measurement: Measurement will be made on the basis of the completed item of work. All silt fence will be measured by the linear foot of the silt fence properly installed and trenched in.
- B. Payment: Payment will be made on the basis of the completed item of work. The lump sum price shall include all equipment, material, and labor to complete the installation. This item will include but is not limited to trenching, grading, furnishing, and installing silt fence; temporary and final stabilization; maintaining erosion and sediment control structures and facilities, and establishing a final stand of cover in accordance with the plans and specifications. Retainage on final grassing will be based on the engineer's

estimate of the cost to complete the task, which may not be reflected in the contractor's bid price.

2.06 DEMOLITION

- A. Measurement: Measurement shall be made on the basis of the percentage of completed items in accordance with the plans, specifications, and bid documents.
- B. Payment: Payment will be made on the basis of the completed item of work. The lump sum price shall include furnishing all labor, materials, and equipment necessary to complete this item of work. Work shall include, but is not limited to, removal of any storm pipe, drainage structures, rip rap, trees, or other material that exist and will not be used as part of this project, excavation, disposal at an approved site, backfill, compaction and surface restoration.

2.07 ASPHALT PAVEMENT REMOVAL

- A. Measurement: Measurement shall be made on the basis of each square yard of asphalt removed in accordance with the plans, specifications, and bid documents.
- B. Payment: Payment will be made on the basis of the unit price stated in the bid. The work shall include, but is not limited to marking, cutting, and removal of pavement, or other materials that exist and will not be used as part of this project, excavation, and disposal at an approved site.

2.08 AGGREGATE BASE REMOVAL

- A. Measurement: Measurement shall be made on the basis of each square yard of aggregate removed in accordance with the plans, specifications, and bid documents.
- B. Payment: Payment will be made on the basis of the unit price stated in the bid. The work shall include, but is not limited to, excavation and removal of aggregate, or other materials that exist and will not be used as part of this project, excavation, and storage at an approved location for use on regraded road.

2.09 ROLLED CONCRETE CURB & GUTTER

- A. Measurement: Measurement shall be made on the basis of each linear foot of rolled concrete curb & gutter installed to the lines and grades shown on the plan. The size of the curb and gutter will be shown on the plans and indicated on the bid documents.
- B. Payment: Payment will be made on the basis of the unit price stated in the bid. The price shall include all materials, labor, and equipment necessary to complete the installation. Work shall include, but is not limited to, all excavation, forming, grade staking, compaction, curb and gutter installation, dewatering, form wrecking, cleanup, and surface restoration.

2.10 ASPHALT PAVING

- A. Measurement: Measurement will be made on the basis of each square yard of asphalt in place, in accordance with the plans and specifications and accepted by the Engineer.
- B. Payment: Payment will be made on the basis of the number of square yards of asphalt in place, in accordance with the unit price bid as stated in contract. Work shall include, but is not limited to, the furnishing, hauling, placing, and compaction of the asphalt in order to bring the pavement to the lines, grades, and cross sections as designated on the construction plans. The unit price shall also include all surface cleaning, prime, tack, and pavement markings. All striping shall be in accordance with the current MUTCD and local specifications- following the same markings as current exists.

2.11 GRANULAR ROADWAY BASE

- A. Measurement: Measurement shall be made on the basis of the number of square yards of graded aggregate base applied to the roadway at the specified thickness as shown on the construction plans. Any removed aggregate base in good condition shall be reused. Irregular areas such as turnouts, filler strips, and intersections will be measured to the closest square yard.
- B. Payment: Payment will be made on the basis of the number of square yards of granite crusher run (graded aggregate) base at the specified thickness applied to the roadway with new and reused material at the unit price stated in the bid. The price shall include all labor, equipment, and material to complete the task. Work shall include, but not be limited to, the furnishing hauling, placing, and compaction of the crusher run base in order to bring the base to the lines, grades, and cross sections shown on the construction plans or established by the Engineer.

2.12 FEATHER ASPHALT PAVING AT INTERSECTION

- A. Measurement: Measurement shall be made on the basis of the percentage complete of the lump sum bid in accordance with the construction plans and bid items.
- B. Payment: Payment shall be made on the basis of the percentage complete of the lump sum price stated in the bid as determined by the project engineer. The lump sum shall include furnishing all labor, materials, and equipment necessary to complete the task. The task shall include, but is not limited to, the furnishing, hauling, placing, and feathering of the asphalt in order to bring the pavement to the existing elevation at the intersection as designated on the construction plans.

2.13 CONCRETE APRON WITH SMOOTH ROCK TRANSITION (DRIVEWAYS)

- A. Measurement: Measurement shall be made on the basis of each square yard of concrete in place, in accordance with the construction plans and specifications and accepted by the Engineer.
- B. Payment: Payment will be made on the basis of the number of square yards of concrete in place, in accordance with the unit price bid, as stated in the contract. The unit price shall include all labor, materials, and equipment necessary to complete the task. Work shall include, but is not limited to, the furnishing, hauling, placing, compaction and leveling of the subbase and concrete in order to bring the concrete to the lines and grades as designated on the construction plans, and compaction of the additional rock installed as a smooth transition to the existing material of the driveway in order to bring the material of the existing lines and grades as designated on the construction plans.

2.14 GRAVEL REPLACEMENT (DRIVEWAYS)

- A. Measurement: Measurement will be made on the basis of each square yard of gravel in place, in accordance with the plans and specifications and accepted by the Engineer.
- B. Payment: Payment will be made on the basis of the number of square yards of gravel in place, in accordance with the unit price bid, as stated in contract. The unit price bid, as stated in contract. The unit price shall include all labor, materials, and equipment necessary to complete the task. Work shall include, but is not limited to, the furnishing, hauling, placing, and compaction of the gravel and subbase in order to bring the gravel to the lines and grades as designated on the construction plans.

2.15 SPEED BUMP REMOVAL AND REINSTALLATION

- A. Measurement: Measurement shall be made on the basis of each speed bump placed at the locations shown on the plans and in accordance with MUTCD and local specifications.
- B. Payment: Payment will be made at the unit price bid. The unit price bid shall include all material, labor, and equipment necessary to accomplish the task. Work shall include, but not be limited to, marking the location, removing the existing speed bump, drilling the holes in the new pavement, replacing the speed bump in accordance with construction plans, surface restoration, and cleanup. All speed bump locations shall be approved by the Engineer prior to installation. No payment will be made for speed bump installed without approval of Engineer.

2.16 PAINT AND BEAD PAVEMENT MARKING

- A. Measurement: Measurement shall be made on the basis of each linear foot of pavement markings in place in accordance with the plans and specifications.

- B. Payment: Payment shall be made at the linear footage stated in the bid. The unit price bid shall include all labor, materials, and equipment necessary to complete the task. The task shall include, but is not limited to, supplying and installing all paint and bead pavement markings to replace existing in accordance with construction plans, surface restoration, and cleanup.

2.17 CULVERT PIPE REMOVAL

- A. Measurement: Measurement shall be made on the basis of each linear foot of culvert pipe abandoned in place in accordance with the plans and specifications.
- B. Payment: Payment shall be made at the linear footage stated in the bid. The unit price bid shall include all labor, materials, and equipment necessary to complete the task. The task shall include, but is not limited to, excavation, pipe removal, backfill, compaction, surface restoration, and cleanup.

2.18 DRAINAGE STRUCTURE (Junction Box, Headwall, Precast rolled curb inlet, Grated inlet, Flared end section)

- A. Measurement: Measurement will be made on the basis of each drainage structure installed at the elevation and location designated on the construction plans.
- B. Payment: Payment will be made on the basis of each structure installed at the unit price bid. The unit price bid shall include furnishing all labor, materials, and necessary equipment to complete the item of work. Work shall include, but not be limited to, excavation, necessary shoring and sheeting, dewatering, forming, form wrecking, foundations as required, furnishing and installing the structure, placement of grates, rings and covers as applicable, grouting around pipe, 6" underdrain connection, backfill, compaction, grading, complete surface restoration, and cleanup.

2.19 FRENCH UNDERDRAIN PIPE

- A. Measurement: Measurement will be made on the basis of each linear foot of French underdrain pipe installed at the elevation, grade, and alignment as designated on the construction plans.
- B. Payment: Payment will be made on the basis of each linear foot of French underdrain pipe installed at the elevation, grade, and alignment as designated on the construction plans at the unit price bids as stated in the contract. Work shall but not be limited to, all excavation, trenching, necessary shoring and sheeting, all pipe bidding, furnishing and installing pipe, backfill, compaction, complete surface restoration, and cleanup.

2.20 DRAINAGE PIPE

- A. Measurement: Measurement will be made on the basis of each linear foot of drainage pipe installed at the elevation, grade, and alignment as designated on the construction plans.
- B. Payment: Payment will be made on the basis of each linear foot of drainage pipe installed at the elevation, grade, and alignment as designated on the construction plans at the unit price bids as stated in the contract. Work shall but not be limited to, all excavation, trenching, necessary shoring and sheeting, all pipe bidding, furnishing and installing pipe, backfill, compaction, complete surface restoration, and cleanup.

2.21 CONNECTIONS TO EXISTING SEWER SYSTEM

- A. Measurement: Measurement shall be made on the basis of each completed connection to the existing sewer manhole.
- B. Payment: Payment will be made on the basis of the unit price stated in the bid. The unit price bid shall include all materials, equipment, and labor necessary to complete the task. The task shall include, but is not limited to, locating the manhole, excavation, connection to the existing manhole including any fittings or clean outs required, manhole cored with boot (required), complete backfill and compactions and preparation of the surface for stabilization.

2.22 GRAVITY SEWERS

- A. Measurement: Measurement shall be made on the basis of each linear foot of gravity sewer line installed at the elevation and location designated on the construction plans.
- B. Payment: Payment for gravity sewers will be made at the unit price bid per linear foot. Unit price bid shall include furnishing all labor, materials, and equipment necessary to complete the installation of the sewer, including, but not limited to, trenching, bedding, PVC, or ductile iron sewer pipe, shoring and sheeting, dewatering, testing, backfill, trench compaction, and complete surface restoration.

2.23 MANHOLES AND RISER SECTIONS

- A. Measurement: Measurement shall be made on the basis of each manhole installed. Each complete manhole will be measured from the invert to the top of the cast iron frame and cover. A deduction of six feet (6') for the standard manhole and a deduction for the height of the frame and cover will be made. The remainder will be considered an additional riser section.
- B. Payment: Payment will be made for each manhole installed and for each additional vertical foot of riser installed at the unit prices stated in the bid. The unit price bid shall include all labor, materials, and equipment necessary, including, but not limited to,

excavation, shoring, sheeting, dewatering, gravel bedding, manholes, riser sections, castings, invert, stub outs, plugs, pipe connections, concrete manhole markers (if applicable), backfill, compaction, and complete surface restoration.

2.24 TIE INTO EXISTING WET WELL

- A. Measurement: Measurement shall be made on the basis of the complete connection in accordance with the plans, specifications, and bid documents.
- B. Payment: Payment will be made at the lump sum stated in the bid. Work shall include furnishing all labor, materials, and equipment necessary to complete the task. The price shall include, but is not limited to, locating the receiving wet well, excavation, connection to the receiving wet well- including any fittings and sealants required, blocking, excavation, trenching, backfill, compaction, shoring, sheeting, fittings, grouting, dewatering, bedding, and preparation of the surface for stabilization.

2.25 RECONNECT SANITARY SEWER SERVICE LATERALS

- A. Measurement: Measurement shall be made on the basis of the complete all connections in accordance with the plans, specifications, and bid documents.
- B. Payment: Payment will be made at the lump sum stated in the bid. Work shall include furnishing all labor, materials, and equipment necessary to complete the task. The price shall include, but is not limited to, identifying the existing sewer service laterals, excavation, trenching, installation of cleanouts as necessary, extension of sewer laterals, extension of lateral to installed main as specified on the construction plans, backfill, compaction, shoring, sheeting, fittings or couplings, sealants, dewatering, bedding, surface restoration, and cleanup.

2.26 SANITARY SEWER SERVICE LATERALS CONNECTIONS

- A. Measurement: Measurement shall be made on the basis of the complete all connections in accordance with the plans, specifications, and bid documents.
- B. Payment: Payment will be made at the lump sum stated in the bid. Work shall include furnishing all labor, materials, and equipment necessary to complete the task. The price shall include, but is not limited to, identifying the existing sewer service house connections, excavation, trenching, by passing of existing private pump stations as necessary, installation of cleanouts as necessary, installation of sewer laterals, extension of lateral to installed main as specified on the construction plans, backfill, compaction, shoring, sheeting, fittings or couplings, sealants, dewatering, bedding, surface restoration, and cleanup.

2.27 CUT, FILL, AND REMOVE EXISTING, SEWER LINE

- A. Measurement: Measurement shall be made on the basis of each linear foot of sewer line capped, filled, and removed at the location designated on the construction plans.
- B. Payment: Payment for sewer line removal will be made at the unit price per linear foot. Unit price bid shall include furnishing all labor, materials, and equipment necessary to complete this item of work. Work shall include, but is not limited to, excavation, cut the indicated sewer line, any required disinfection, plugging the sewer line where cut, removal of designated sewer line, disposal at approved site, backfill, compaction, and surface restoration.

2.28 DEMOLISH AND REMOVE EXISTING SEWER MANHOLE

- A. Measurement: Measurement shall be made on the basis of each manhole unit removed in accordance with the construction plans and specifications.
- B. Payment: Payment for manhole removal will be made at the unit price per item. Unit price bid shall include furnishing all labor, materials, and equipment necessary to complete this item of work. Work shall include, but is not limited to, excavation, removal of designated manhole, debris removal, disposal at approved site, backfill, compaction, and surface restoration.

2.29 FILL & ABANDON SEWER LINE

- A. Measurement: Measurement shall be made on the basis of each linear foot of sewer line abandoned at the location designated on the construction plans.
- B. Payment: Payment for abandoned gravity sewer line will be made at the unit price bid per linear foot. Unit price bid shall include furnishing all labor, materials, and equipment necessary to complete this item of work. Work shall include, but is not limited to, excavation, filling indicated sewer line with concrete, sealing manhole connections, backfill, compaction, and surface restoration.

2.30 ABANDON PRIVATE PUMP STATIONS

- A. Measurement: Measurement shall be made on the basis each unit abandoned in accordance with the construction plans and local ordinances.
- B. Payment: Payment for will be made at the unit price bid per private pump station abandoned. Unit price bid shall include furnishing all labor, materials, and equipment necessary to complete this item of work. Work shall include, but is not limited to, dewatering, sludge removal and disposal, power disconnections, removal and disposal of mechanical equipment (returned to owner if requested), concrete and steel structure removal and disposal (three feet below ground surface), gravel placement, backfill, compaction, cleanup, surface restoration, grassing, and EPD notification.

2.31 CUT, FILL, AND REMOVE WATER LINE

- A. Measurement: Measurement shall be made on the basis of each linear foot of water line capped, filled, and removed at the location designated on the construction plans.
- B. Payment: Payment for removed water line will be made at the unit price bid per linear foot. Unit price bid shall include furnishing all labor, materials, and equipment necessary to complete this item of work. Work shall include, but is not limited to, excavation, cutting and capping the indicated water line, any required disinfection, plugging the water line where cut, removal of designated water line, disposal at approved site, backfill, compaction, and surface restoration.

2.32 WATERMAINS

- A. Measurement: Measurement will be made along the centerline of the pipe trench and through fittings and specials. No deduction in length will be made for fittings or specials.
- B. Payment: Payment will be made on the basis of unit price bid per linear foot for specific line size. Unit price bid shall include all materials, labor, and equipment necessary to complete the water main installation. Work shall include, but not be limited to, trenching and excavation, necessary shoring and sheeting, furnishing and installing pipe, tracer wire, marker tape, backfilling and compaction, concrete blocking, bedding, pressure testing, disinfection, complete surface restoration, and cleanup.

2.33 GATE VALVES

- A. Measurement: Measurement shall be made on the basis of each unit installed in accordance with the construction plans and specifications.
- B. Payment: Payment will be made at the unit price bid for a specific valve size. Unit price bid shall include furnishing all materials, labor, and equipment necessary to complete the gate valve installation. Work shall include, but not be limited to, excavation, necessary shoring, sheeting, backfilling, concrete valve box collar, furnishing and installing gate valves, valve boxes, pressure testing, disinfection, and complete surface restoration and cleanup.

2.34 FITTINGS

- A. Measurement: Measurement will be made on the basis of each ton of fittings installed based on the weight of the fitting and the accessory kit.
- B. Payment: Payment will be made at the unit price bid per ton of fittings installed in accordance with the plans or directed by the engineer. The price shall include all labor, equipment, and materials to complete the task. Work shall include, but is not limited

to, furnishing the fitting, all bolts, accessories, trench, excavation, thrust blocking, pressure testing, surface restoration, and stabilization

2.35 MOBILIZATION

- A. Payment: Payment will be made for the price as stated in the Contract once the Contractor has established his construction yard and met the requirements established in the Contract Documents. Mobilization will be recognized as complete once the Contractor has provided a construction schedule and moved his equipment and a substantial amount of material to the job site. Construction must be underway and progressing. Payment for mobilization will be limited to a maximum amount not to exceed 5.0% of the bid price.

END OF SECTION

Unofficial

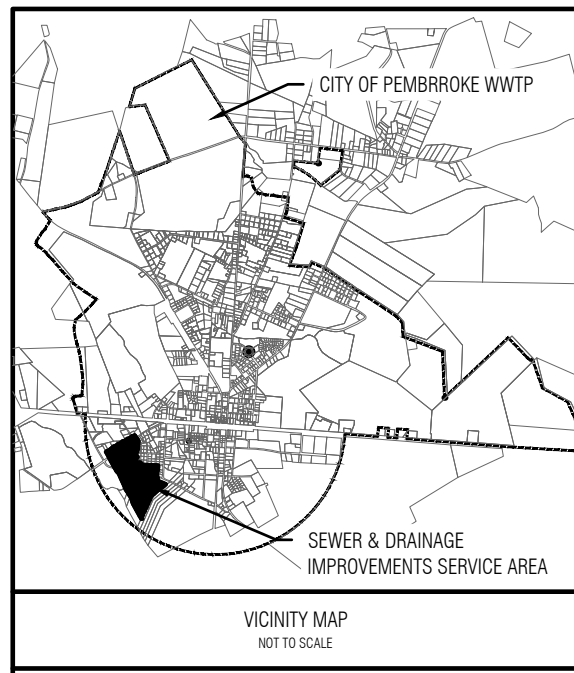

Unofficial

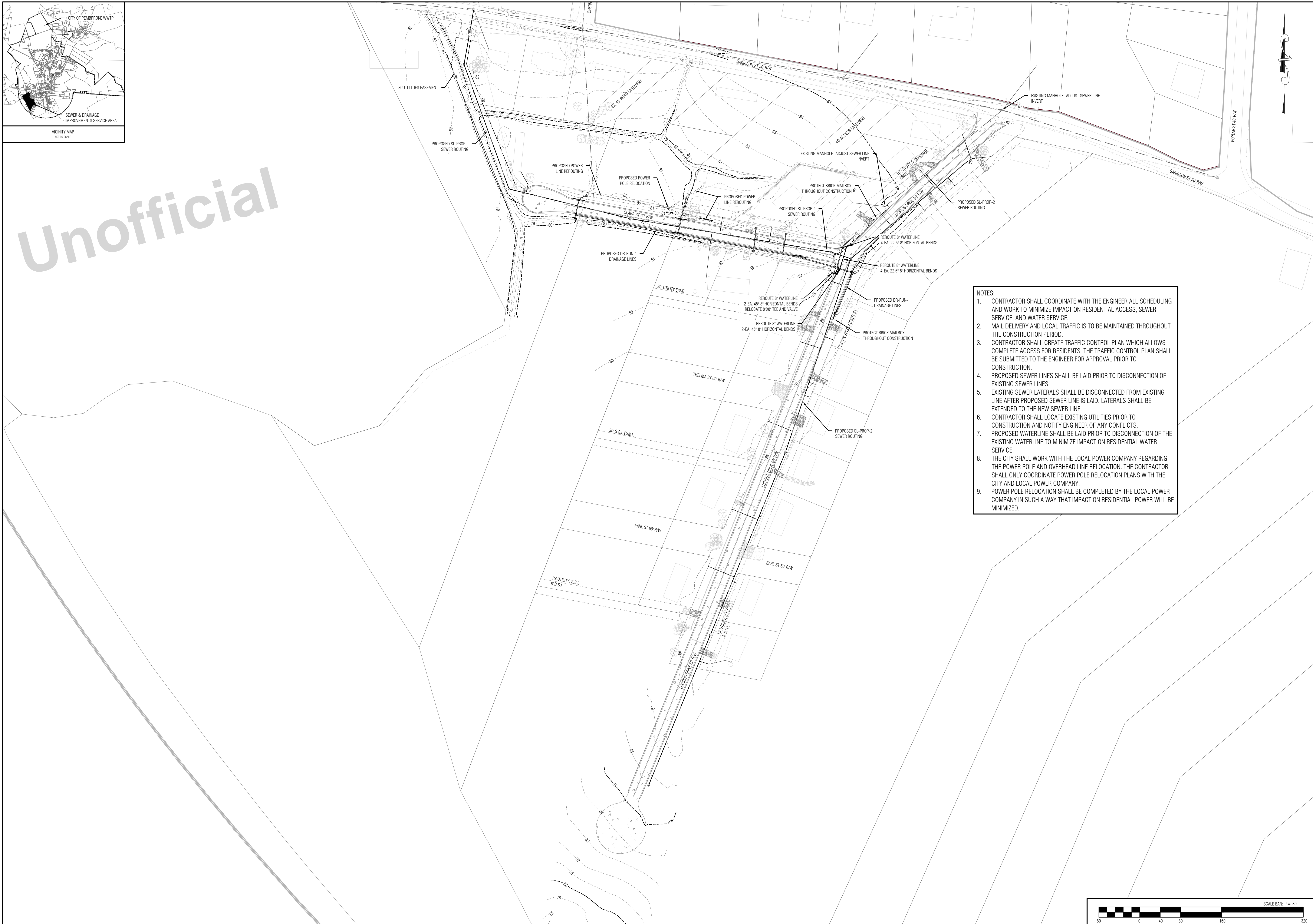

- NOTES:**
1. CONTRACTOR SHALL COORDINATE WITH THE ENGINEER ALL SCHEDULING AND WORK TO MINIMIZE IMPACT ON RESIDENTIAL ACCESS, SEWER SERVICE, AND WATER SERVICE.
 2. MAIL DELIVERY AND LOCAL TRAFFIC IS TO BE MAINTAINED THROUGHOUT THE CONSTRUCTION PERIOD.
 3. CONTRACTOR SHALL CREATE TRAFFIC CONTROL PLAN WHICH ALLOWS COMPLETE ACCESS FOR RESIDENTS. THE TRAFFIC CONTROL PLAN SHALL BE SUBMITTED TO THE ENGINEER FOR APPROVAL PRIOR TO CONSTRUCTION.
 4. PROPOSED SEWER LINES SHALL BE LAID PRIOR TO DISCONNECTION OF EXISTING SEWER LINES.
 5. EXISTING SEWER LATERALS SHALL BE DISCONNECTED FROM EXISTING LINE AFTER PROPOSED SEWER LINE IS LAID. LATERALS SHALL BE EXTENDED TO THE NEW SEWER LINE.
 6. CONTRACTOR SHALL LOCATE EXISTING UTILITIES PRIOR TO CONSTRUCTION AND NOTIFY ENGINEER OF ANY CONFLICTS.
 7. PROPOSED WATERLINE SHALL BE LAID PRIOR TO DISCONNECTION OF THE EXISTING WATERLINE TO MINIMIZE IMPACT ON RESIDENTIAL WATER SERVICE.
 8. THE CITY SHALL WORK WITH THE LOCAL POWER COMPANY REGARDING THE POWER POLE AND OVERHEAD LINE RELOCATION. THE CONTRACTOR SHALL ONLY COORDINATE POWER POLE RELOCATION PLANS WITH THE CITY AND LOCAL POWER COMPANY.
 9. POWER POLE RELOCATION SHALL BE COMPLETED BY THE LOCAL POWER COMPANY IN SUCH A WAY THAT IMPACT ON RESIDENTIAL POWER WILL BE MINIMIZED.

REVISIONS:

1.	GSWCC REVISIONS
2.	BID ADDENDUM #2

THIS DRAWING IS AN INSTRUMENT OF SERVICE AND REMAINS THE PROPERTY OF P.C. SIMONTON & ASSOCIATES, INC. AND M.E. SACK ENGINEERING, INC. IT MAY NOT BE COPIED, ALTERED, OR REPRODUCED IN ANY MANNER WITHOUT PERMISSION ON A SIGNED AND SEALED DOCUMENT. THE INFORMATION CONTAINED HEREIN IS INTENDED FOR THE NAMED CLIENT ONLY. IN THE EVENT OF AN ELECTRONIC VERSION P.C. SIMONTON & ASSOC., INC. AND M.E. SACK ENGINEERING ASSUMES NO RESPONSIBILITY FOR DATA GENERATED, ALTERED OR STAKED FROM THIS DRAWING. IN THE EVENT OF A DISPUTE, HARD COPIES WILL TAKE PRECEDENCE OVER ANY ELECTRONIC MEDIA.

DESIGN PROFESSIONAL:
 MARCUS E. SACK
 GSWCC LEVEL II # 70248
 EXPIRES: 06/14/2026
 MARCUS@MESACK.COM
 515 NORTH MAIN STREET
 P.O. BOX 649
 HINESVILLE, GA 31313
 TEL: (912) 368-5212

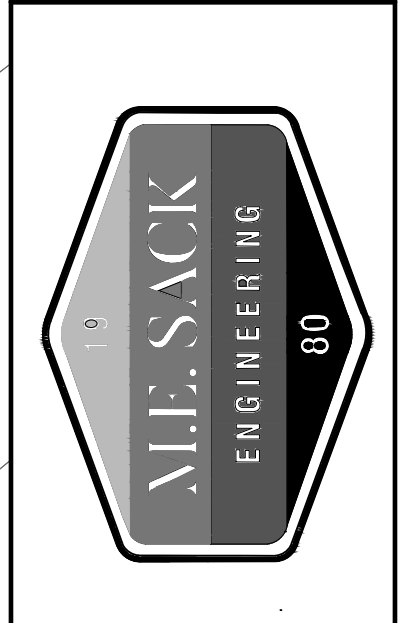

MUNICIPALITY:
CITY OF PEMBROKE

COUNTY:
BRYAN COUNTY

OWNER:
City of Pembroke
160 N Main St
Pembroke, GA 31321
(912) 653-4413
water@pembrokega.net

24 HOUR CONTACT:
CITY OF PEMBROKE
CONTACT: KEITH COOK
160 N MAIN ST
PEMBROKE, GA 31321
(912) 653-4413
STREETS@PEMBROKEGA.NET

SEWER & DRAINAGE IMPROVEMENTS

OVERALL SITE PLAN

C101

FILE NO: 2022-15
 PLOT DATE: January 28, 2025

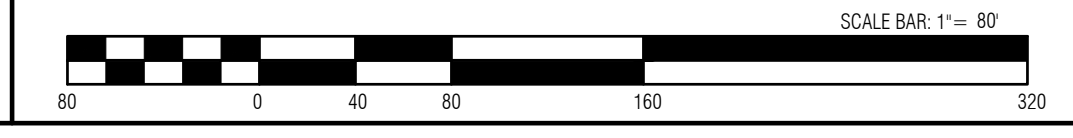

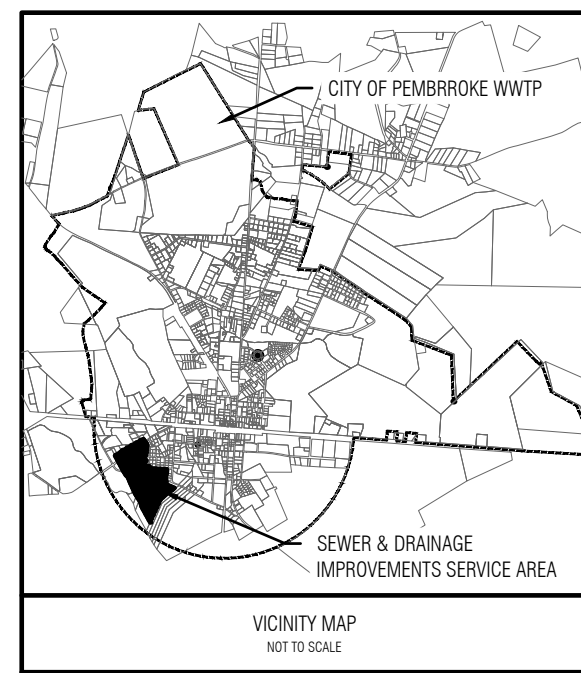

Unofficial

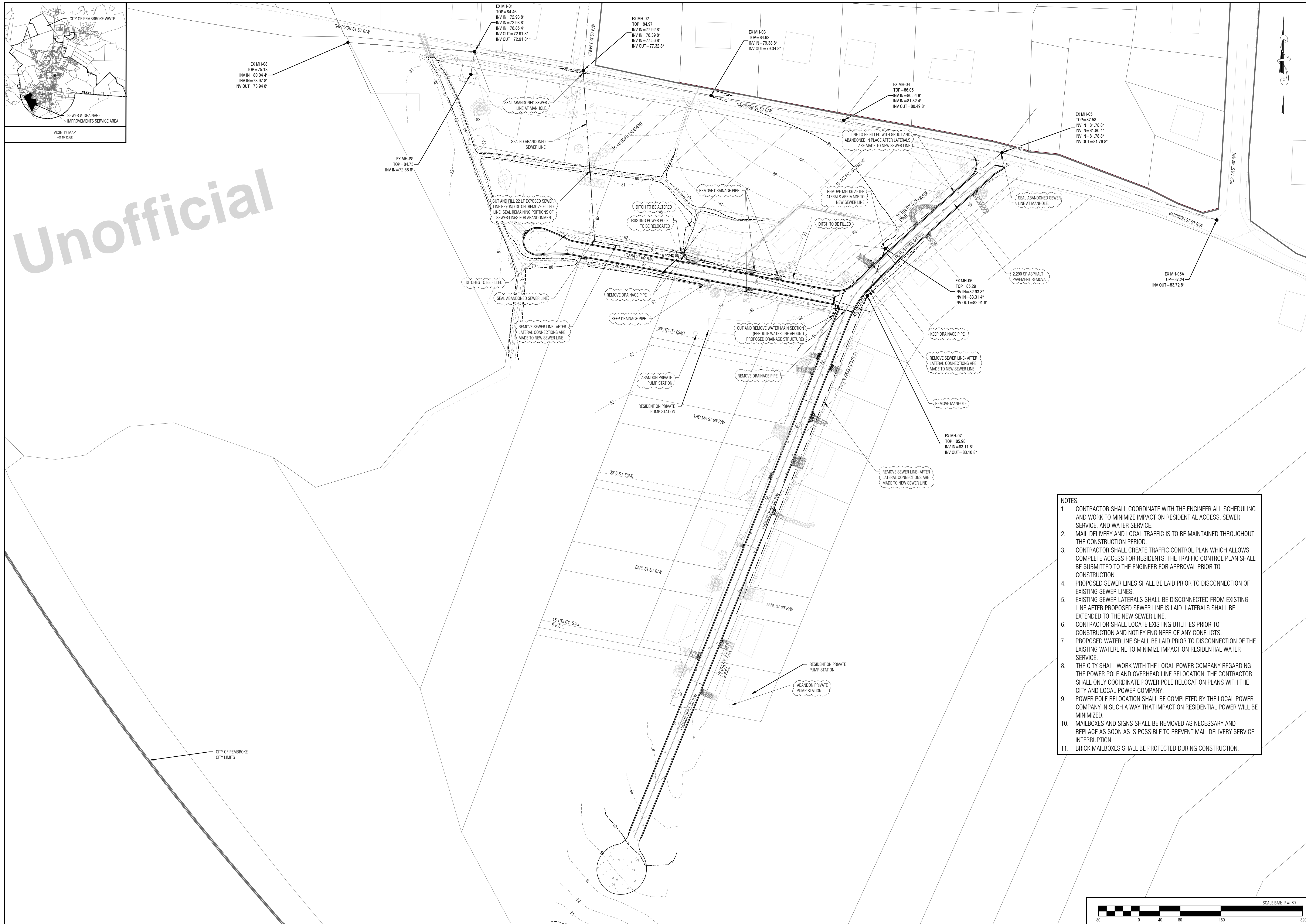

- NOTES:
- CONTRACTOR SHALL COORDINATE WITH THE ENGINEER ALL SCHEDULING AND WORK TO MINIMIZE IMPACT ON RESIDENTIAL ACCESS, SEWER SERVICE, AND WATER SERVICE.
 - MAIL DELIVERY AND LOCAL TRAFFIC IS TO BE MAINTAINED THROUGHOUT THE CONSTRUCTION PERIOD.
 - CONTRACTOR SHALL CREATE TRAFFIC CONTROL PLAN WHICH ALLOWS COMPLETE ACCESS FOR RESIDENTS. THE TRAFFIC CONTROL PLAN SHALL BE SUBMITTED TO THE ENGINEER FOR APPROVAL PRIOR TO CONSTRUCTION.
 - PROPOSED SEWER LINES SHALL BE LAID PRIOR TO DISCONNECTION OF EXISTING SEWER LINES.
 - EXISTING SEWER LATERALS SHALL BE DISCONNECTED FROM EXISTING LINE AFTER PROPOSED SEWER LINE IS LAID. LATERALS SHALL BE EXTENDED TO THE NEW SEWER LINE.
 - CONTRACTOR SHALL LOCATE EXISTING UTILITIES PRIOR TO CONSTRUCTION AND NOTIFY ENGINEER OF ANY CONFLICTS.
 - PROPOSED WATERLINE SHALL BE LAID PRIOR TO DISCONNECTION OF THE EXISTING WATERLINE TO MINIMIZE IMPACT ON RESIDENTIAL WATER SERVICE.
 - THE CITY SHALL WORK WITH THE LOCAL POWER COMPANY REGARDING THE POWER POLE AND OVERHEAD LINE RELOCATION. THE CONTRACTOR SHALL ONLY COORDINATE POWER POLE RELOCATION PLANS WITH THE CITY AND LOCAL POWER COMPANY.
 - POWER POLE RELOCATION SHALL BE COMPLETED BY THE LOCAL POWER COMPANY IN SUCH A WAY THAT IMPACT ON RESIDENTIAL POWER WILL BE MINIMIZED.
 - MAILBOXES AND SIGNS SHALL BE REMOVED AS NECESSARY AND REPLACE AS SOON AS IS POSSIBLE TO PREVENT MAIL DELIVERY SERVICE INTERRUPTION.
 - BRICK MAILBOXES SHALL BE PROTECTED DURING CONSTRUCTION.

REVISIONS	
1.	GSWCC REVISIONS
2.	BID ADDENDUM #2

DESIGN PROFESSIONAL:
 MARCUS E. SACK
 GSWCC LEVEL II # 70248
 EXPIRES: 06/14/2026
 MARCUS@MESACK.COM

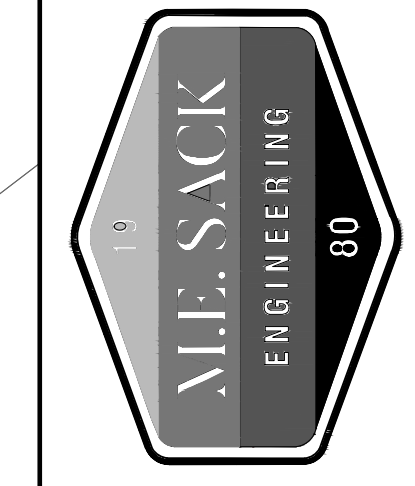
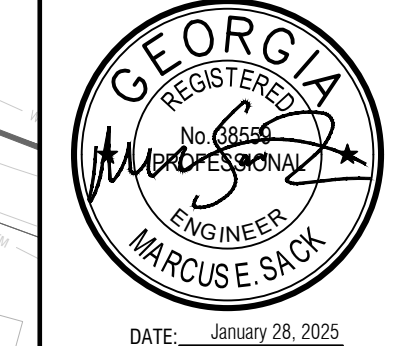

MUNICIPALITY:
CITY OF PEMBROKE

COUNTY:
BRYAN COUNTY

OWNER:
City of Pembroke
160 N Main St
Pembroke, GA 31321
(912) 653-4413
water@pembrokega.net

24 HOUR CONTACT:
CITY OF PEMBROKE
CONTACT: KEITH COOK
160 N MAIN ST
PEMBROKE, GA 31321
(912) 653-4413
STREETS@PEMBROKEGA.NET

SEWER & DRAINAGE IMPROVEMENTS

DEMOLITION PLAN

C102

FILE NO: 2022-15
 PLOT DATE: January 28, 2025

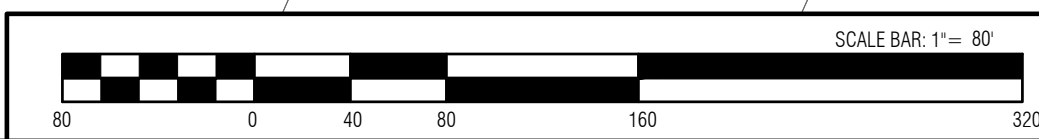

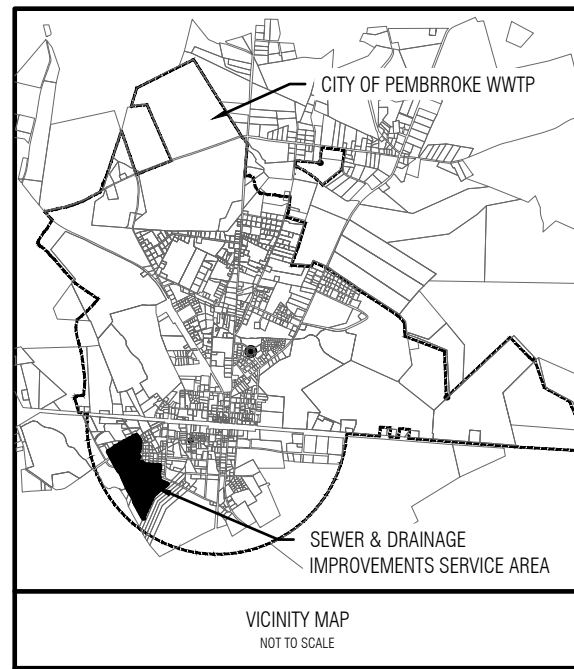

Unofficial

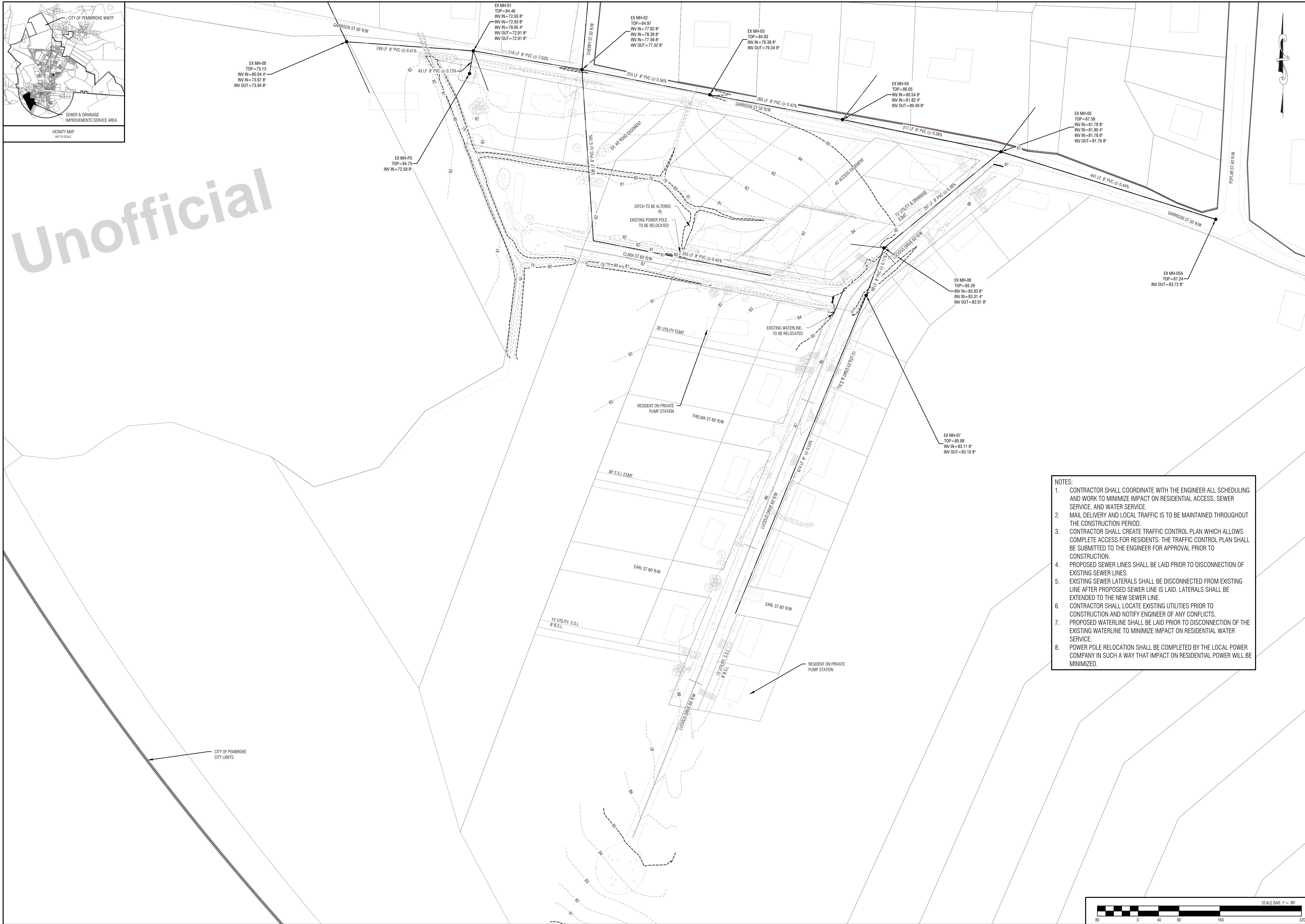

REVISIONS	
1.	GSWCC REVISIONS
2.	BID ADDENDUM #2

THIS DRAWING IS AN INSTRUMENT OF SERVICE AND REMAINS THE PROPERTY OF P. C. SAMPSON & ASSOCIATES, INC. AND M.E. SACK ENGINEERING, INC. IT MAY NOT BE COPIED, ALTERED, OR REPRODUCED IN ANY MANNER WITHOUT PERMISSION ON A SIGNED AND SEALED DOCUMENT. THE INFORMATION CONTAINED HEREIN IS INTENDED FOR THE MAILED CLIENT ONLY. IN THE EVENT OF AN ELECTRONIC VERSION, P.C. SAMPSON & ASSOC., INC. AND M.E. SACK ENGINEERING ASSUMES NO RESPONSIBILITY FOR DATA GENERATED, ALTERED OR STAVED FROM THIS DRAWING. IN THE EVENT OF A DISCREPANCY, HARD COPIES WILL TAKE PRECEDENCE OVER ANY ELECTRONIC MEDIA.

DESIGN PROFESSIONAL:
 MARCUS E. SACK
 GSWCC LEVEL II # 70248
 EXPIRES: 06/14/2026
 MARCUS@MESACK.COM

515 NORTH MAIN STREET
 P.O. BOX 649
 HINESVILLE, GA 31313
 TEL: (912) 368-5212

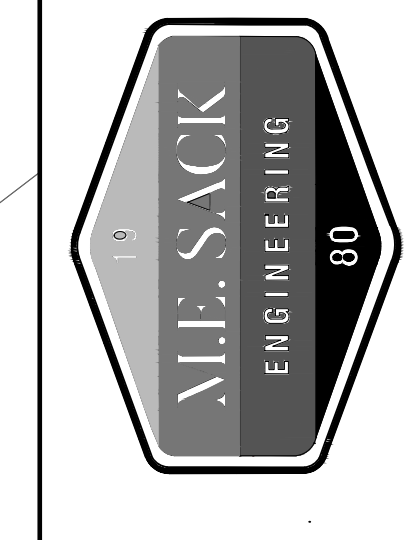

MUNICIPALITY:
 CITY OF PEMBROKE

COUNTY:
 BRYAN COUNTY

OWNER:
 City of Pembroke
 160 N Main St
 Pembroke, GA 31321
 (912) 653-4413
 water@pembrokega.net

24 HOUR CONTACT:
 CITY OF PEMBROKE
 CONTACT: KEITH COOK
 160 N MAIN ST
 PEMBROKE, GA 31321
 (912) 653-4413
 STREETS@PEMBROKEGA.NET

SEWER & DRAINAGE IMPROVEMENTS

EXISTING SEWER CONDITIONS

C200

FILE NO: 2022-15
 PLOT DATE: January 28, 2025

- NOTES:
1. CONTRACTOR SHALL COORDINATE WITH THE ENGINEER ALL SCHEDULING AND WORK TO MINIMIZE IMPACT ON RESIDENTIAL ACCESS, SEWER SERVICE, AND WATER SERVICE.
 2. MAIL DELIVERY AND LOCAL TRAFFIC IS TO BE MAINTAINED THROUGHOUT THE CONSTRUCTION PERIOD.
 3. CONTRACTOR SHALL CREATE TRAFFIC CONTROL PLAN WHICH ALLOWS COMPLETE ACCESS FOR RESIDENTS. THE TRAFFIC CONTROL PLAN SHALL BE SUBMITTED TO THE ENGINEER FOR APPROVAL PRIOR TO CONSTRUCTION.
 4. PROPOSED SEWER LINES SHALL BE LAID PRIOR TO DISCONNECTION OF EXISTING SEWER LINES.
 5. EXISTING SEWER LATERALS SHALL BE DISCONNECTED FROM EXISTING LINE AFTER PROPOSED SEWER LINE IS LAID. LATERALS SHALL BE EXTENDED TO THE NEW SEWER LINE.
 6. CONTRACTOR SHALL LOCATE EXISTING UTILITIES PRIOR TO CONSTRUCTION AND NOTIFY ENGINEER OF ANY CONFLICTS.
 7. PROPOSED WATERLINE SHALL BE LAID PRIOR TO DISCONNECTION OF THE EXISTING WATERLINE TO MINIMIZE IMPACT ON RESIDENTIAL WATER SERVICE.
 8. POWER POLE RELOCATION SHALL BE COMPLETED BY THE LOCAL POWER COMPANY IN SUCH A WAY THAT IMPACT ON RESIDENTIAL POWER WILL BE MINIMIZED.

